

Unifit outlet duplex

installation instruction

1

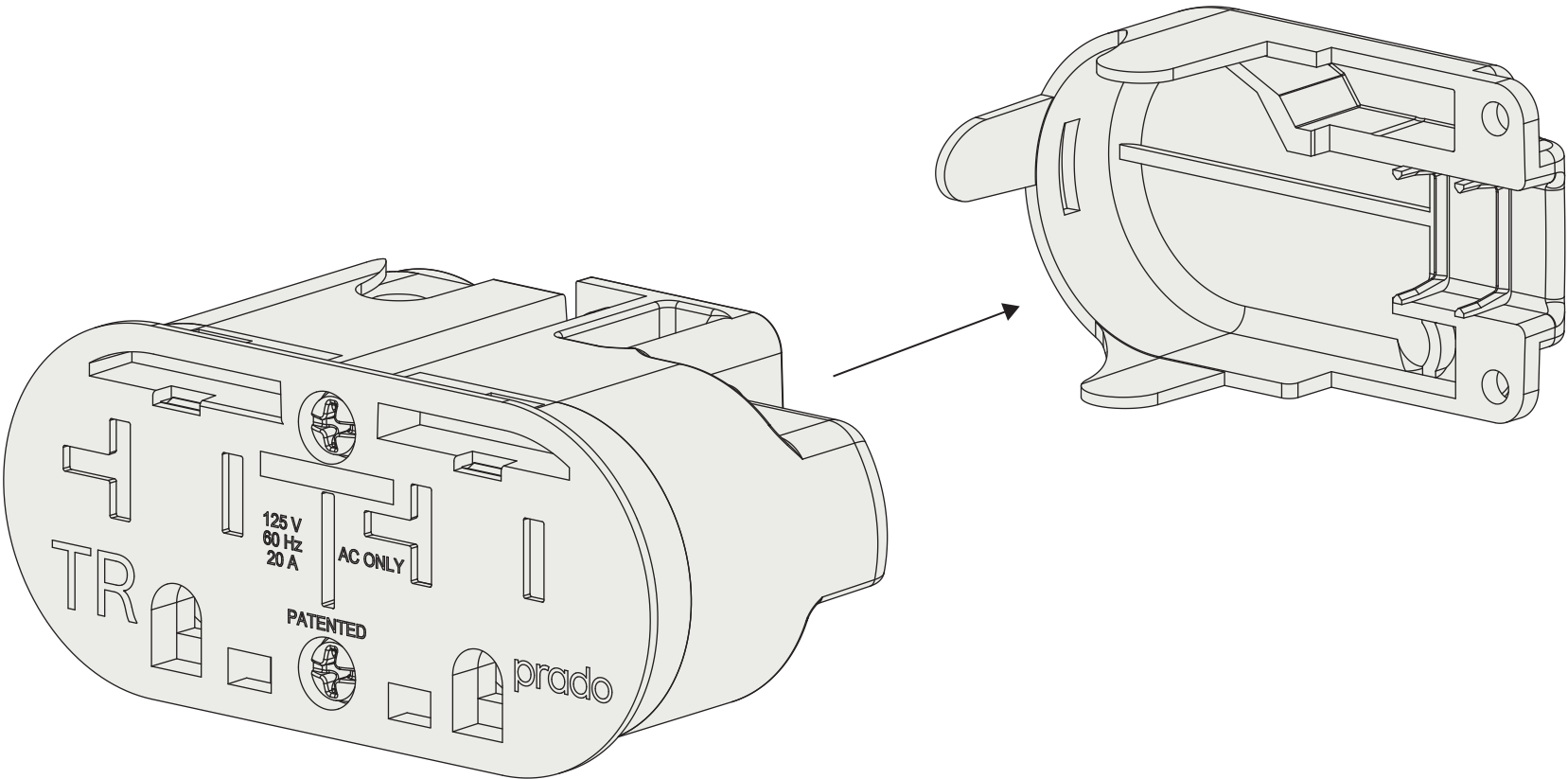

Remove the strain relief.

2

for hardwired - with back box go to **step 3** ([click here](#))

for self contained go to **step 8** ([click here](#))

for corded go to **step 15** ([click here](#))

for removal go to **step 25** ([click here](#))

3 hardwired - with back box

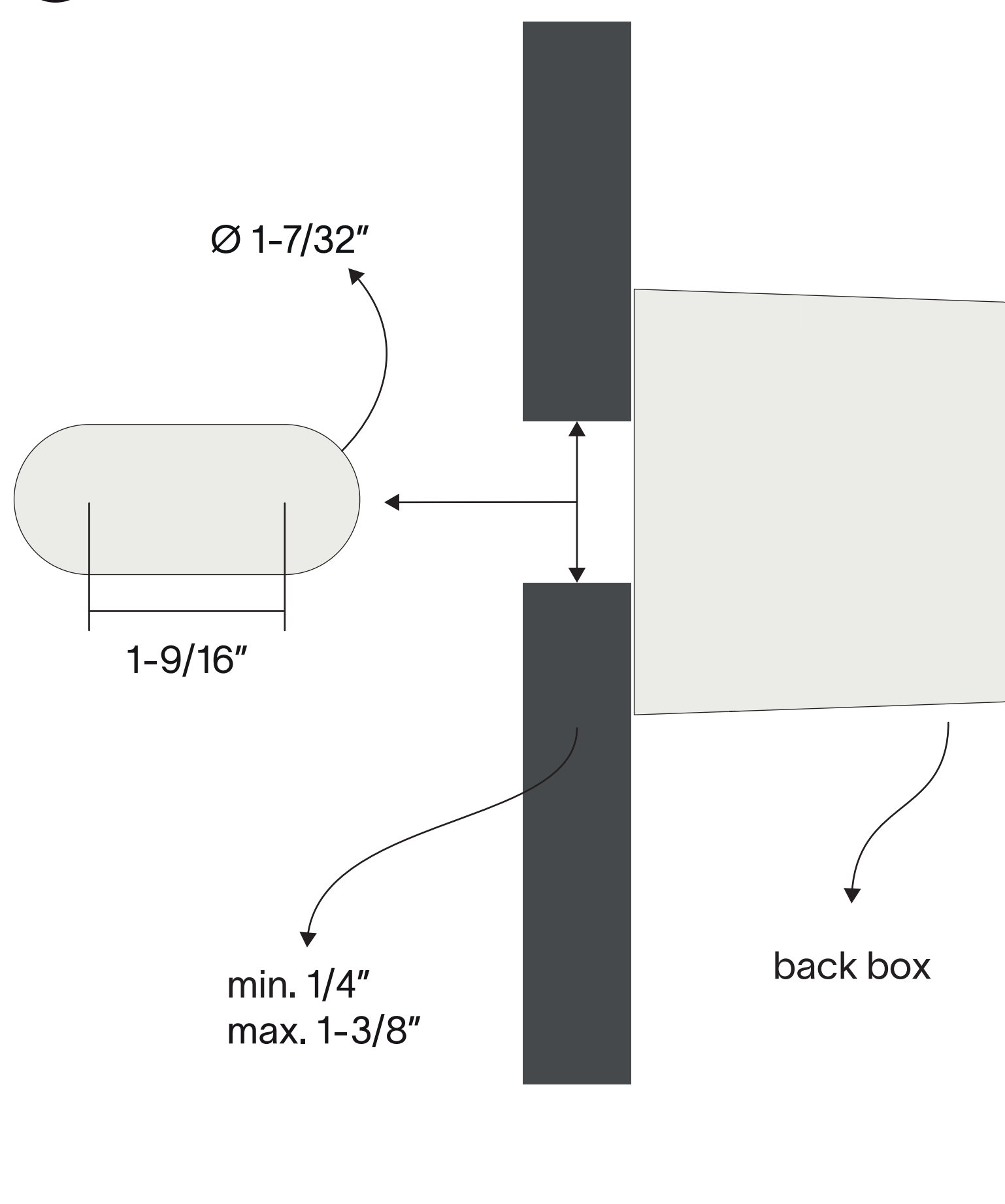

Mill the installation hole.

4

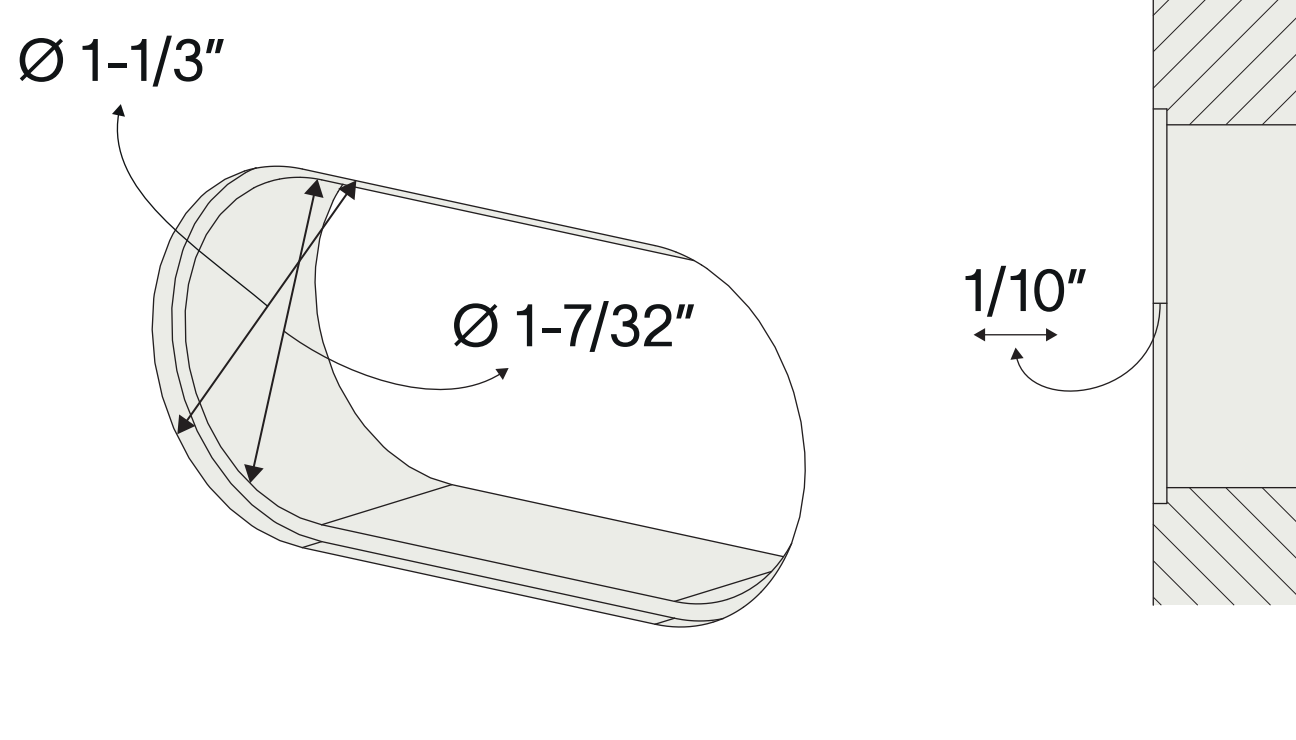

Optional: flush mount countersink.

5

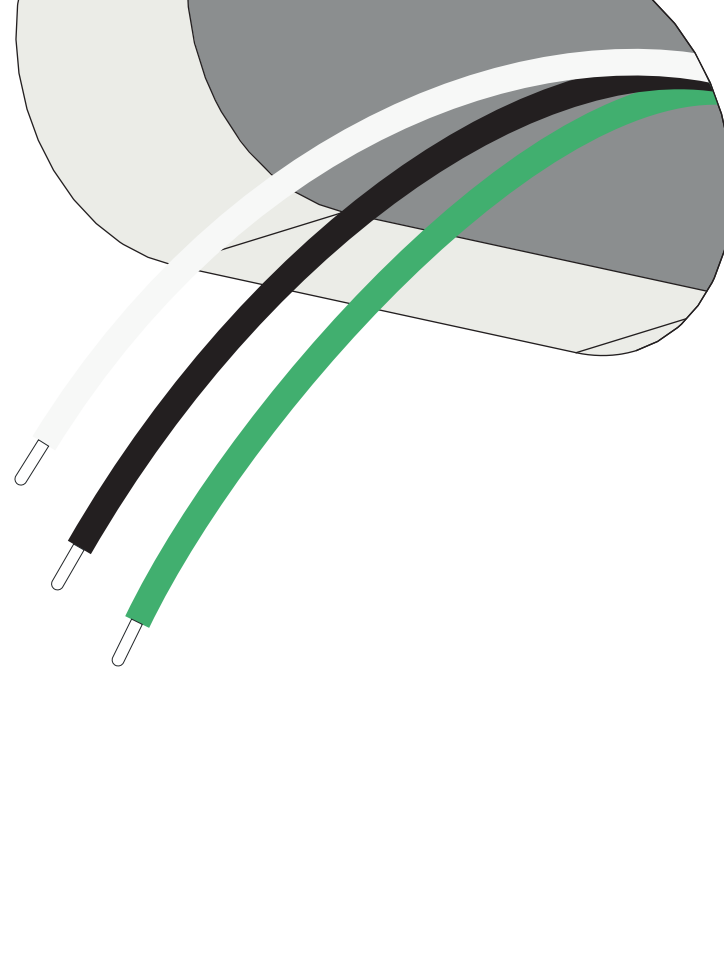

Turn the power off.

The branch circuit wiring that supplies each device consists of a separate cable assembly originating outside the box, or individual sets of conductors in a single raceway, all of which originate outside the box. Other than the connections to a single device, these conductors are not spliced in the box or continued to another device, and no other wiring or raceways enter the box.

For Metal Box Installations, during the electrical installation:

1. Attach the equipment bonding conductor to the metal device box.
2. Secure the branch circuit's equipment grounding wire to the green grounding screw terminal of the electrical outlet.
3. Before installing the substrate, confirm that the green grounding screw remains visible when the receptacle is removed.

6

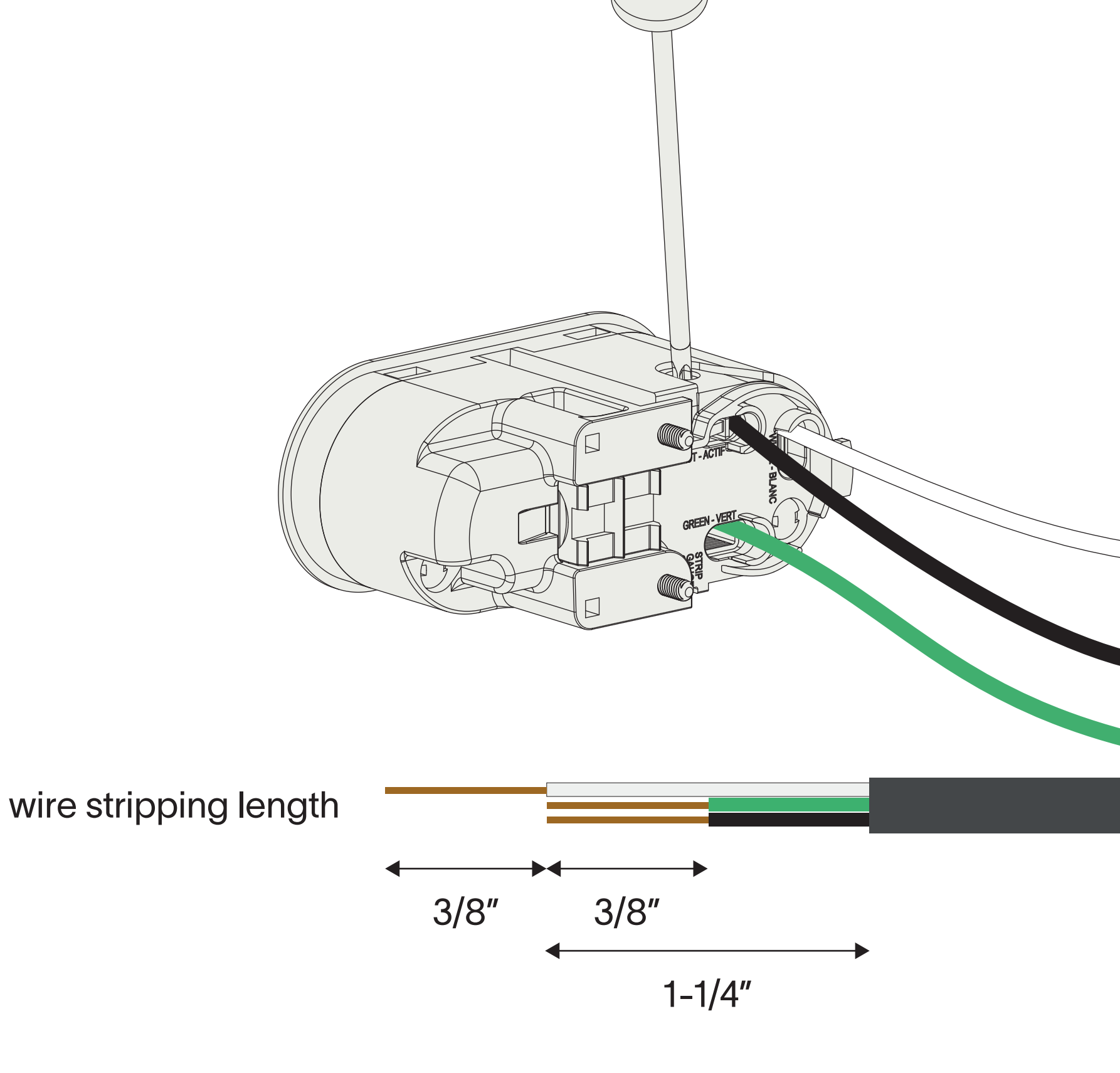

Make all necessary connections, make sure correct wire thickness is used:

- 15A – 14 AWG
- 20A - 12 AWG

7

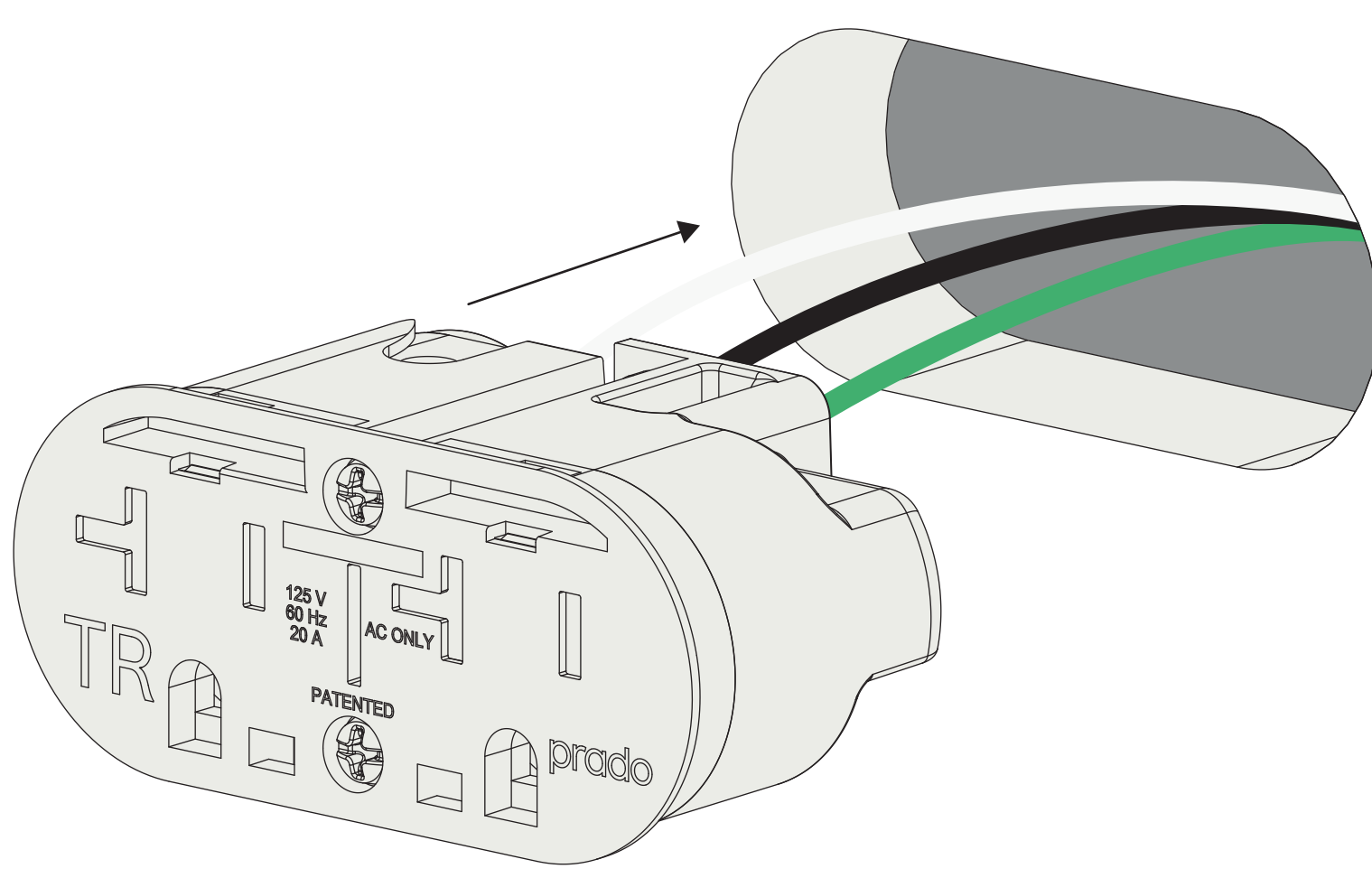

Insert the outlet in the hole and go to [step 21](#) (click here).

8 self contained

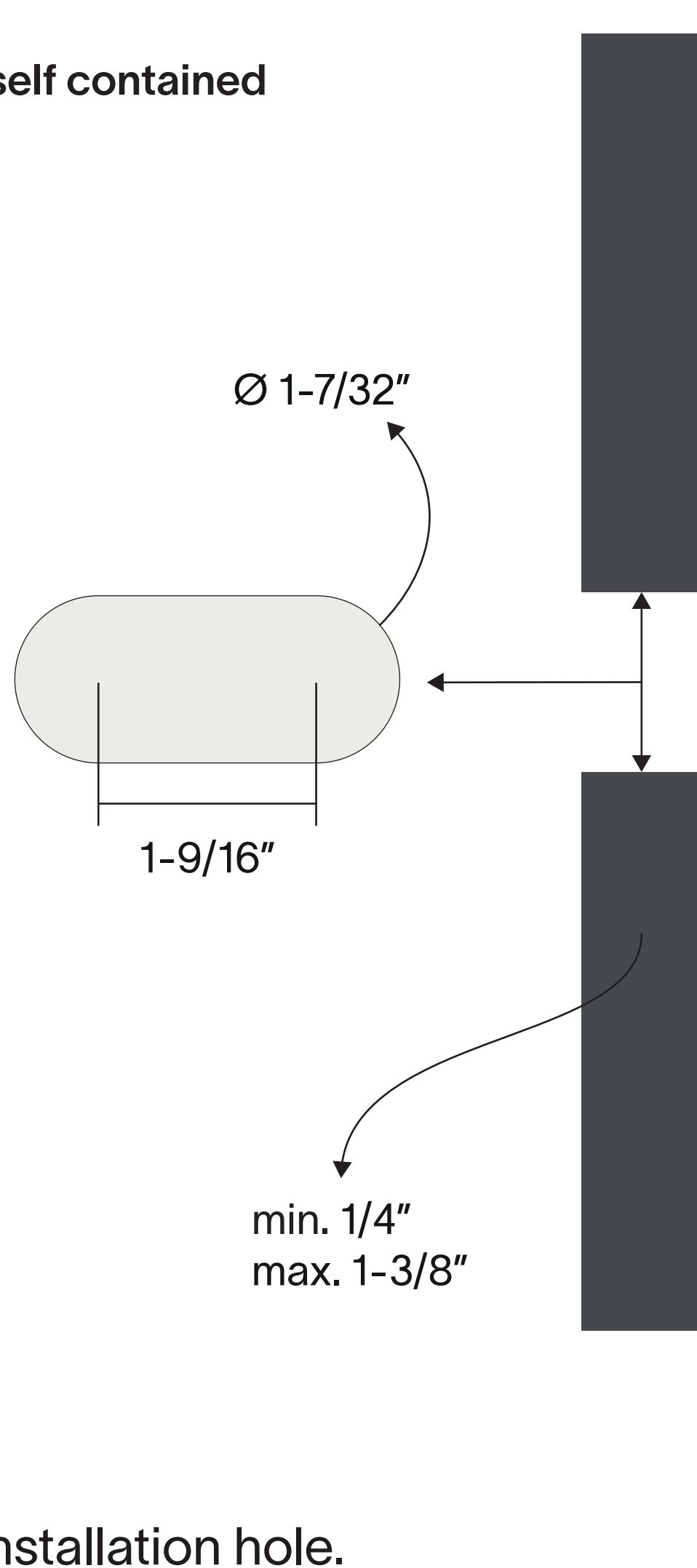

Mill the installation hole.

9

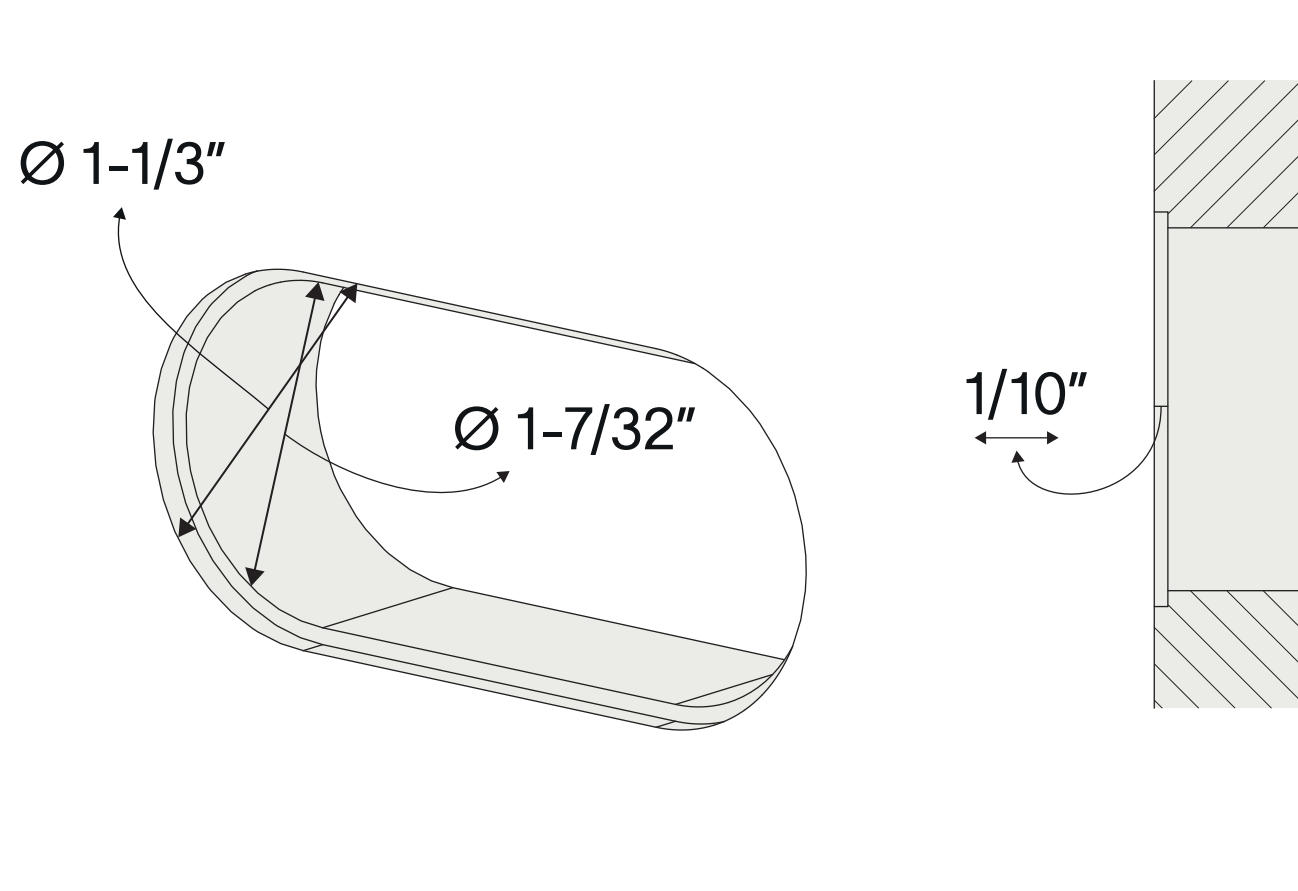

Optional: flush mount countersink.

10

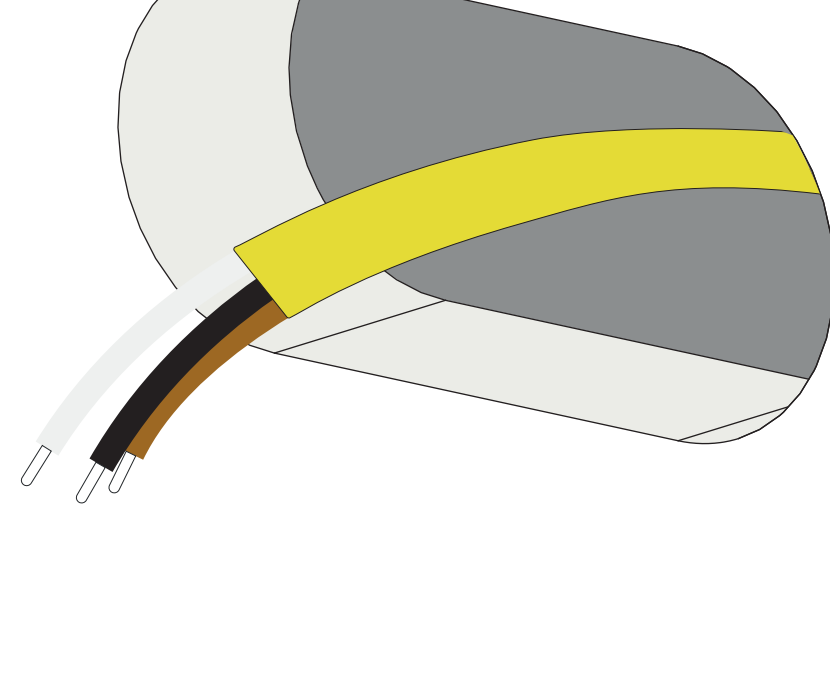

Turn the power off.

11

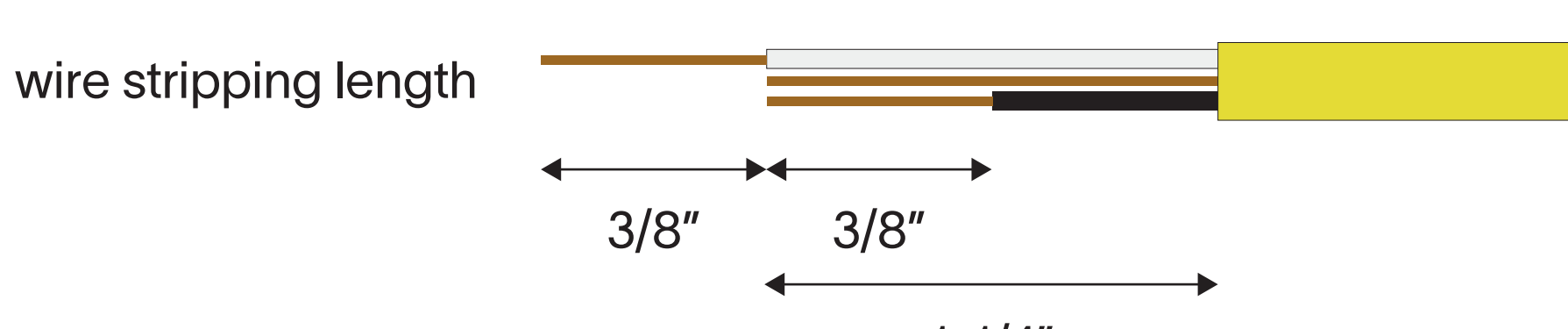
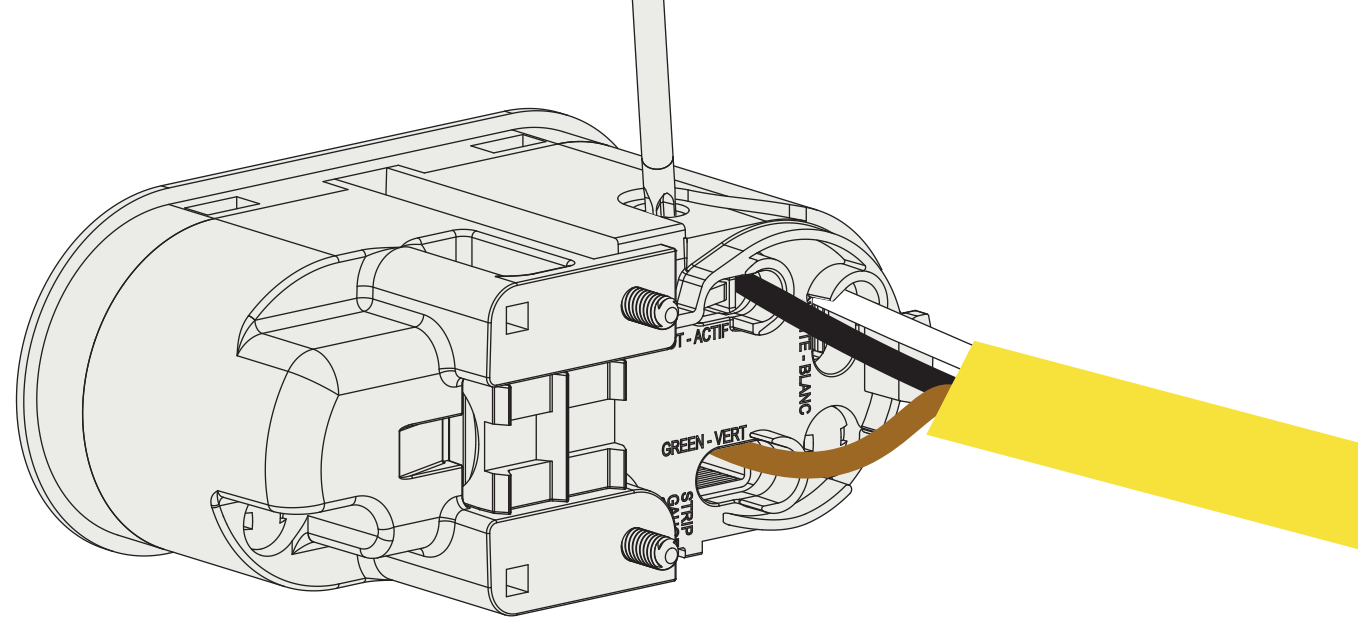

Make all necessary connections, make sure correct wire thickness is used:

- 15A – 14 AWG
- 20A - 12 AWG

12

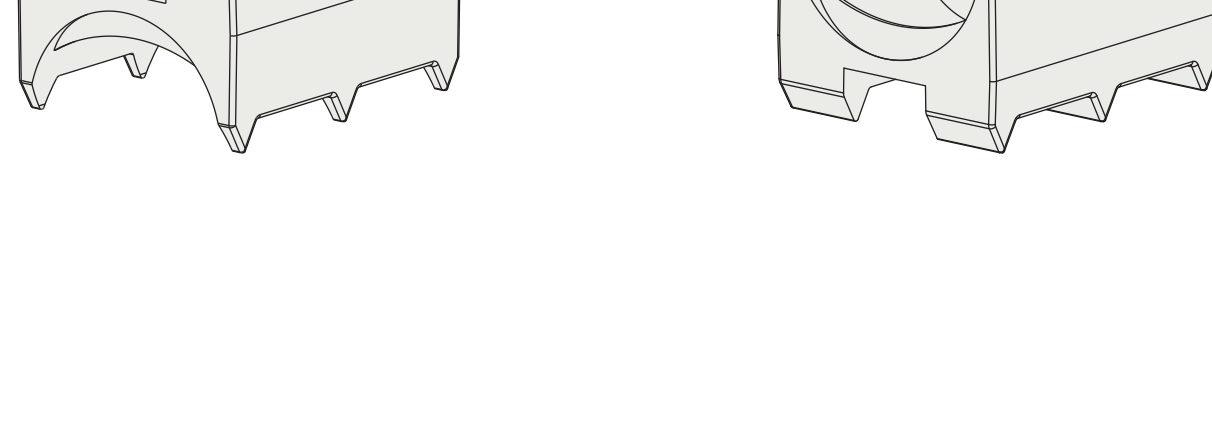
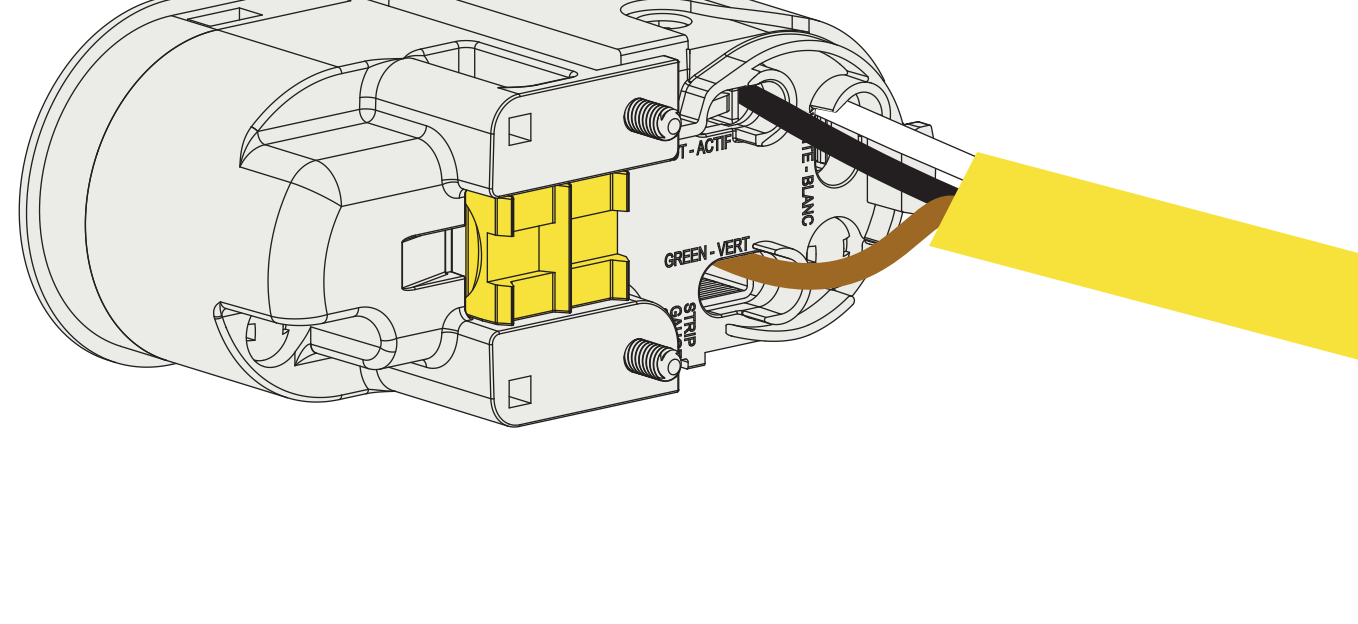

Use the appropriate side of the strain relief depending on the used cable. For daisy chaining remove this part.

13

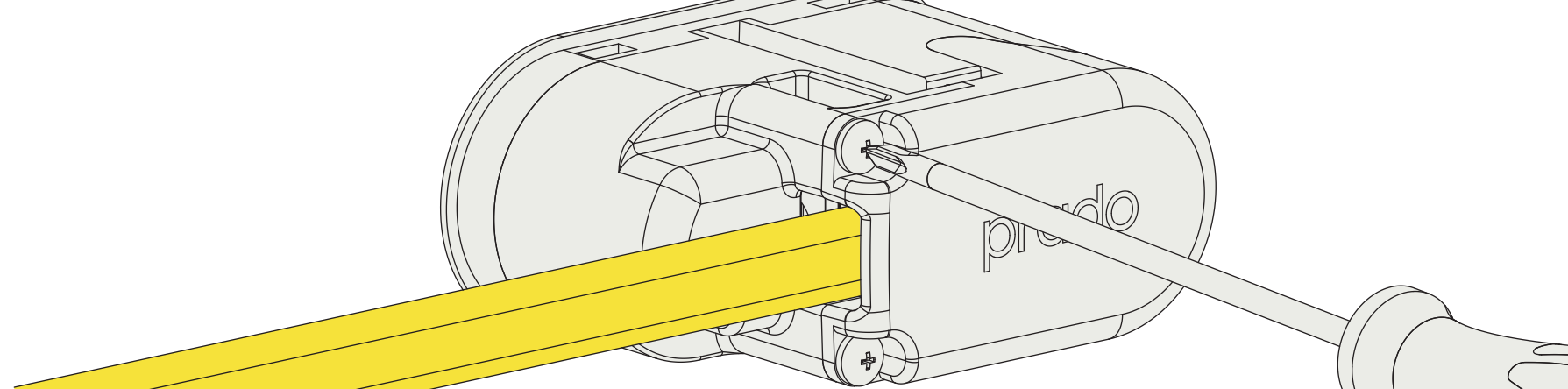

Fasten the strain relief.

14

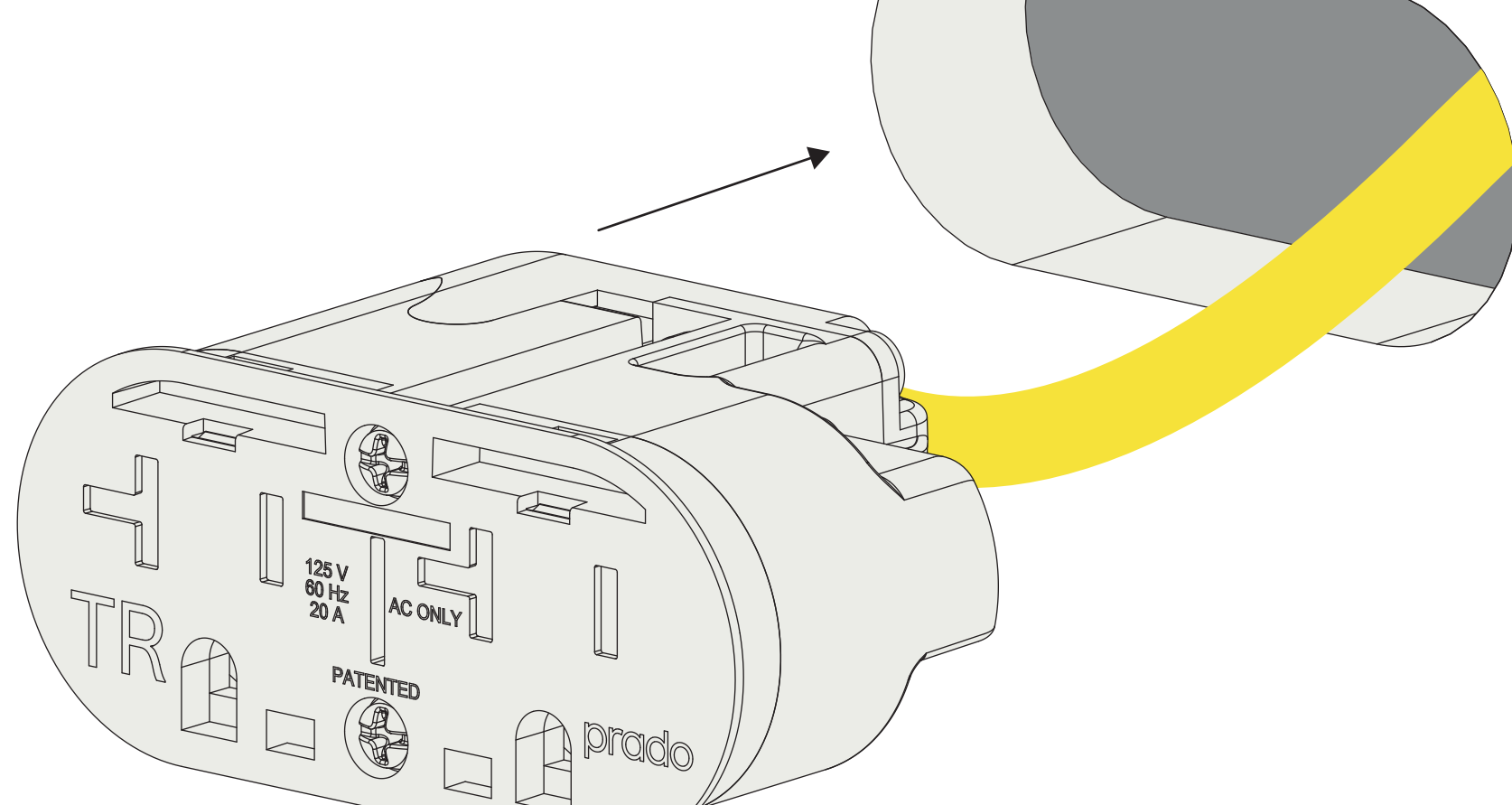

Insert the outlet in the hole and go to step 21 ([click here](#)).

15

corded

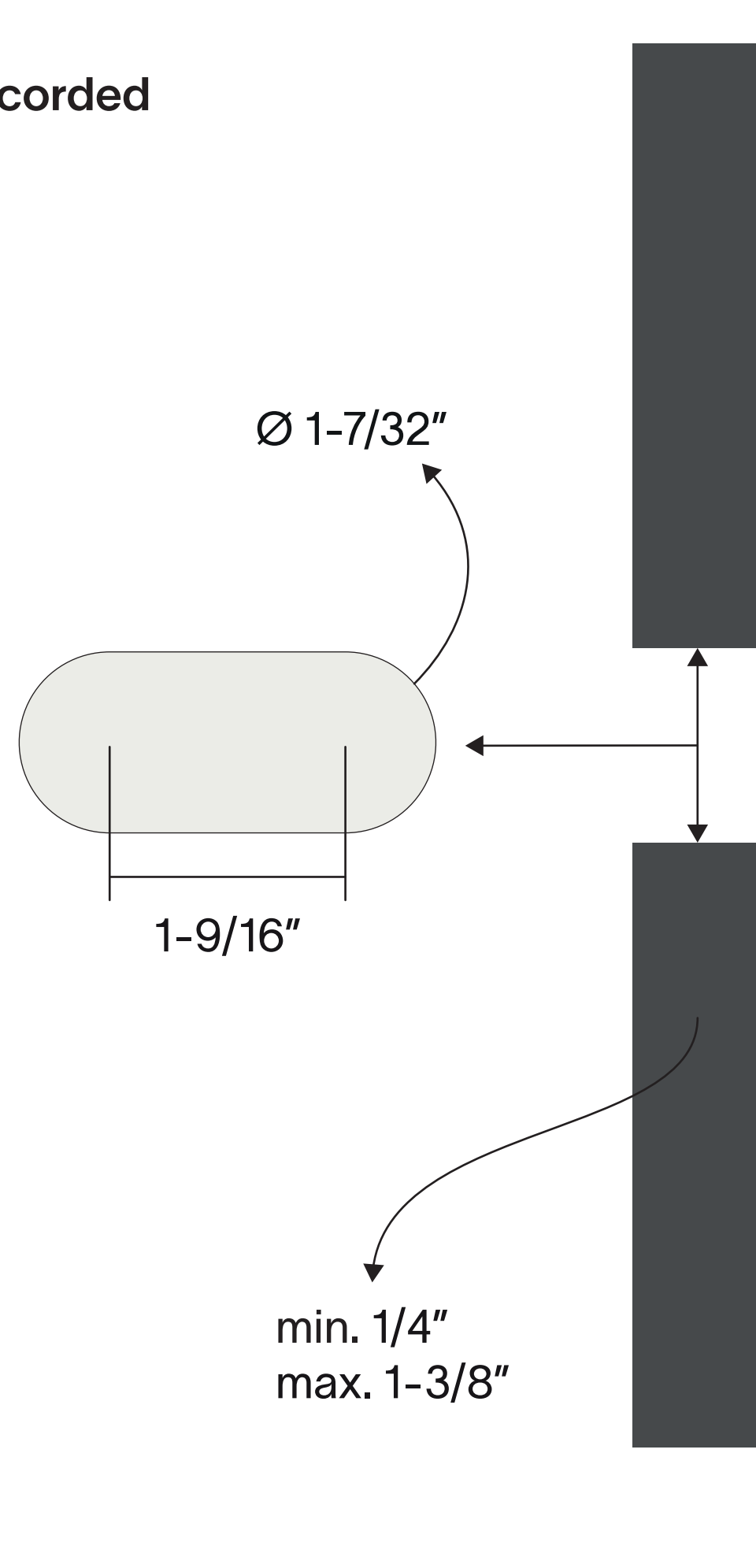

Mill the installation hole.

16

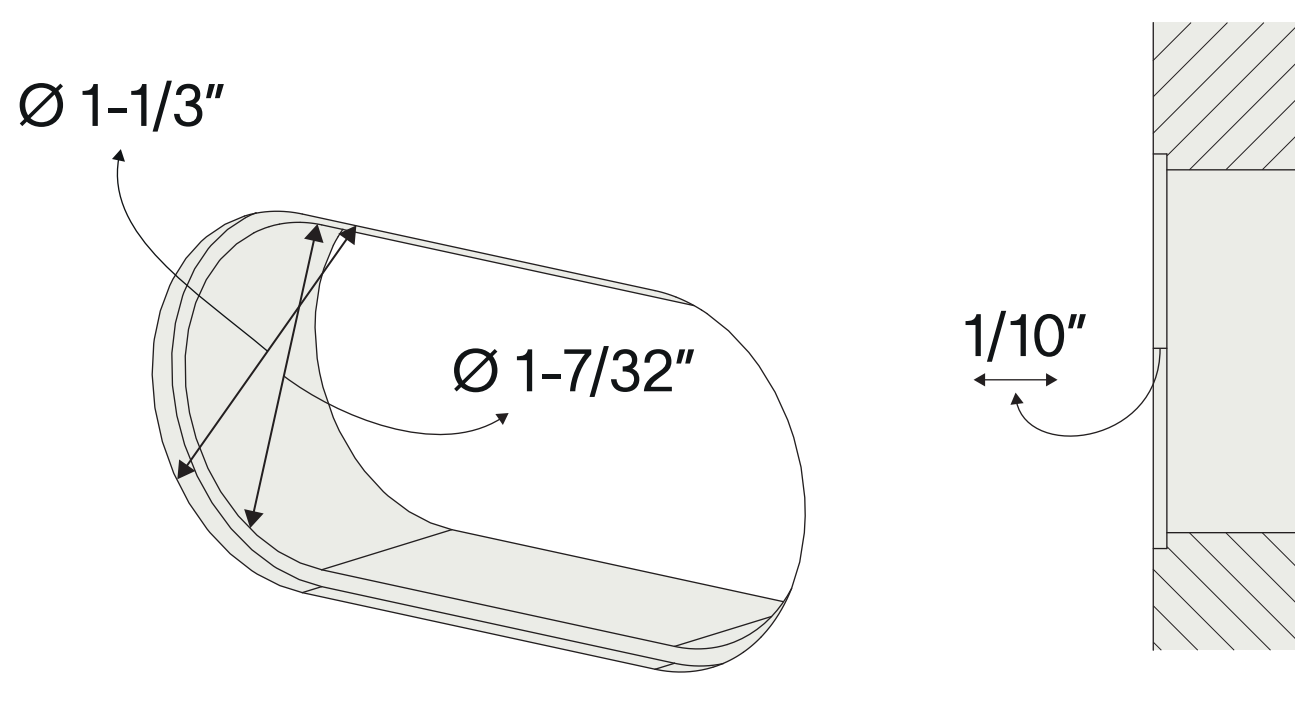

Optional: flush mount countersink.

17

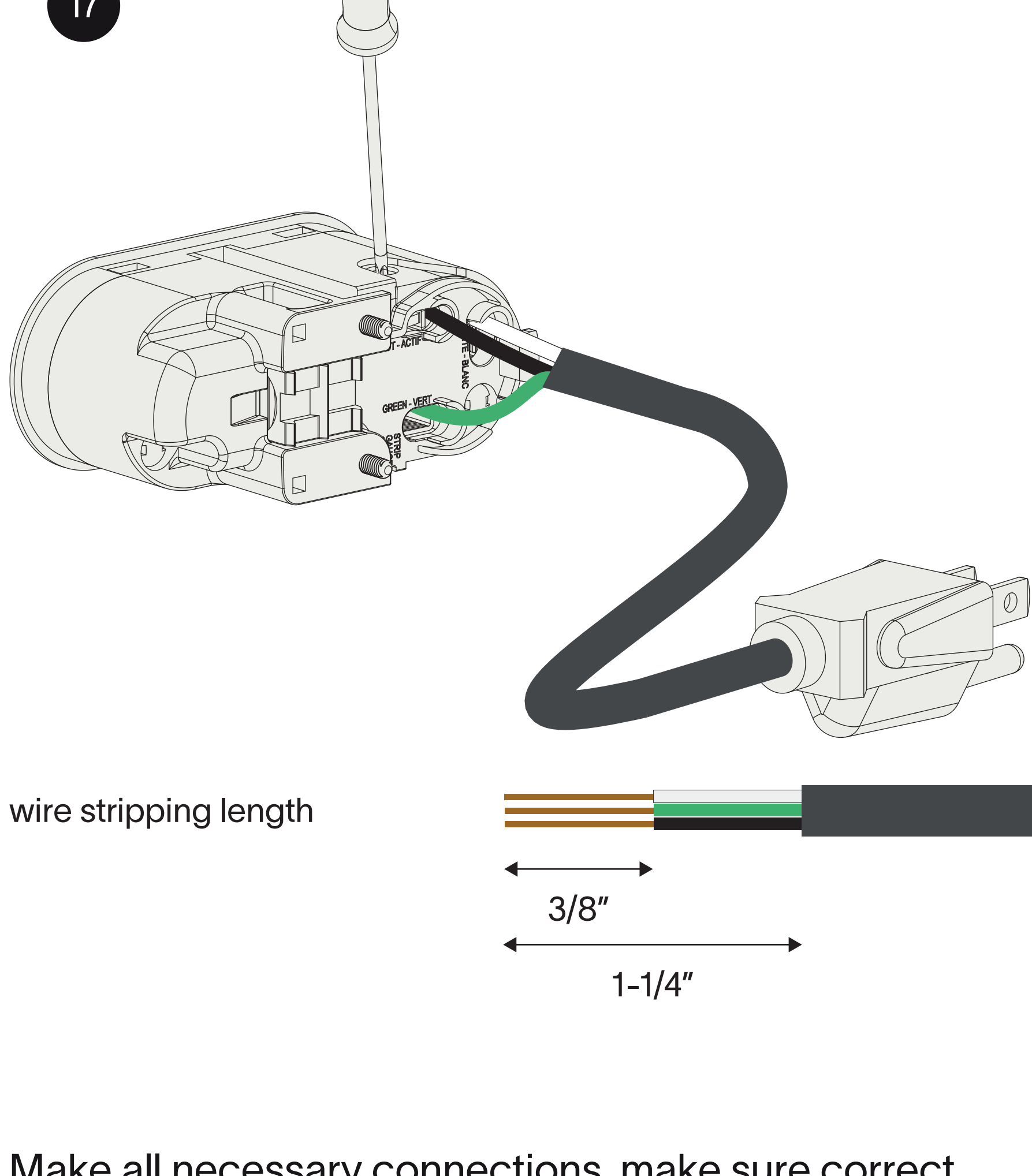

Make all necessary connections, make sure correct

wire thickness is used:

- 15A – 14 AWG
- 20A - 12 AWG

18

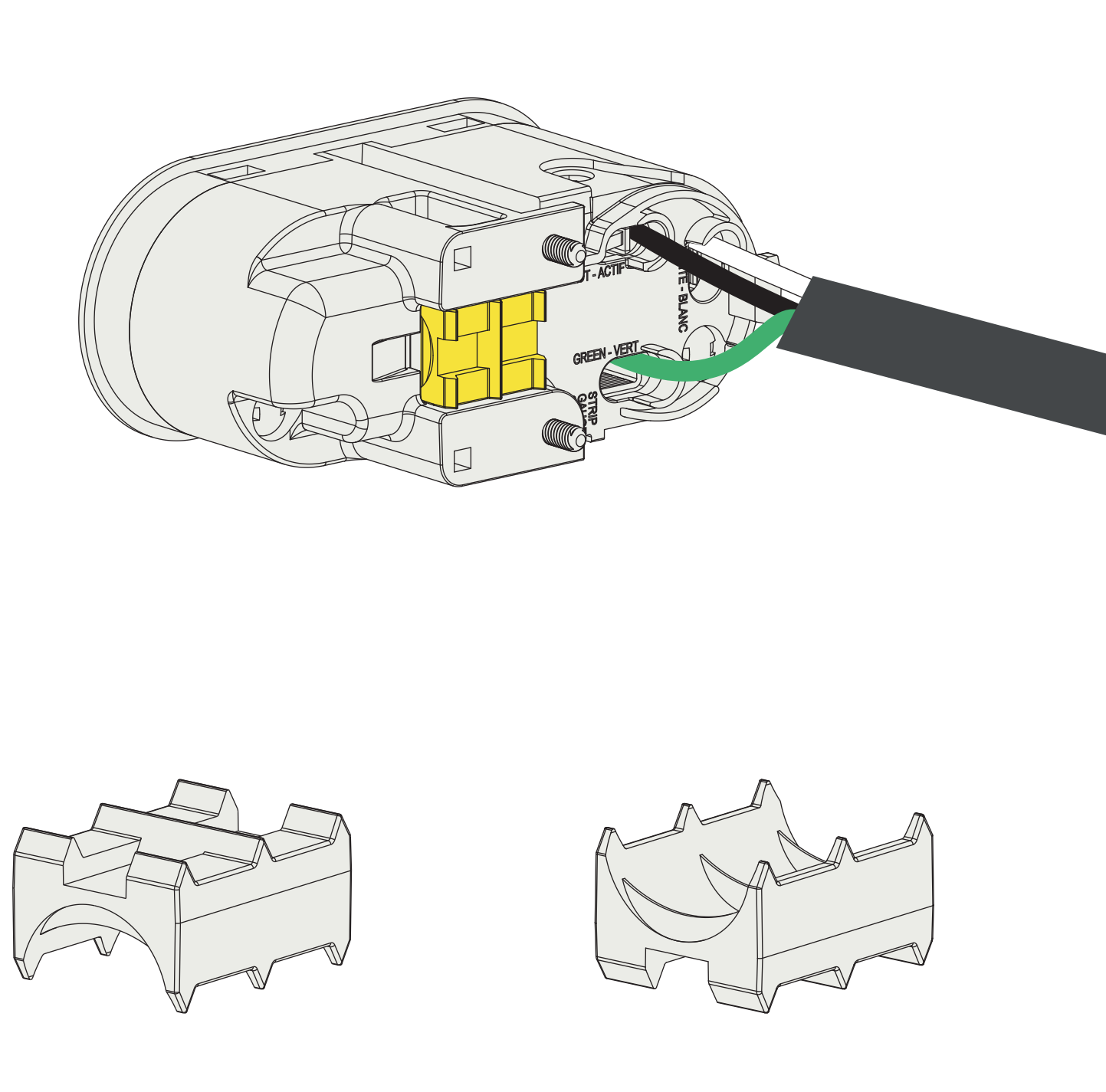

Use the appropriate side of the strain relief depending on the used cable.

19

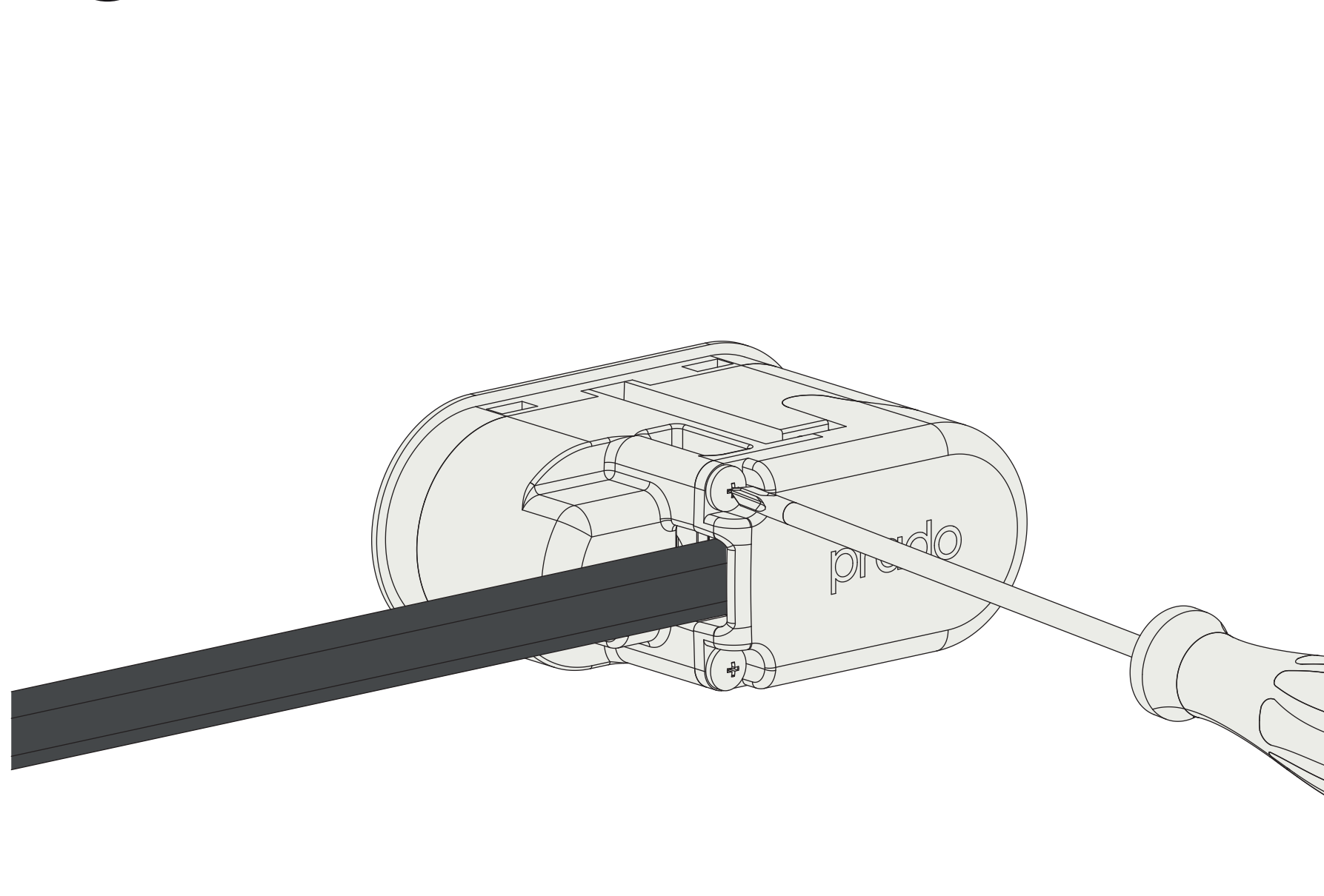

Fasten the strain relief.

20

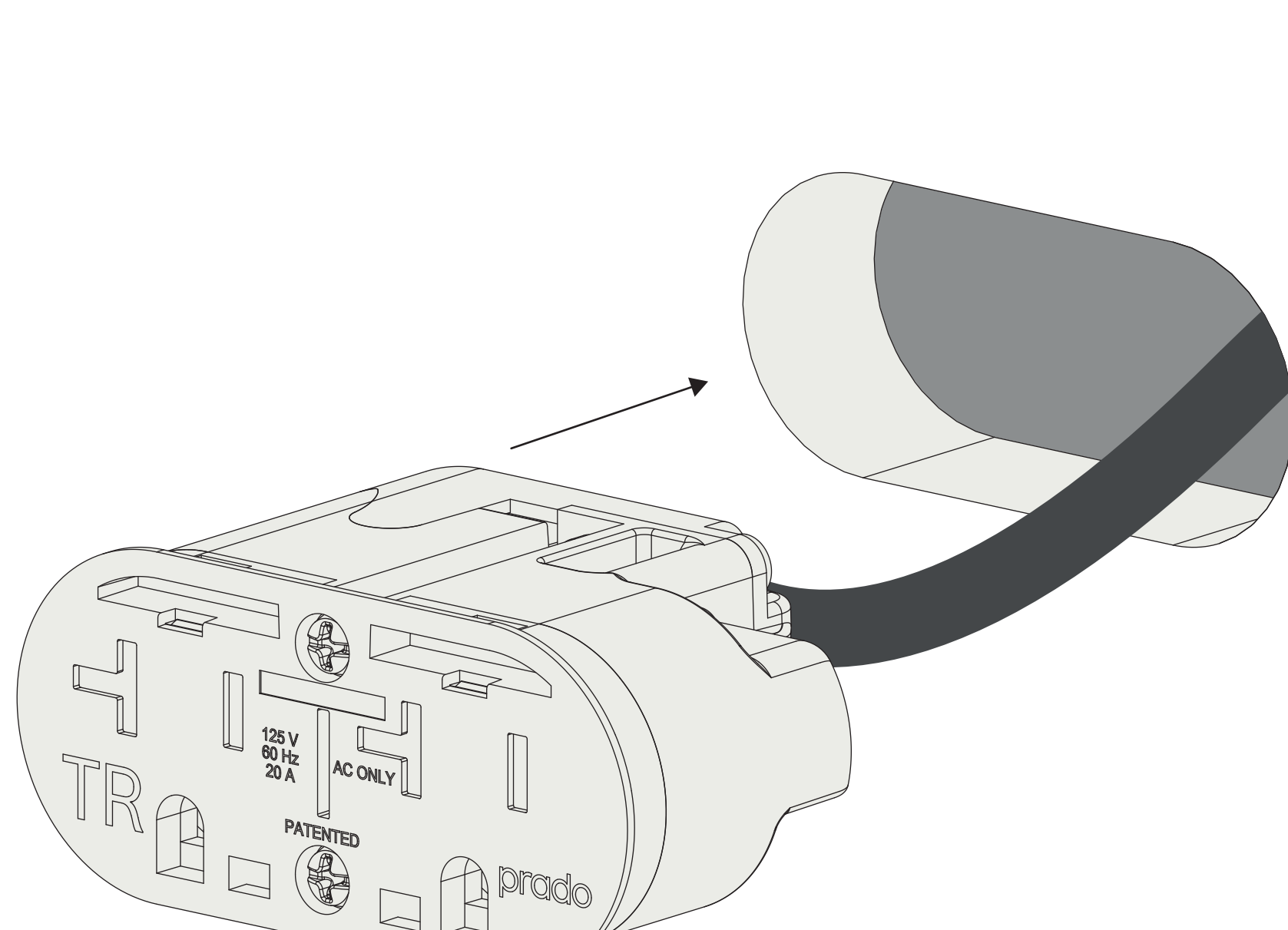

Insert the outlet in the hole and go to step 21 ([click here](#)).

21

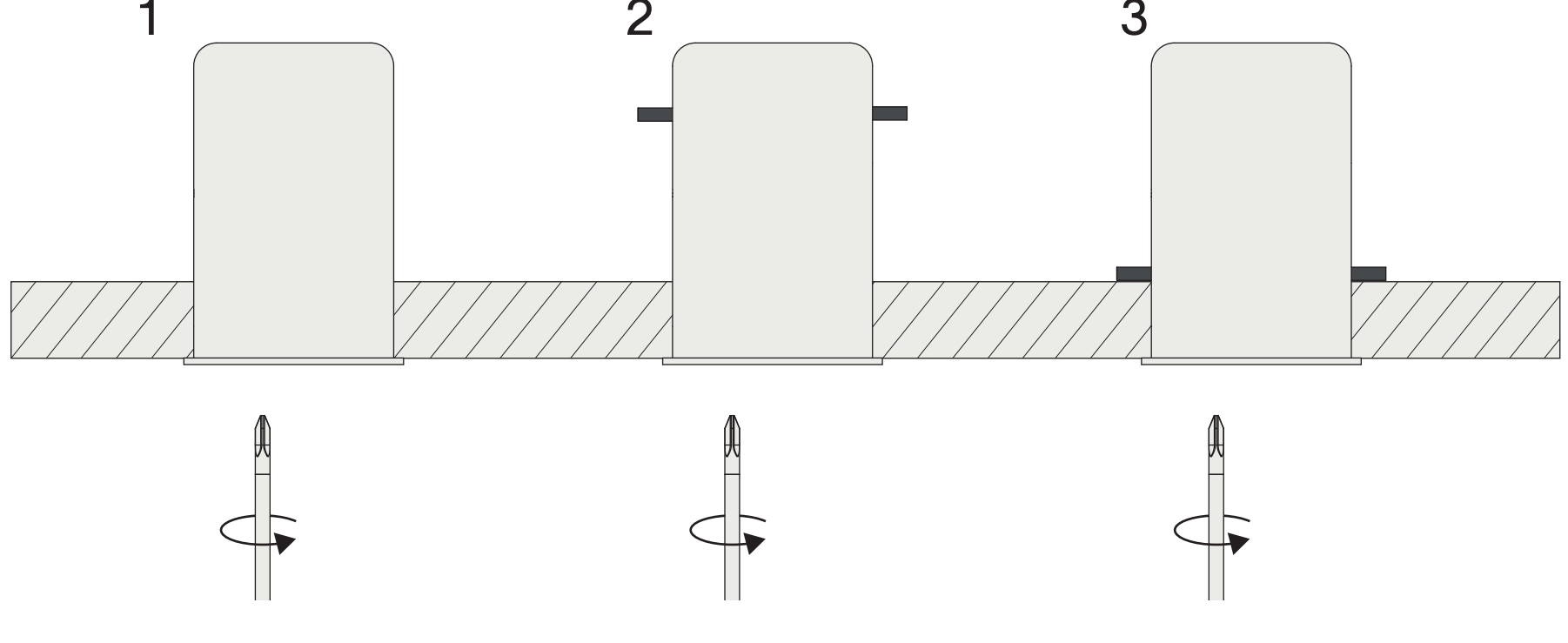
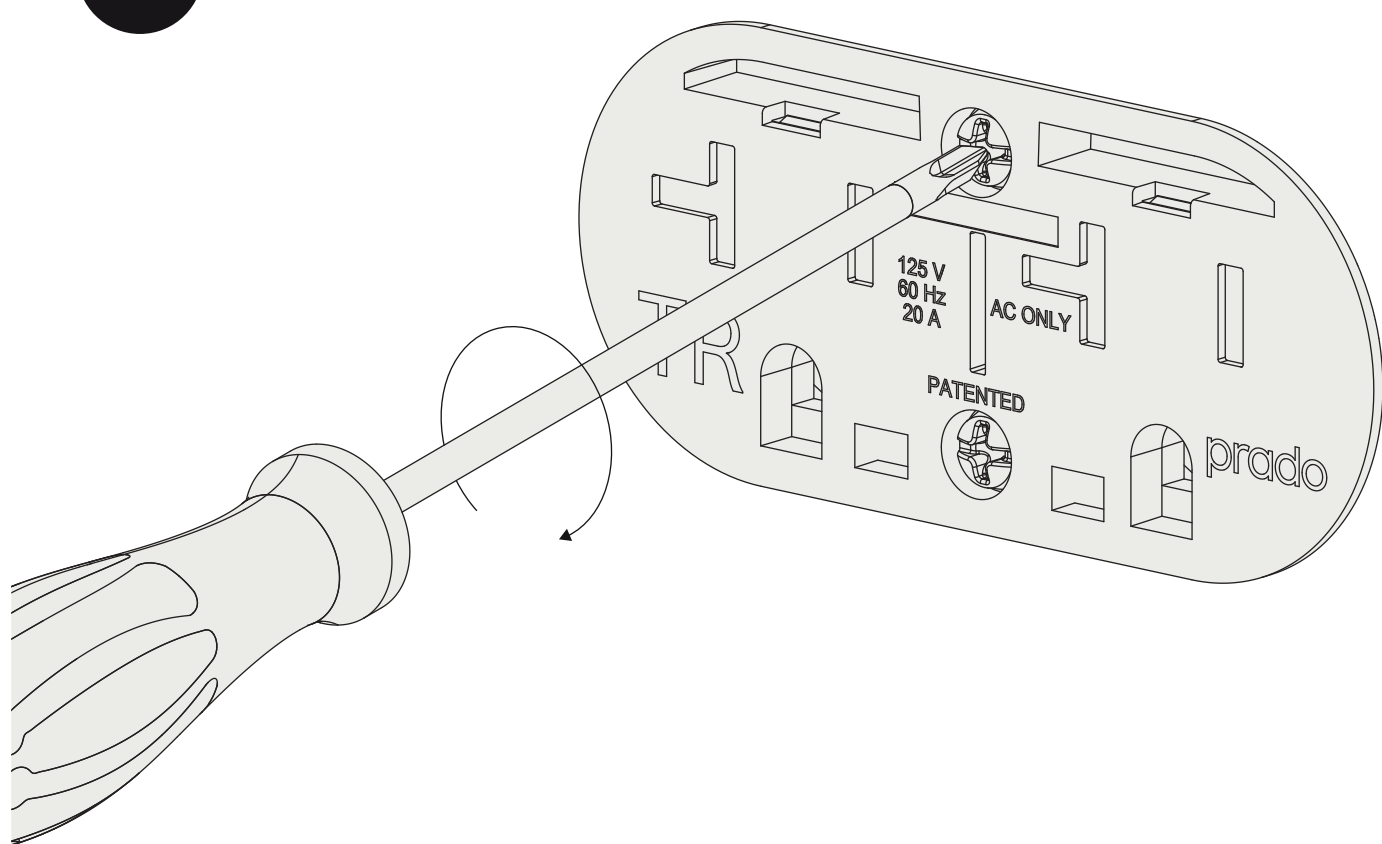

Fixate the outlet by tightning the screws.

22

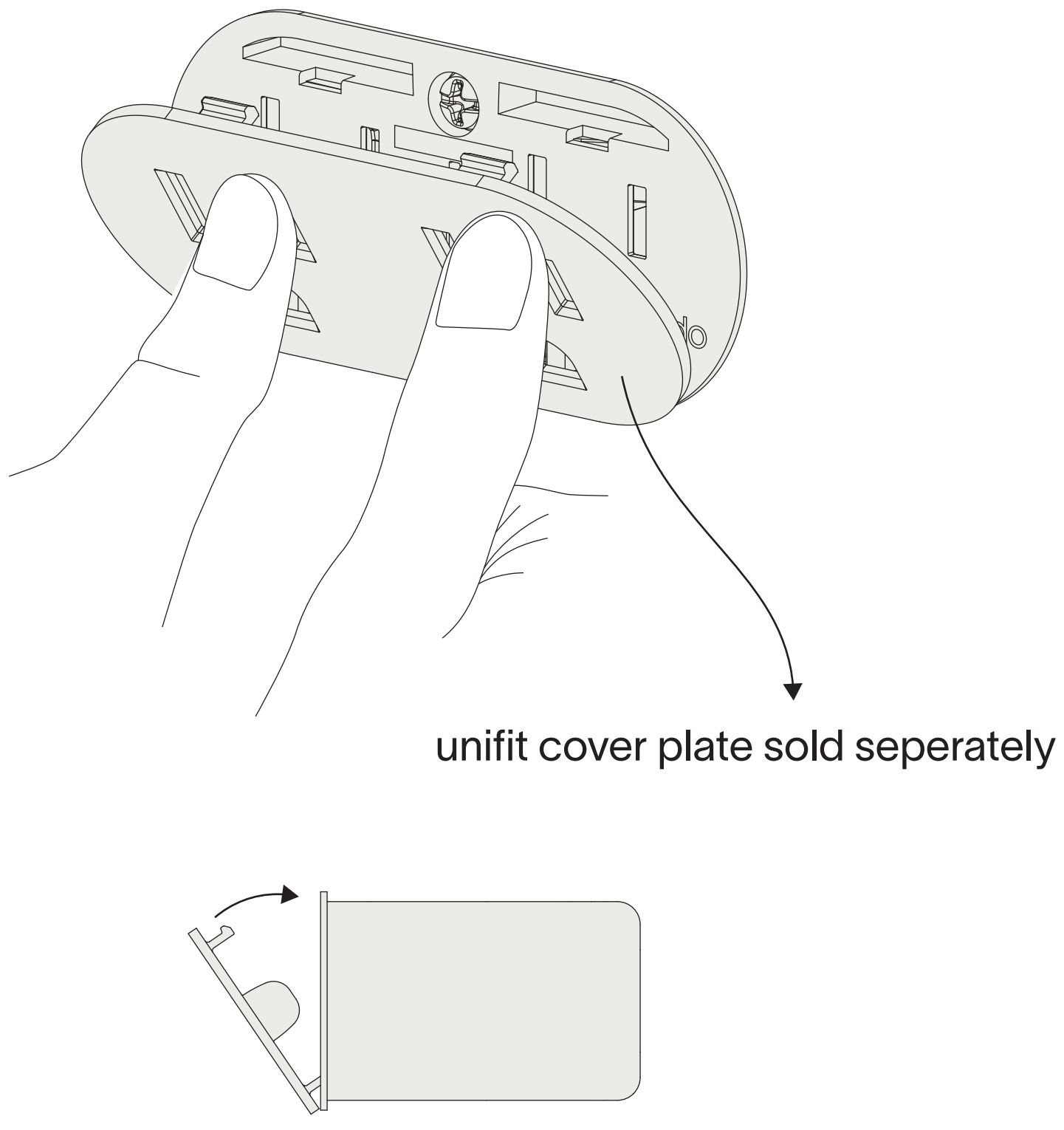

finish	SKU - 15A	SKU - 20A
black	9000-0062	9000-0063
white	9000-0064	9000-0065
sand	9000-0066	9000-0067
clay	9000-0068	9000-0069

23

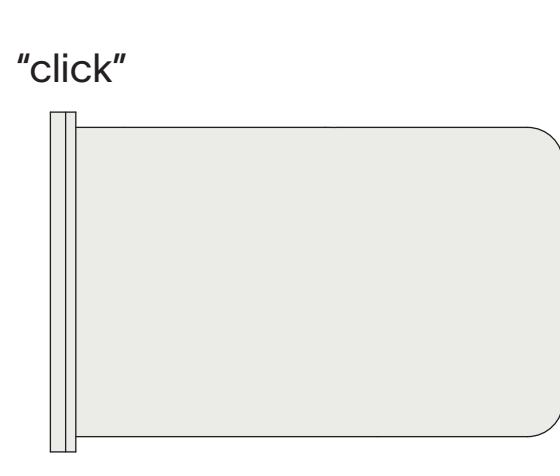
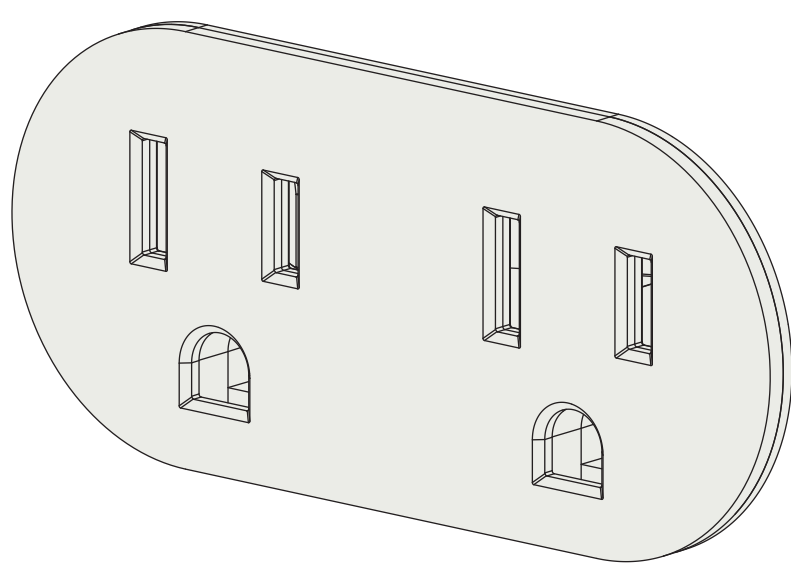

Install the cover plate.

24

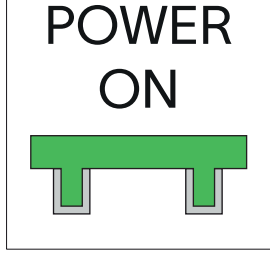
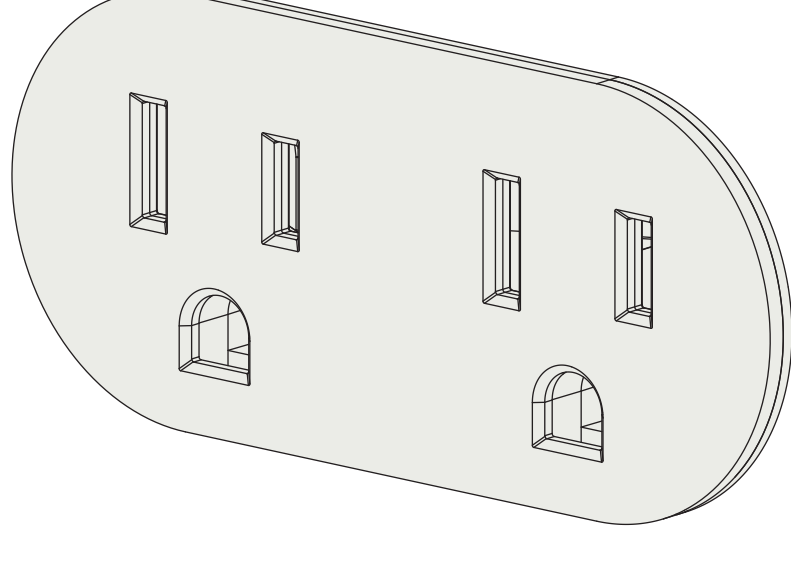

Turn the power on.

for removal

25

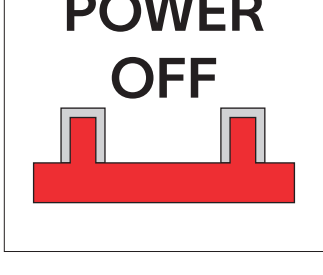
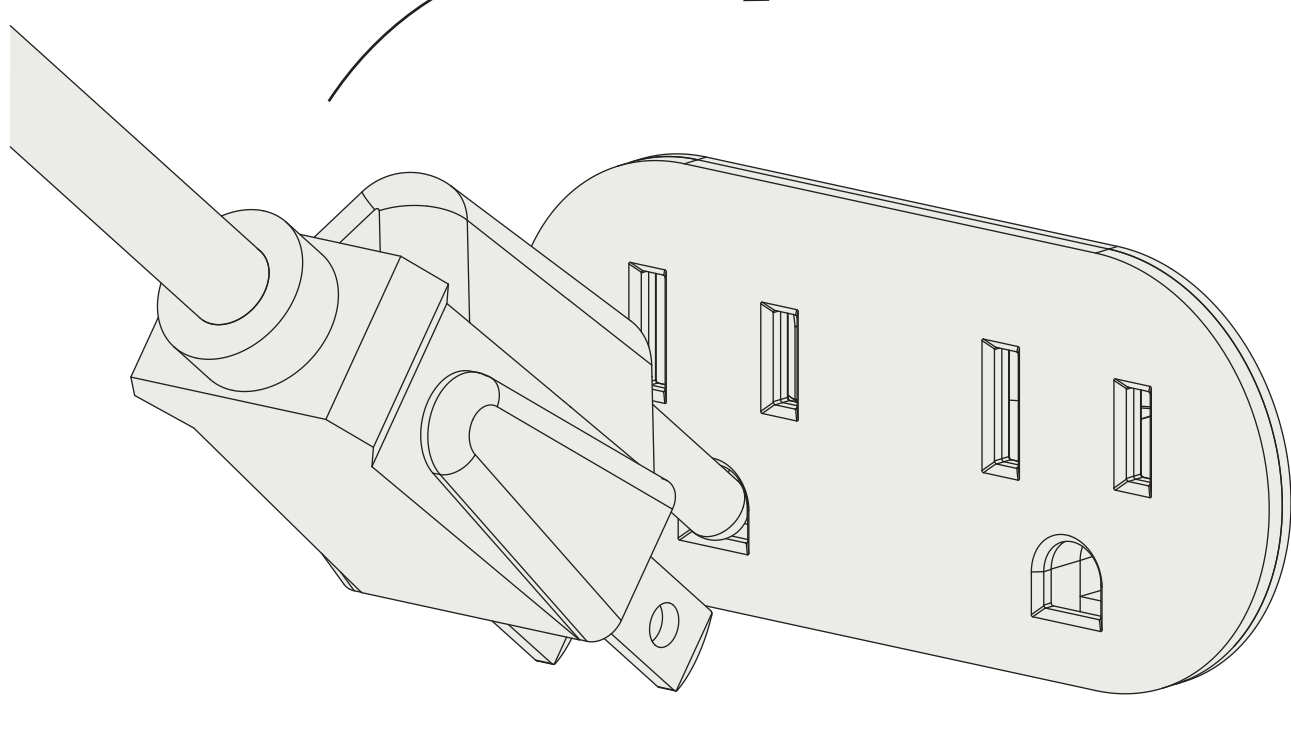

Turn the power off before removing the outlet.

26

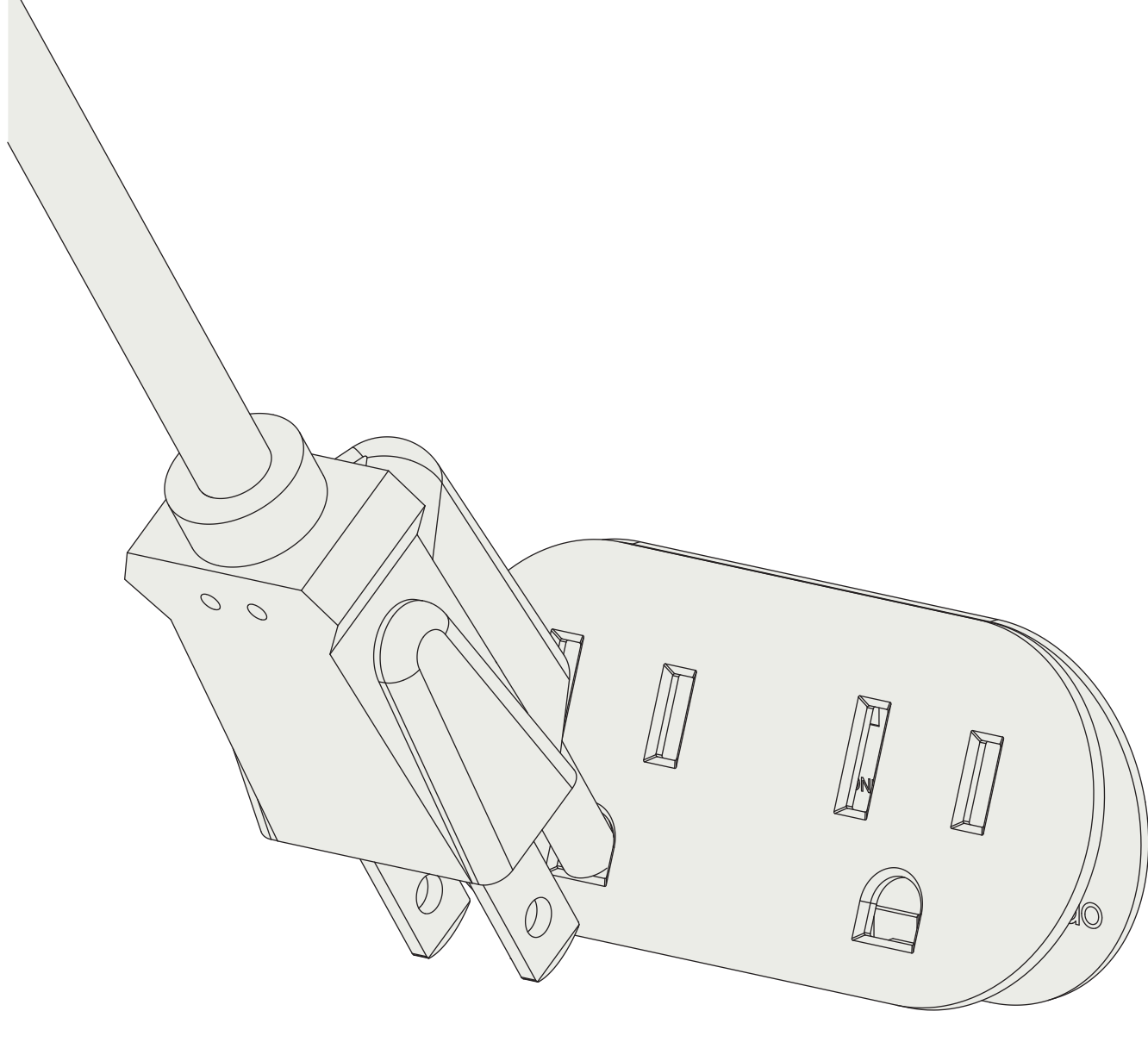

Click off the cover plate using a plug.

27

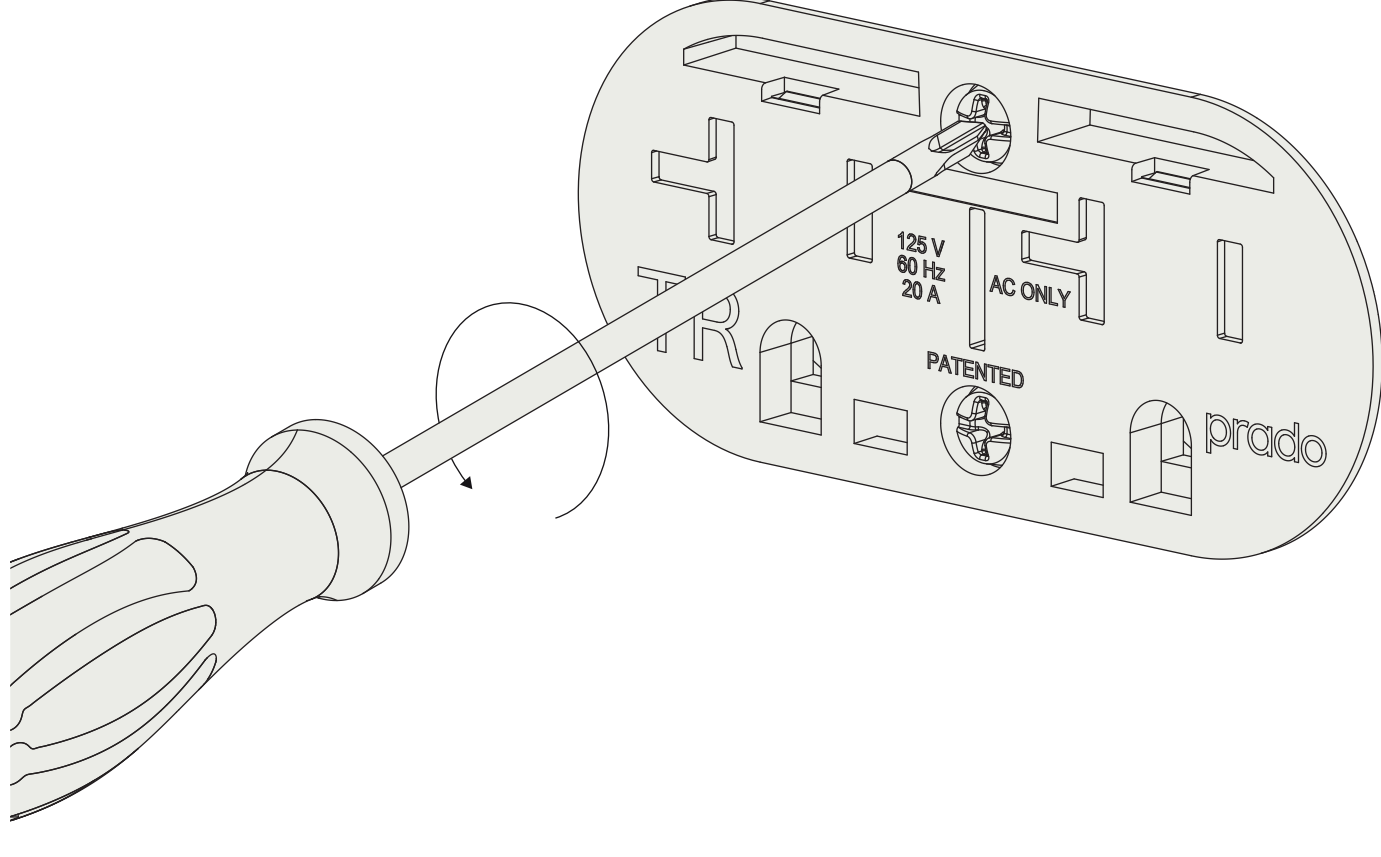

Loosen the screws.

28

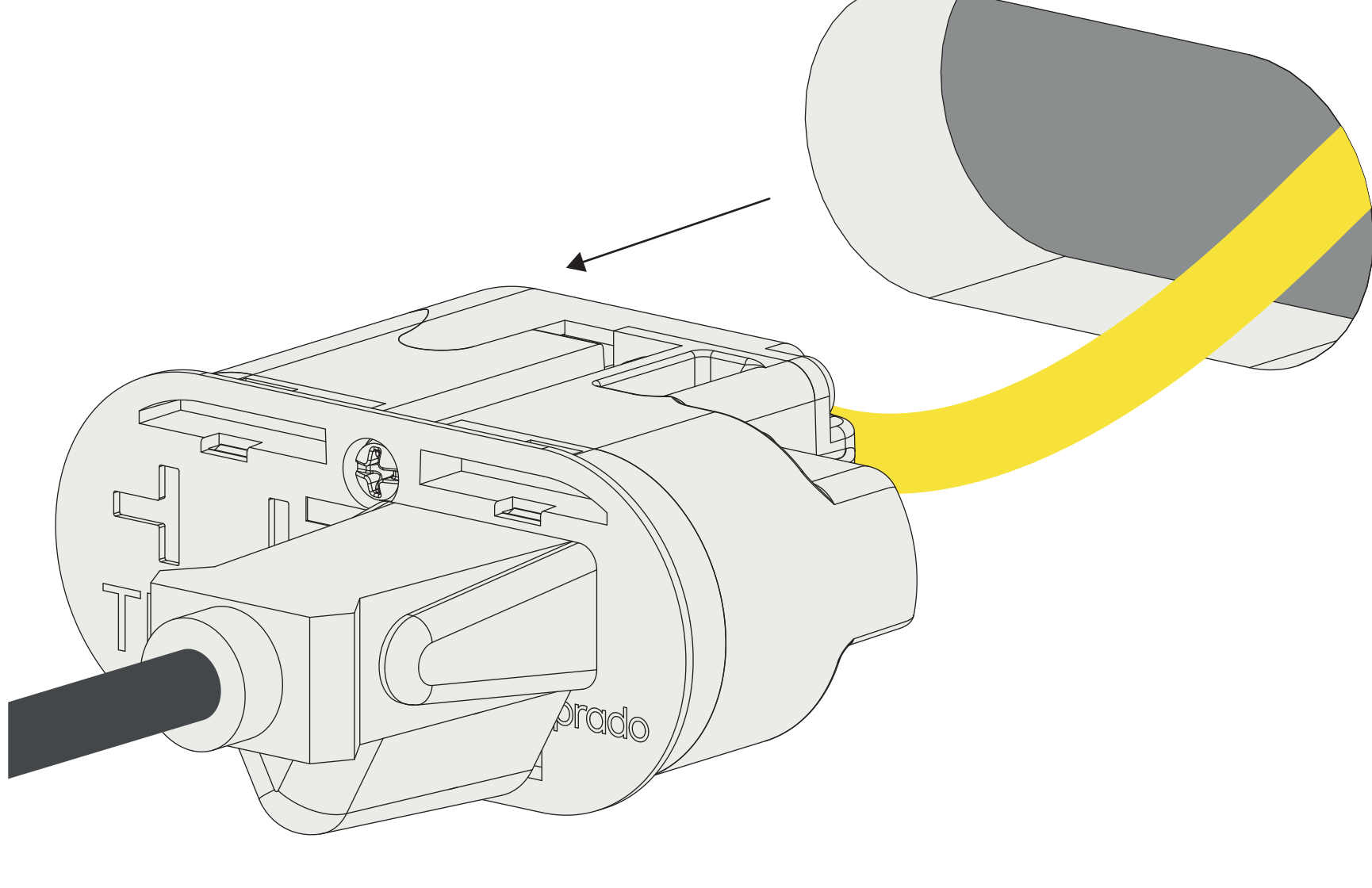

Remove the outlet by using a plug.
Thank you for choosing prado.