

Unifit outlet duplex

installation instruction

1

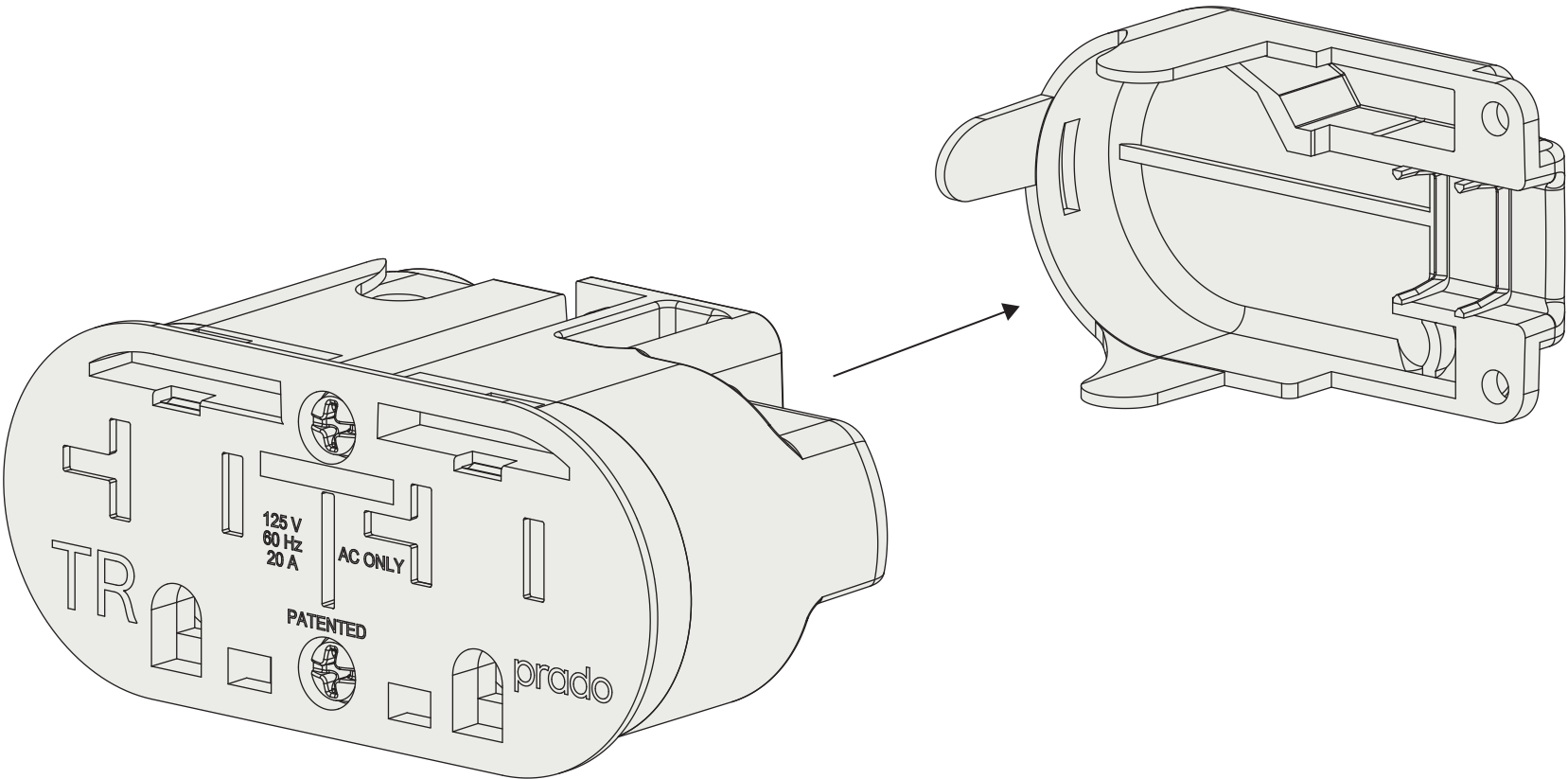

Remove the strain relief.

2

for self-contained go to **step 3** ([click here](#))

for hardwired - with back box go to **step 10** ([click here](#))

for removal go to **step 19** ([click here](#))

3

self-contained

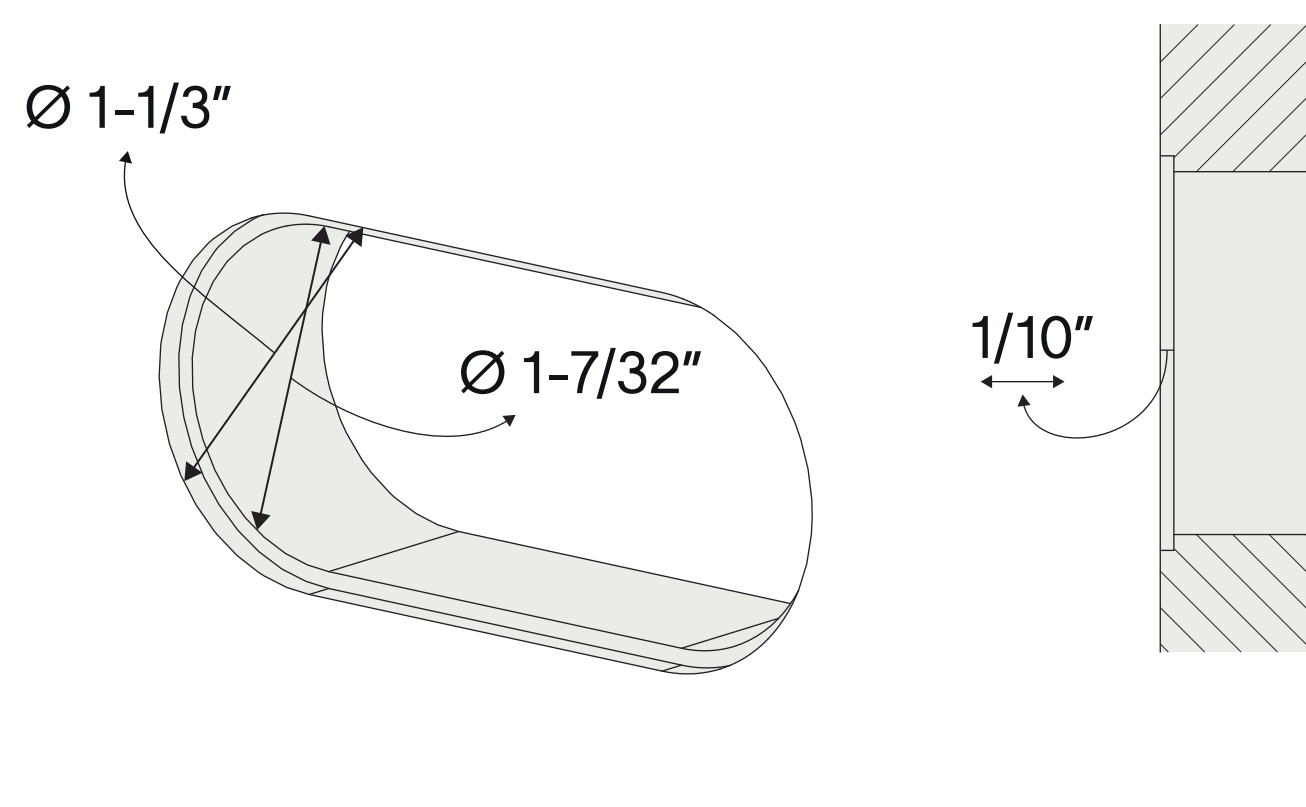
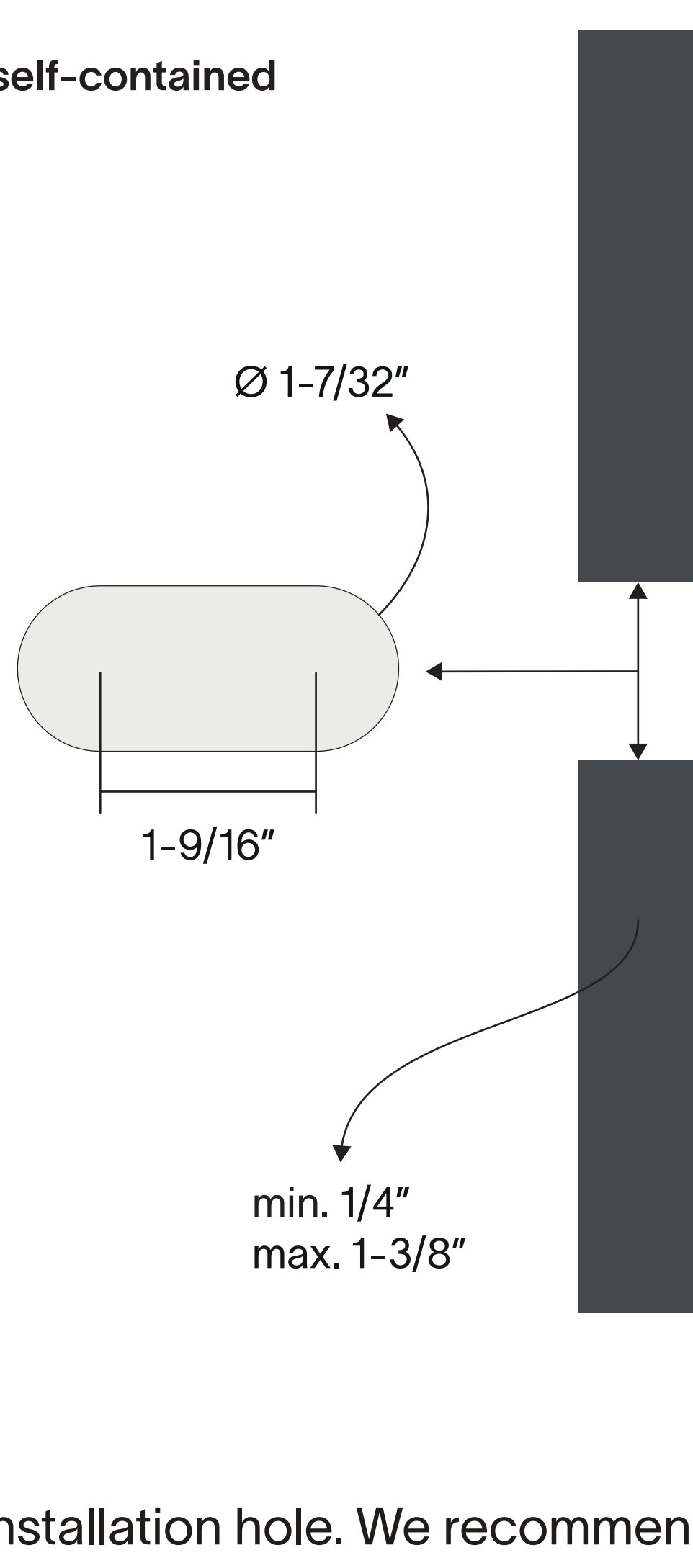

Optional: flush mount countersink.

Use a CNC machine to make the countersink hole. Alternatively, for wood you can use a 1/16" rabbeting router bit.

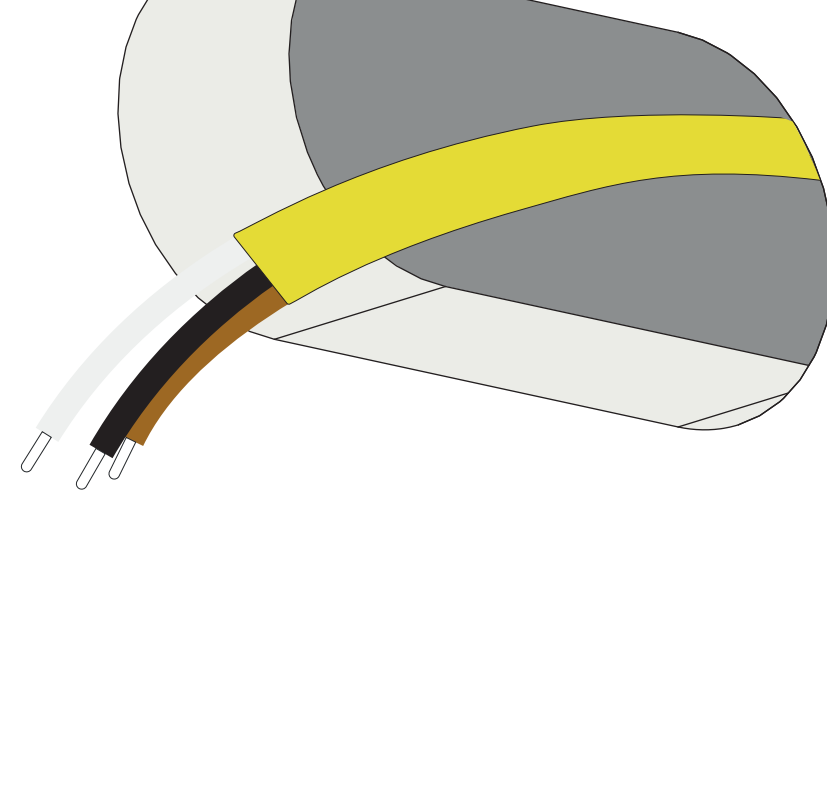

Turn the power off

6

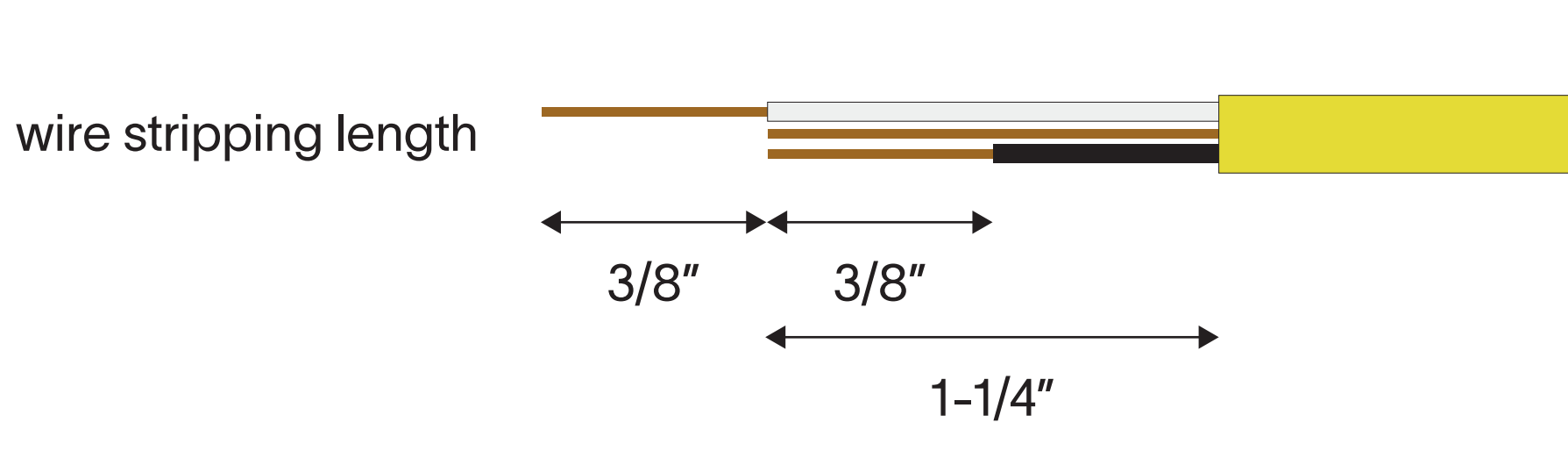
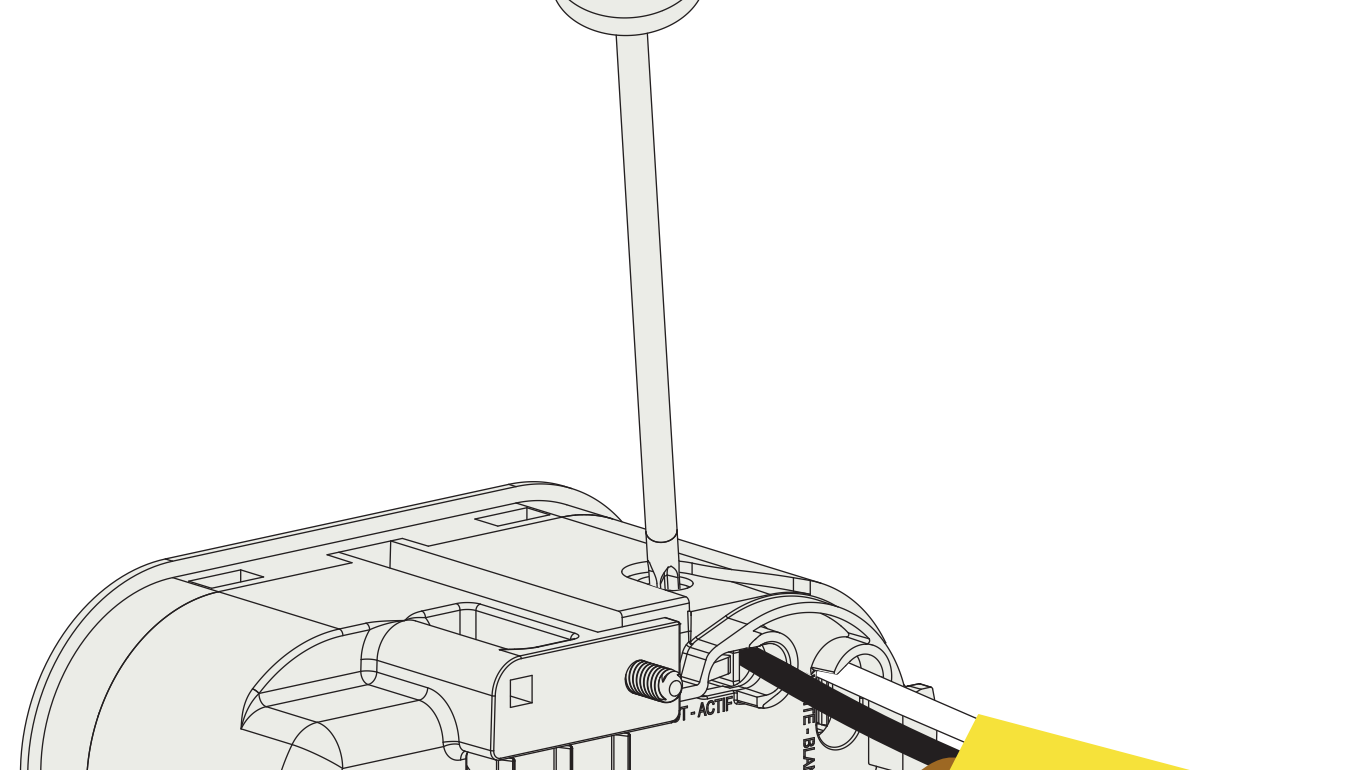

Make all necessary connections, make sure correct wire thickness is used:

- 15A – 14 AWG
- 20A – 12 AWG

- ## CONCLUSIONS

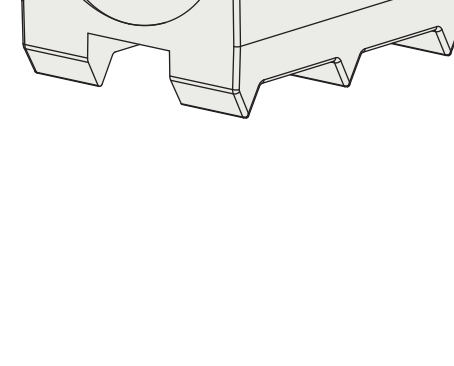
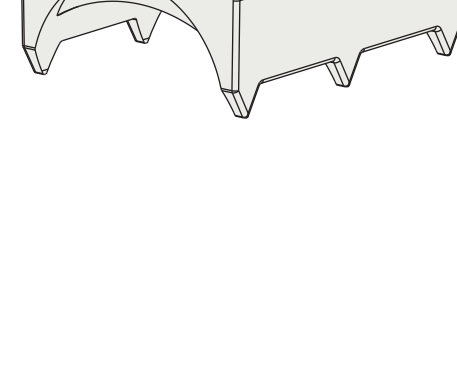
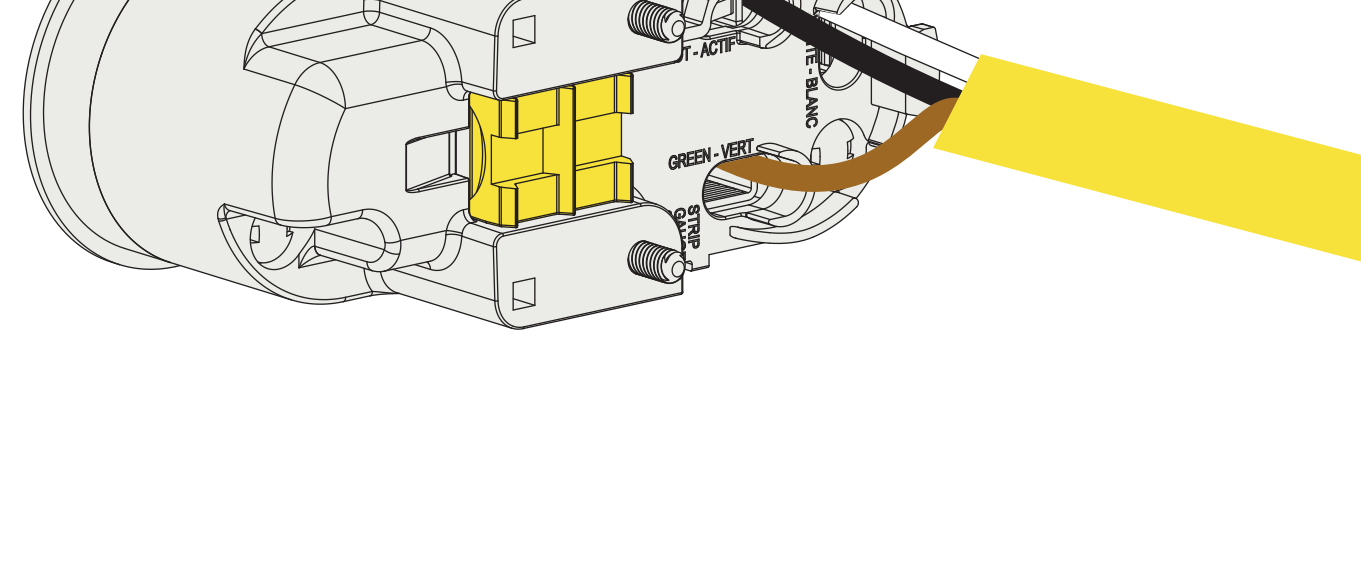

Use the appropriate side of the strain relief depending

8

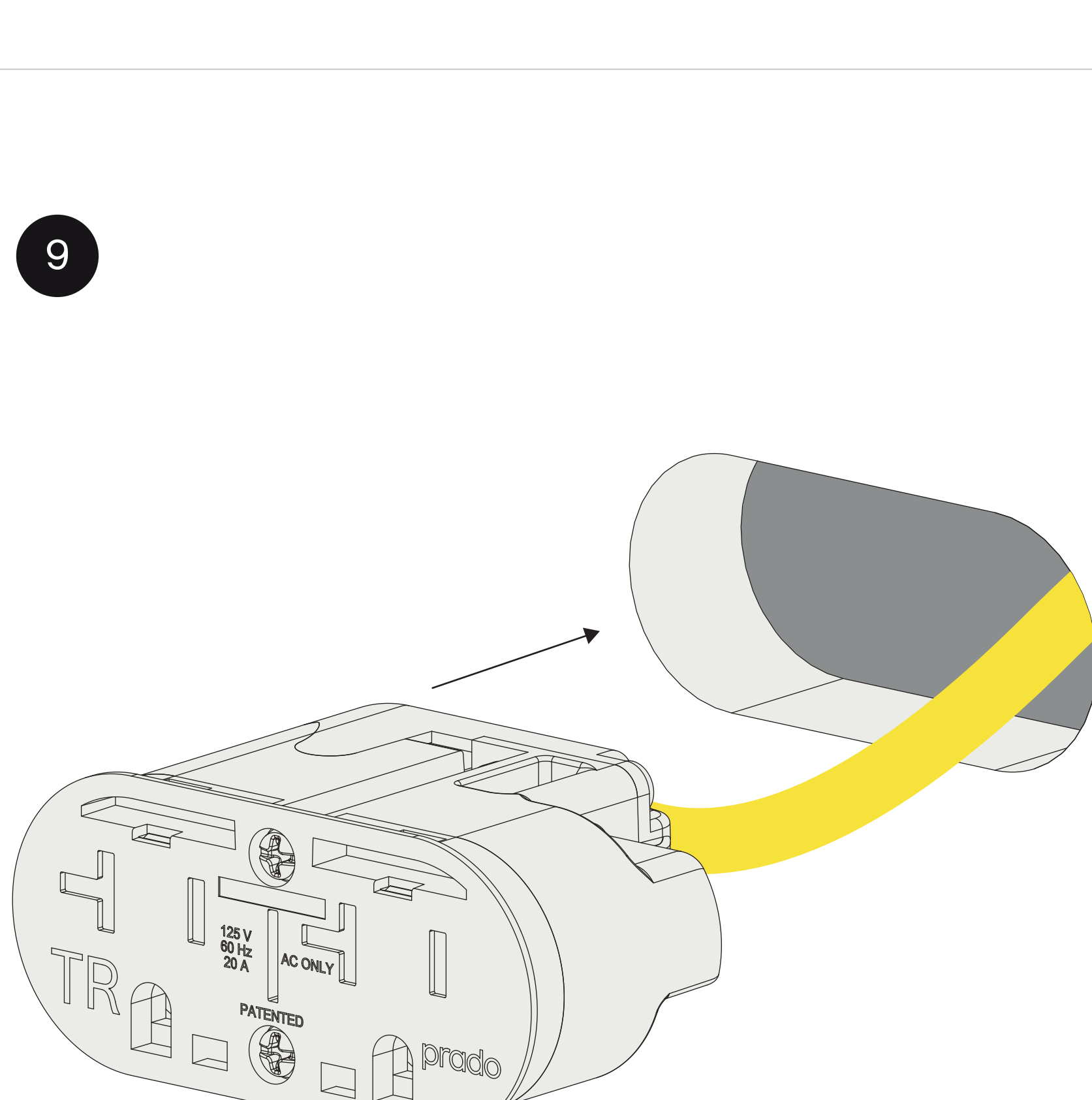
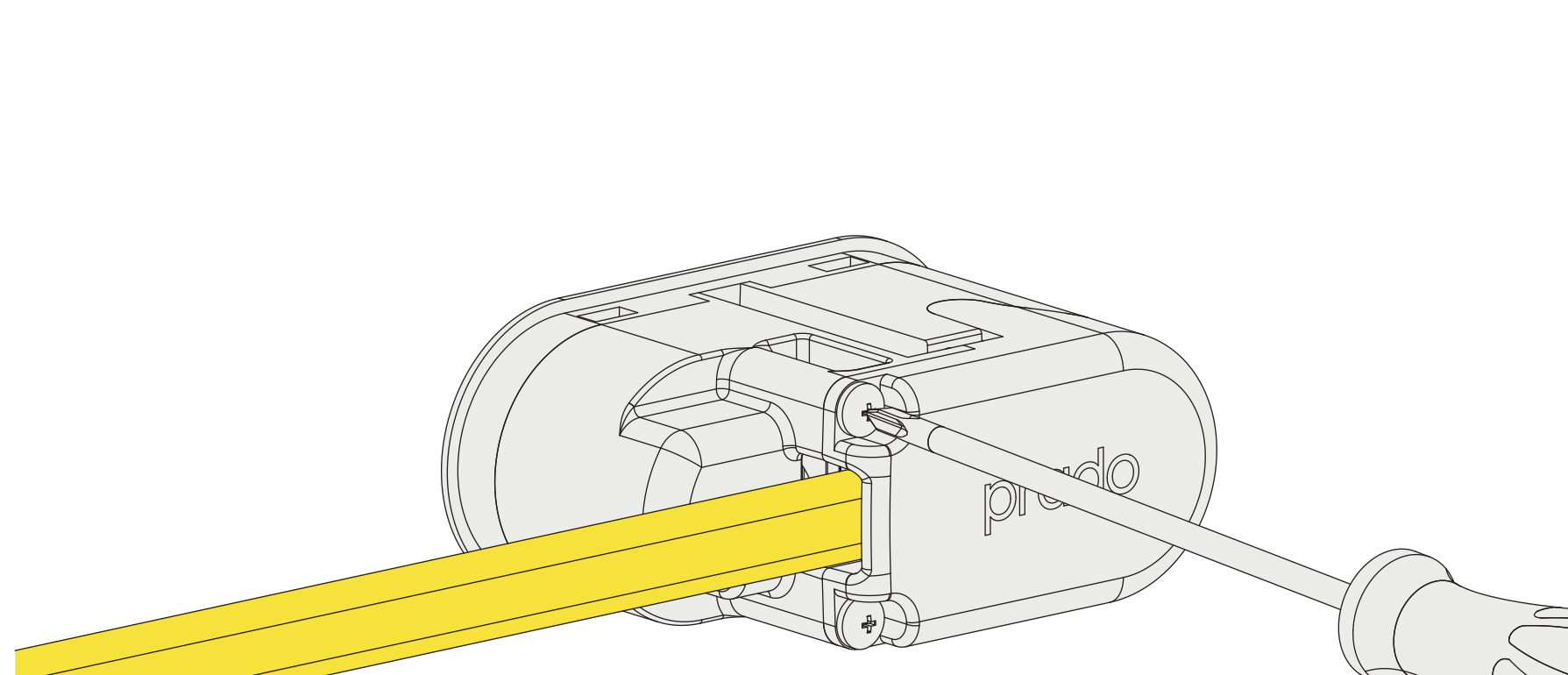

10 **hardwired - with back box**

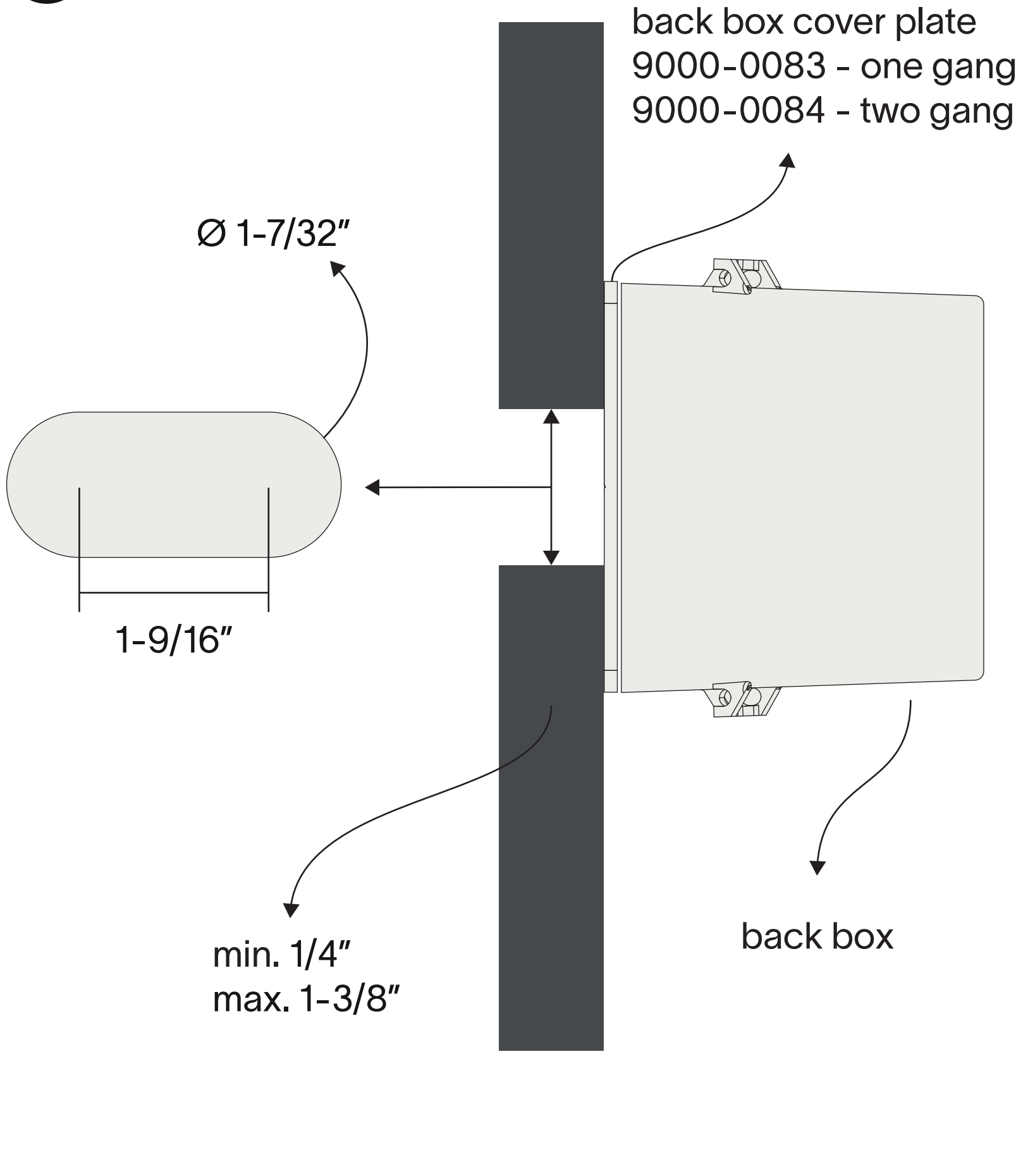

Mill the installation hole. We recommend using a CNC, waterjet or laser to create the cut-out. Hand cutting may lead to undesired results.

11

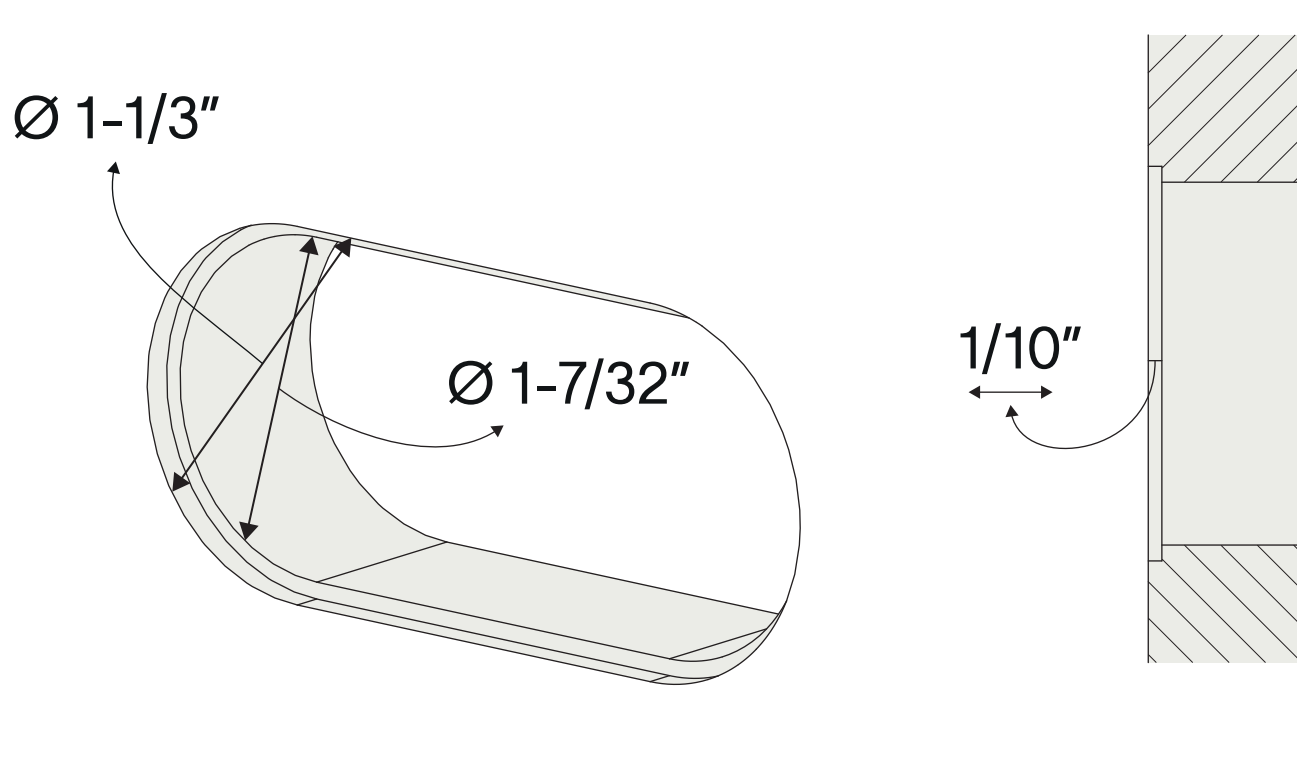

Optional: flush mount countersink.
Use a CNC machine to make the countersink hole.
Alternatively, for wood you can use a 1/16" rabbeting router bit.

12

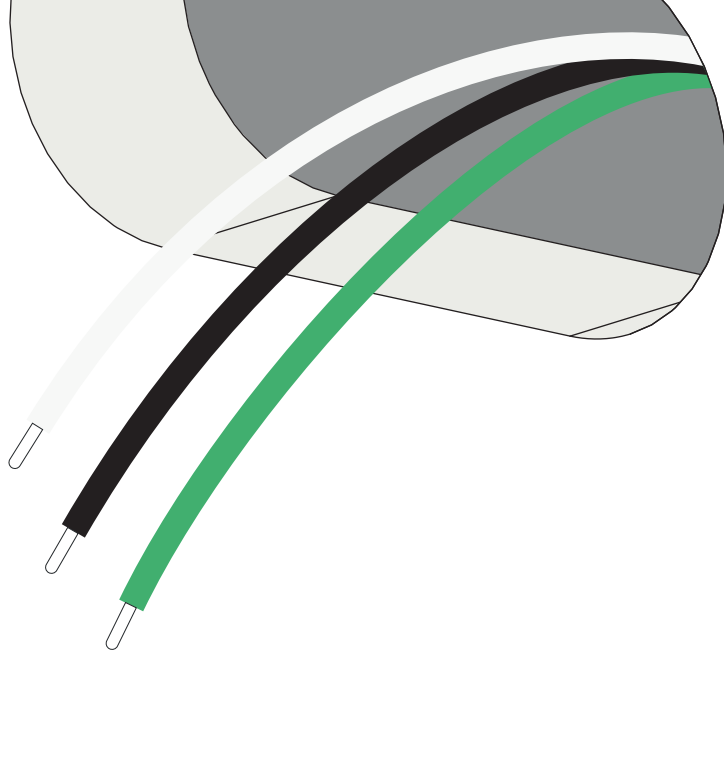

Turn the power off.
The branch circuit wiring that supplies each device consists of a separate cable assembly originating outside the box, or individual sets of conductors in a single raceway, all of which originate outside the box. Other than the connections to a single device, these conductors are not spliced in the box or continued to another device, and no other wiring or raceways enter the box.

- For Metal Box Installations, during the electrical installation:
1. Attach the equipment bonding conductor to the metal device box.
 2. Secure the branch circuit's equipment grounding wire to the green grounding screw terminal of the electrical outlet.
 3. Before installing the substrate, confirm that the green grounding screw remains visible when the receptacle is removed.

13

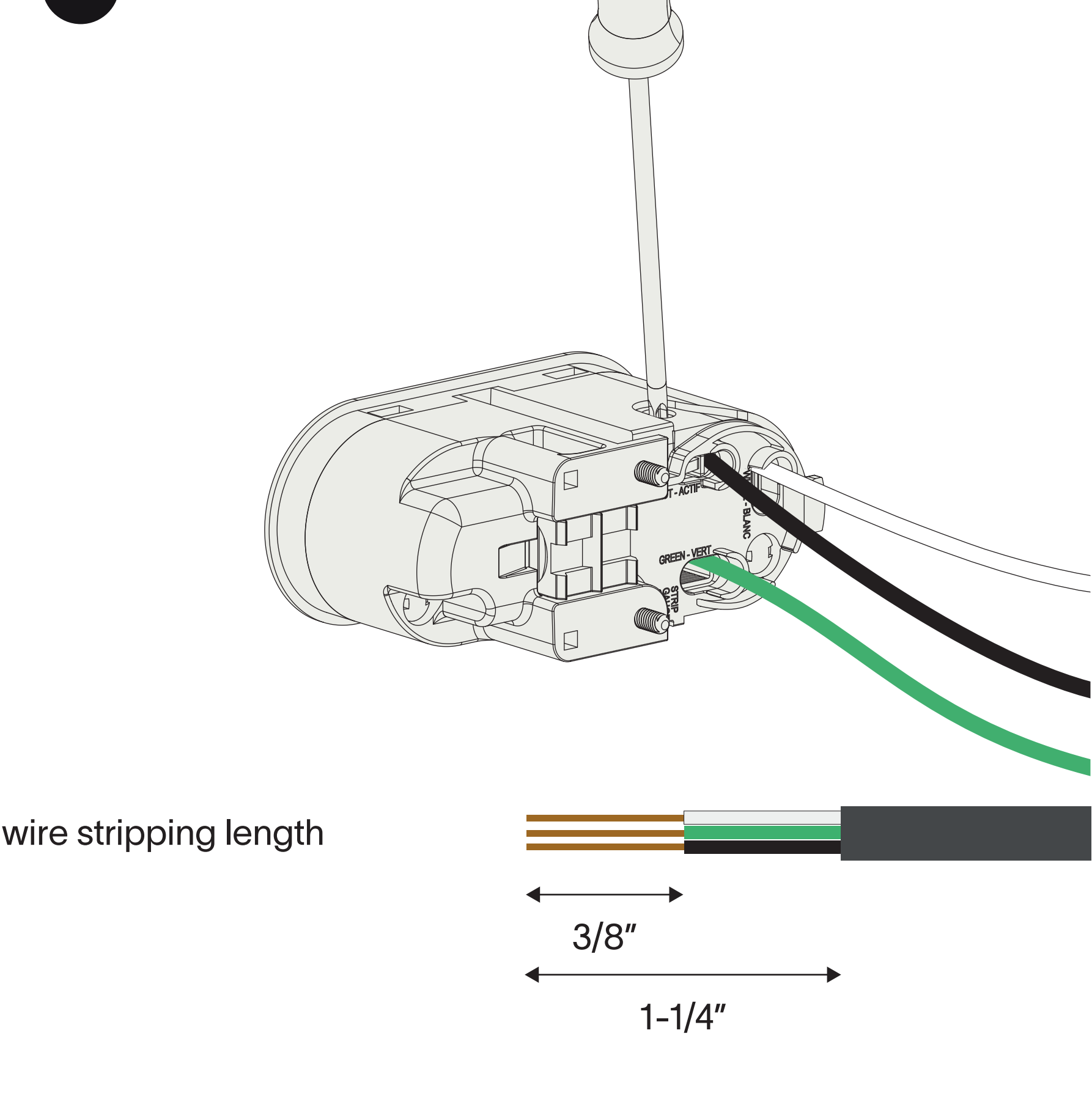

Make all necessary connections, make sure correct wire thickness is used:

- 15A – 14 AWG
- 20A - 12 AWG

14

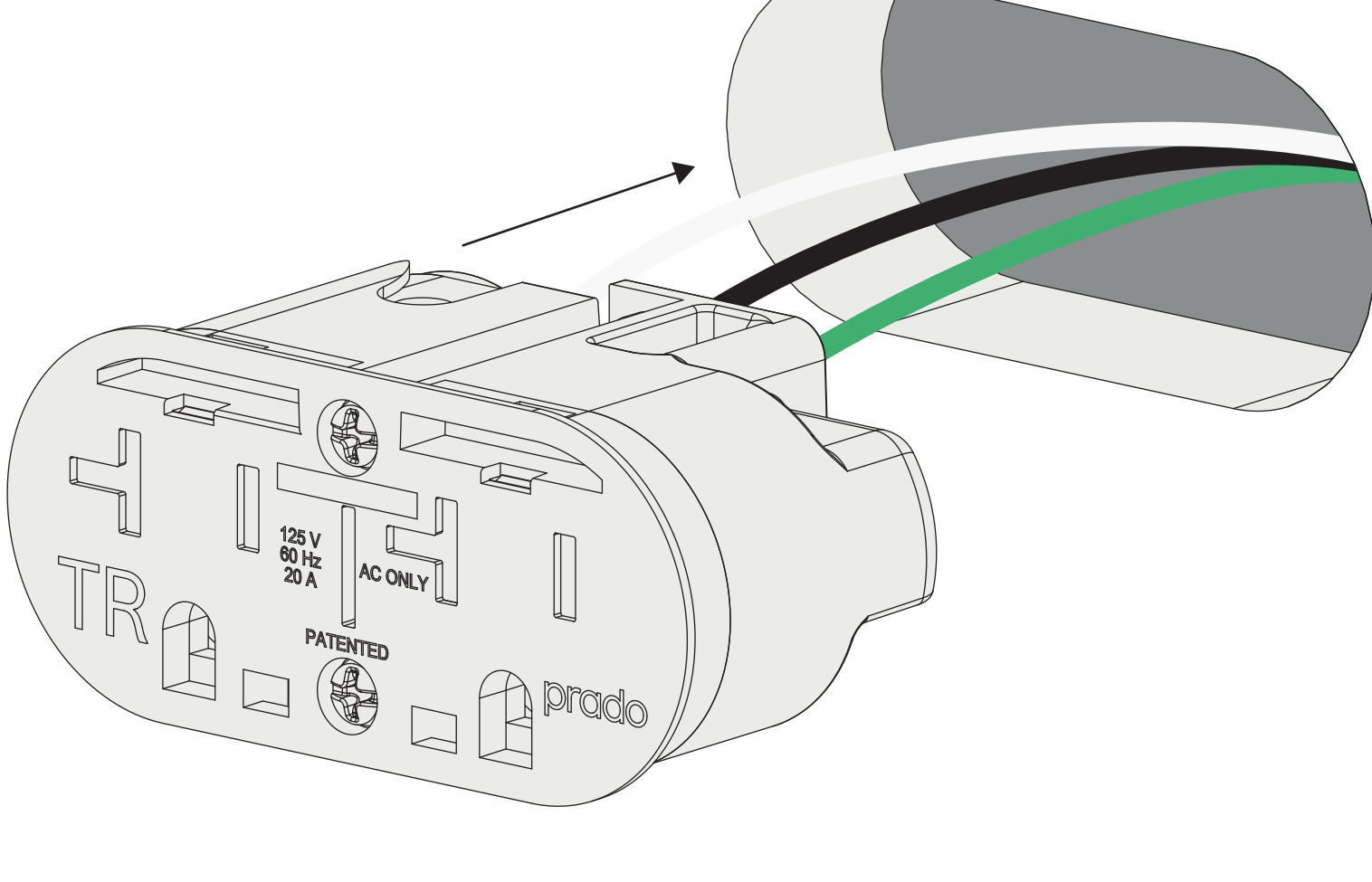

Insert the outlet in the hole and go to [step 15](#) (click here).

15

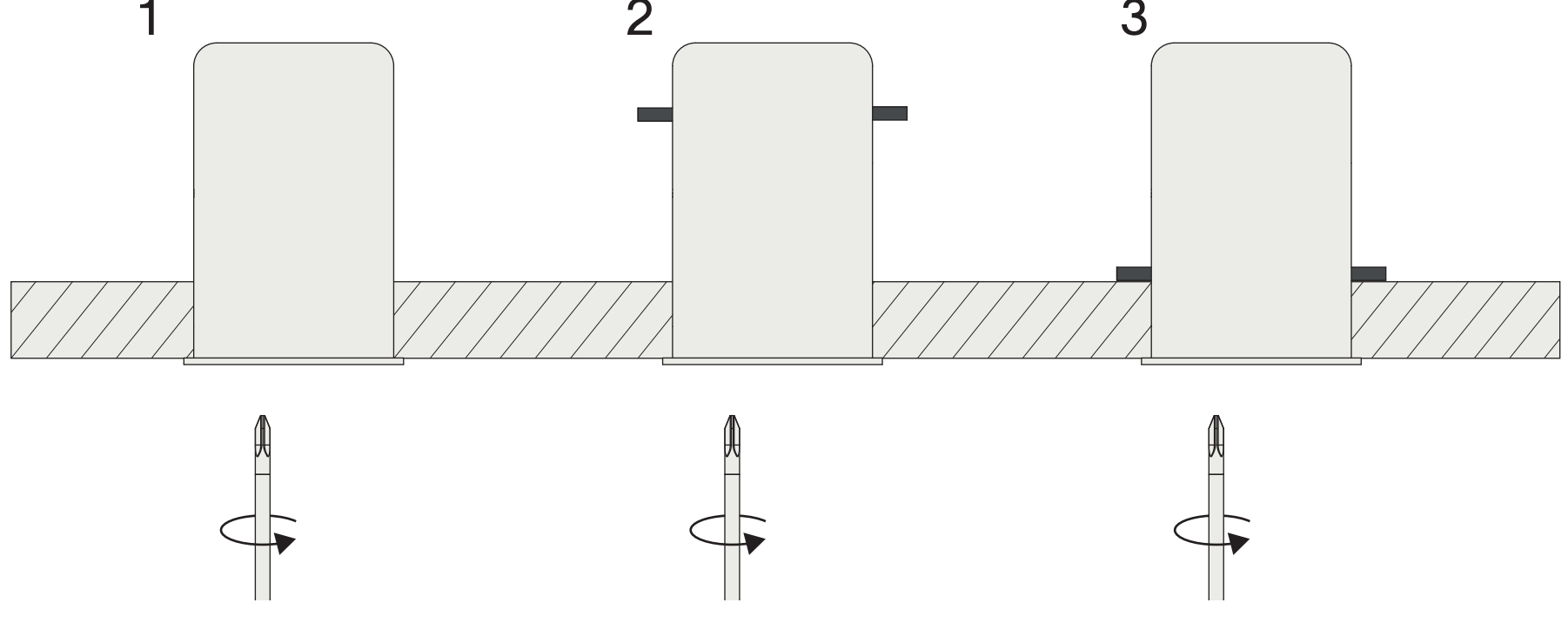
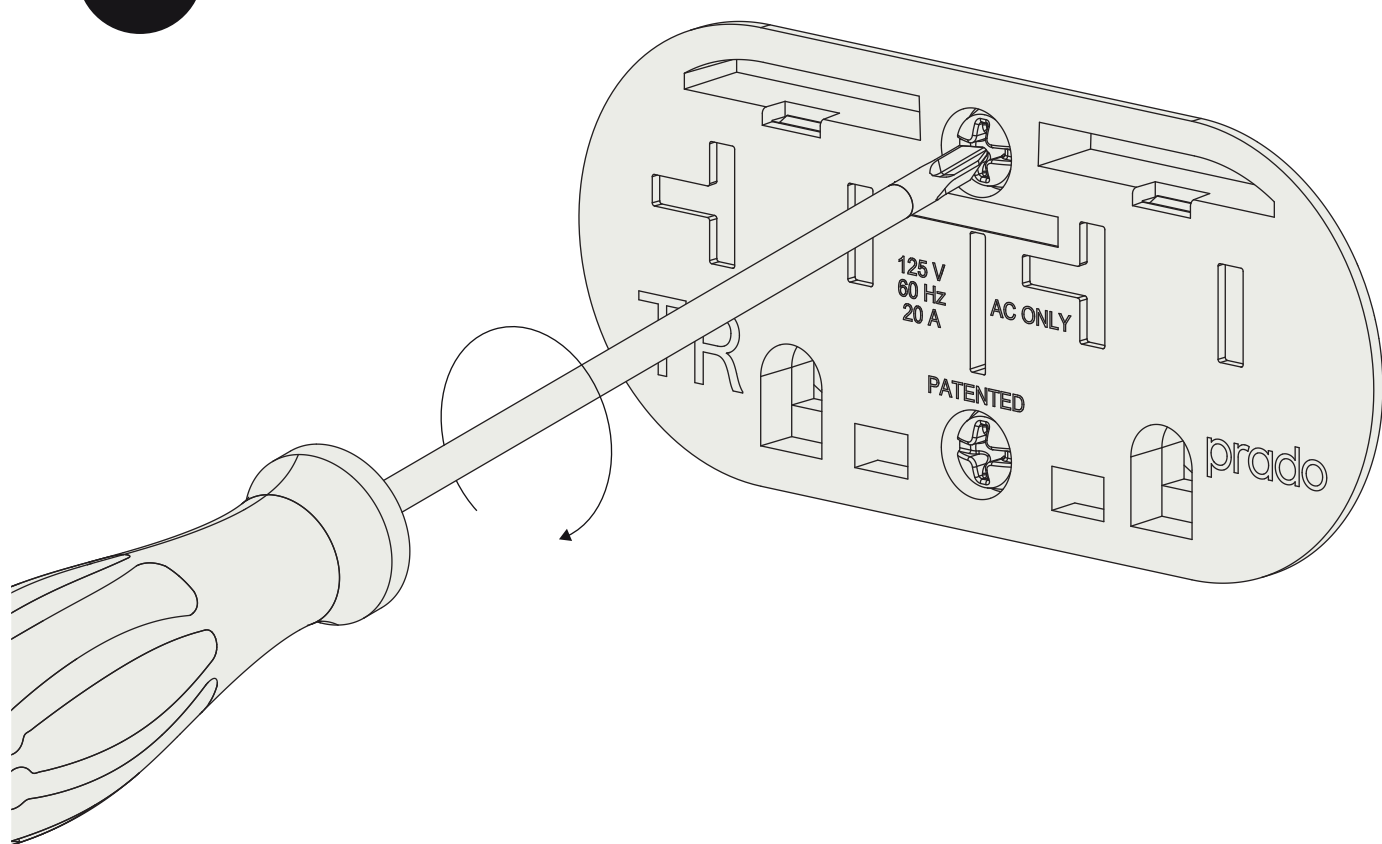

Fixate the outlet by tightning the screws.

16

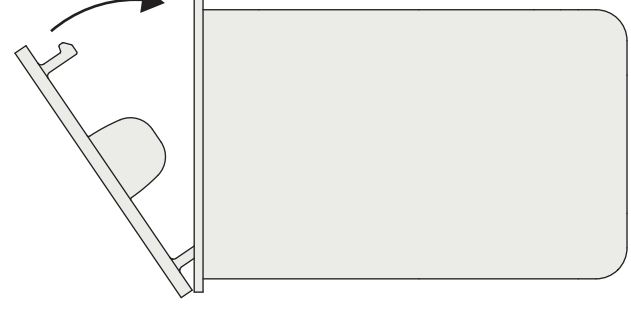
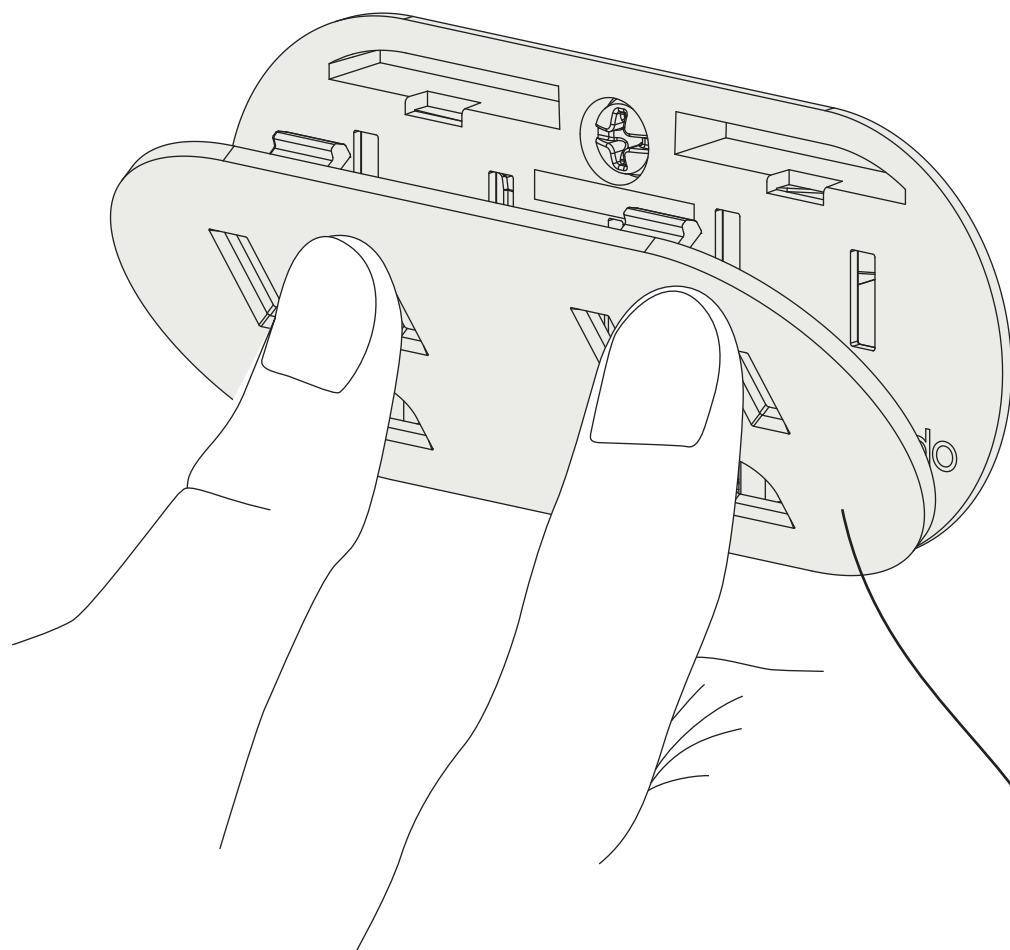

finish	SKU - 15A	SKU - 20A
black	9000-0062	9000-0063
white	9000-0064	9000-0065
sand	9000-0066	9000-0067
clay	9000-0068	9000-0069

17

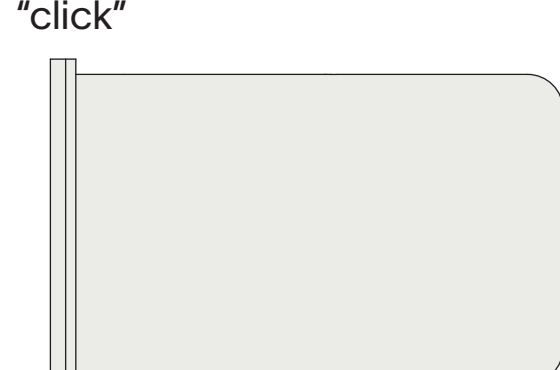
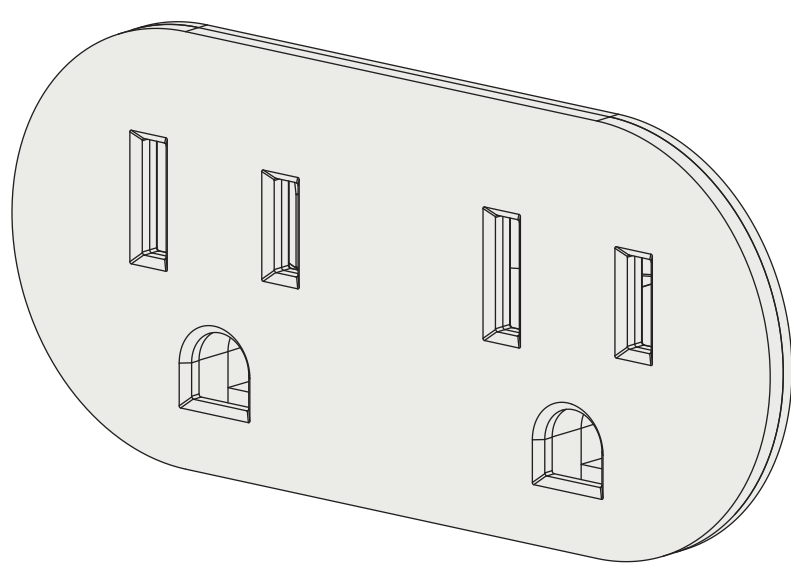

Install the cover plate.

18

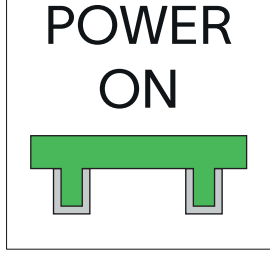
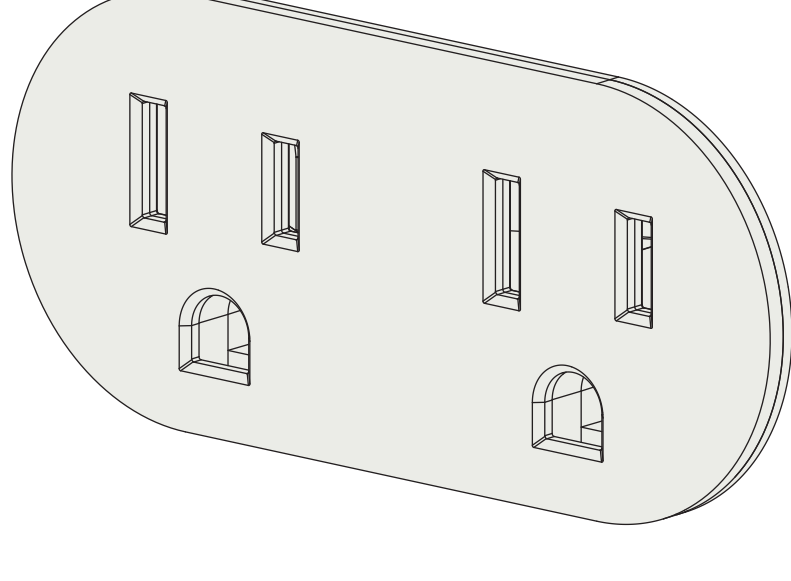

Turn the power on.

for removal

19

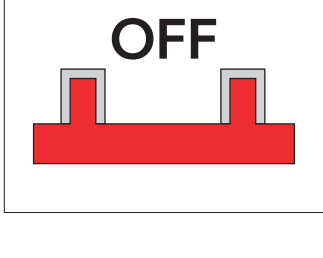
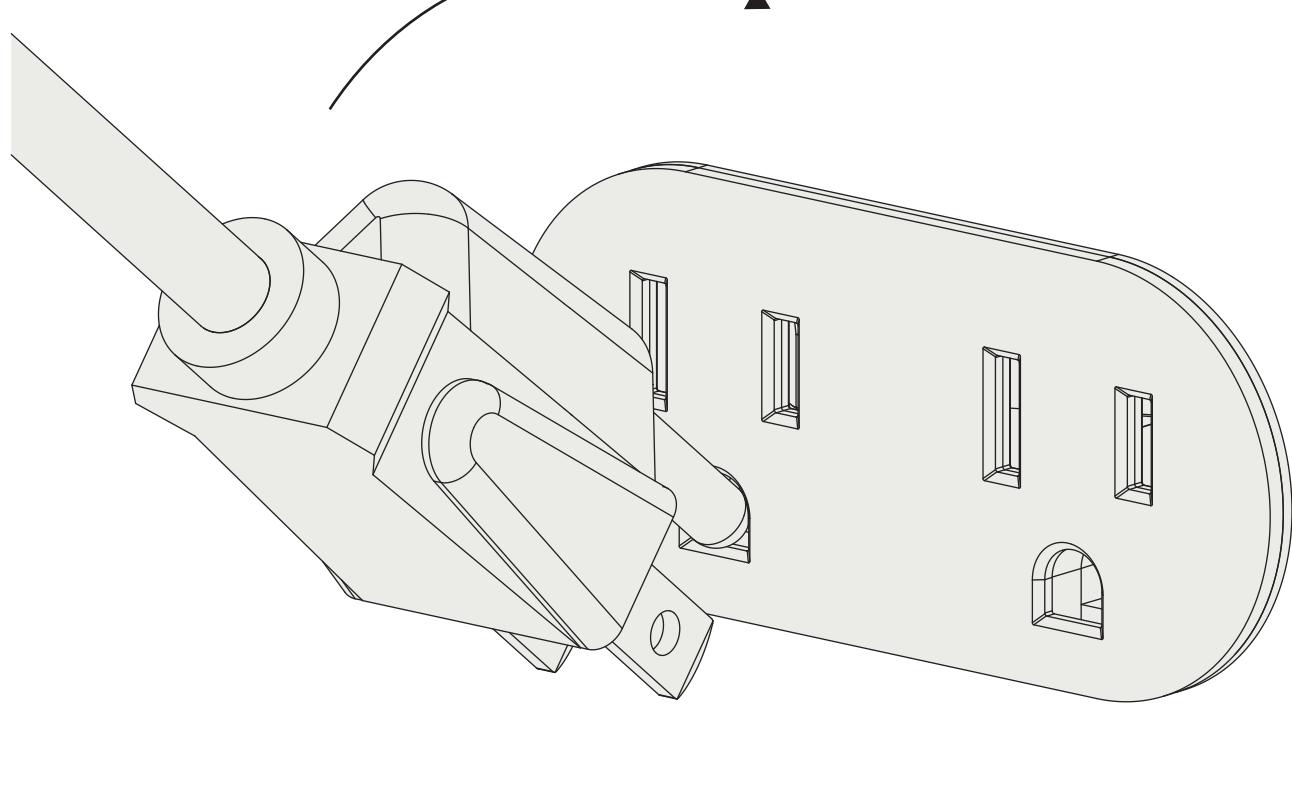

Turn the power off before removing the outlet.

20

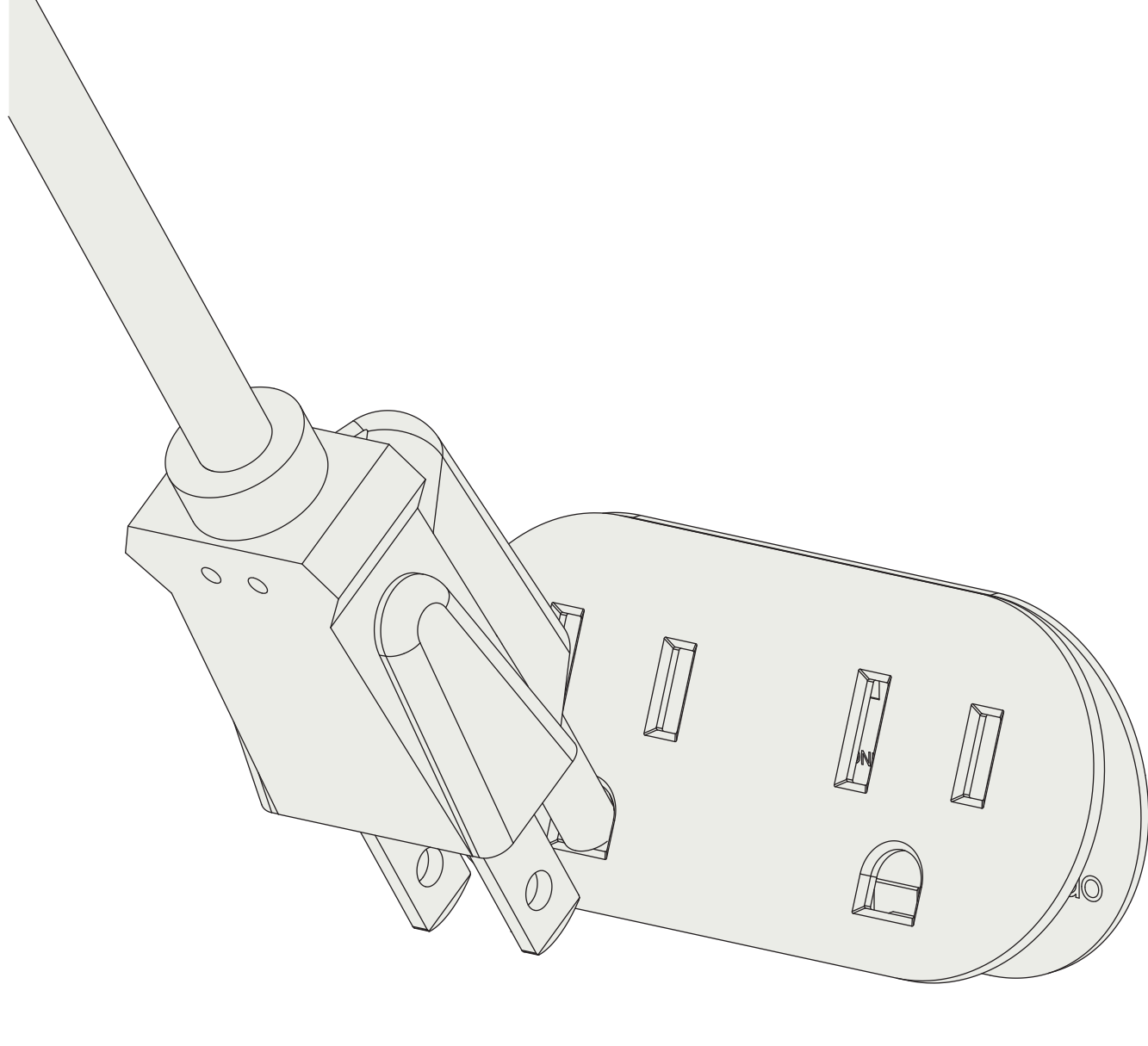

Click off the cover plate using a plug.

21

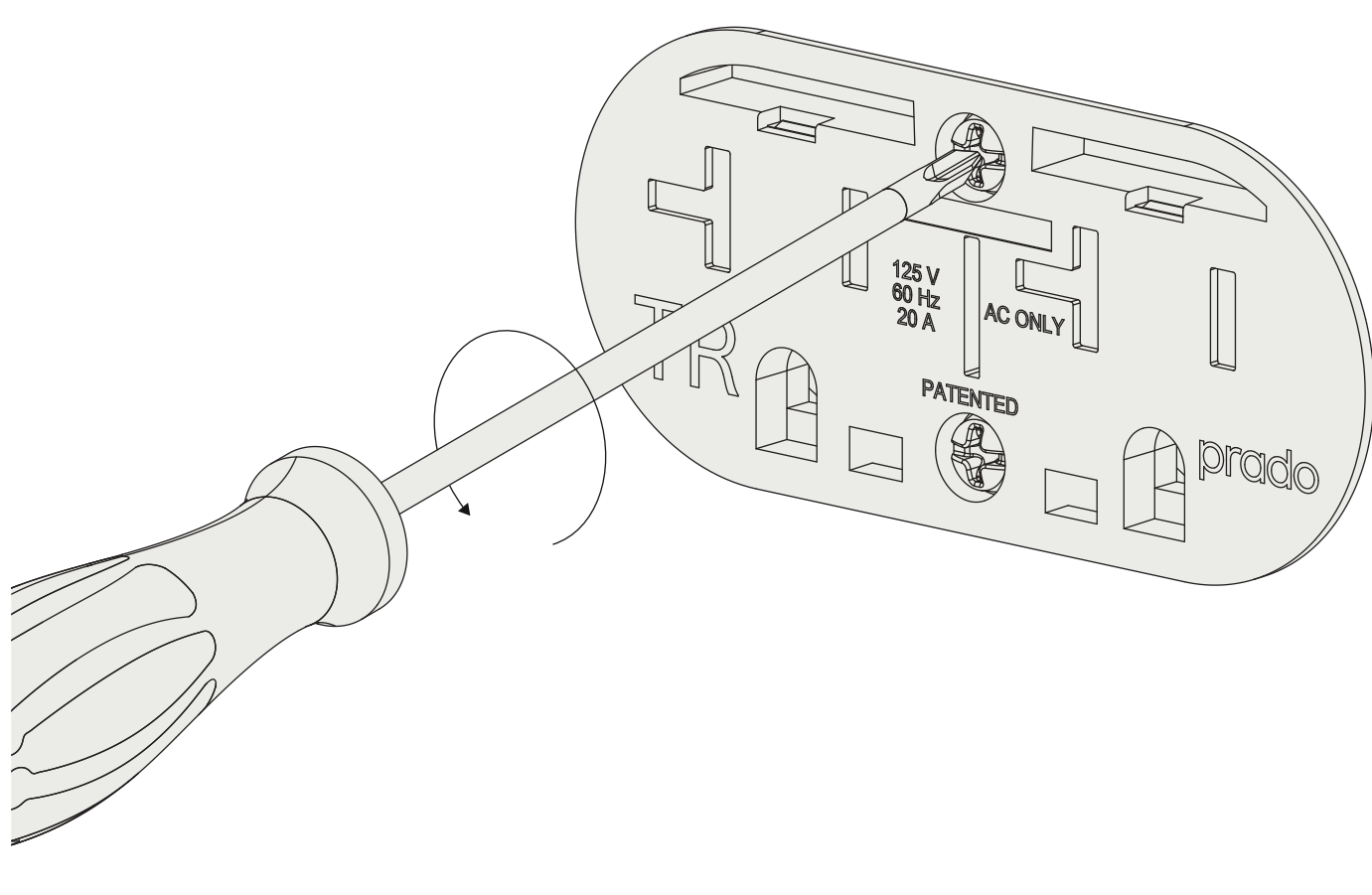

Loosen the screws.

22

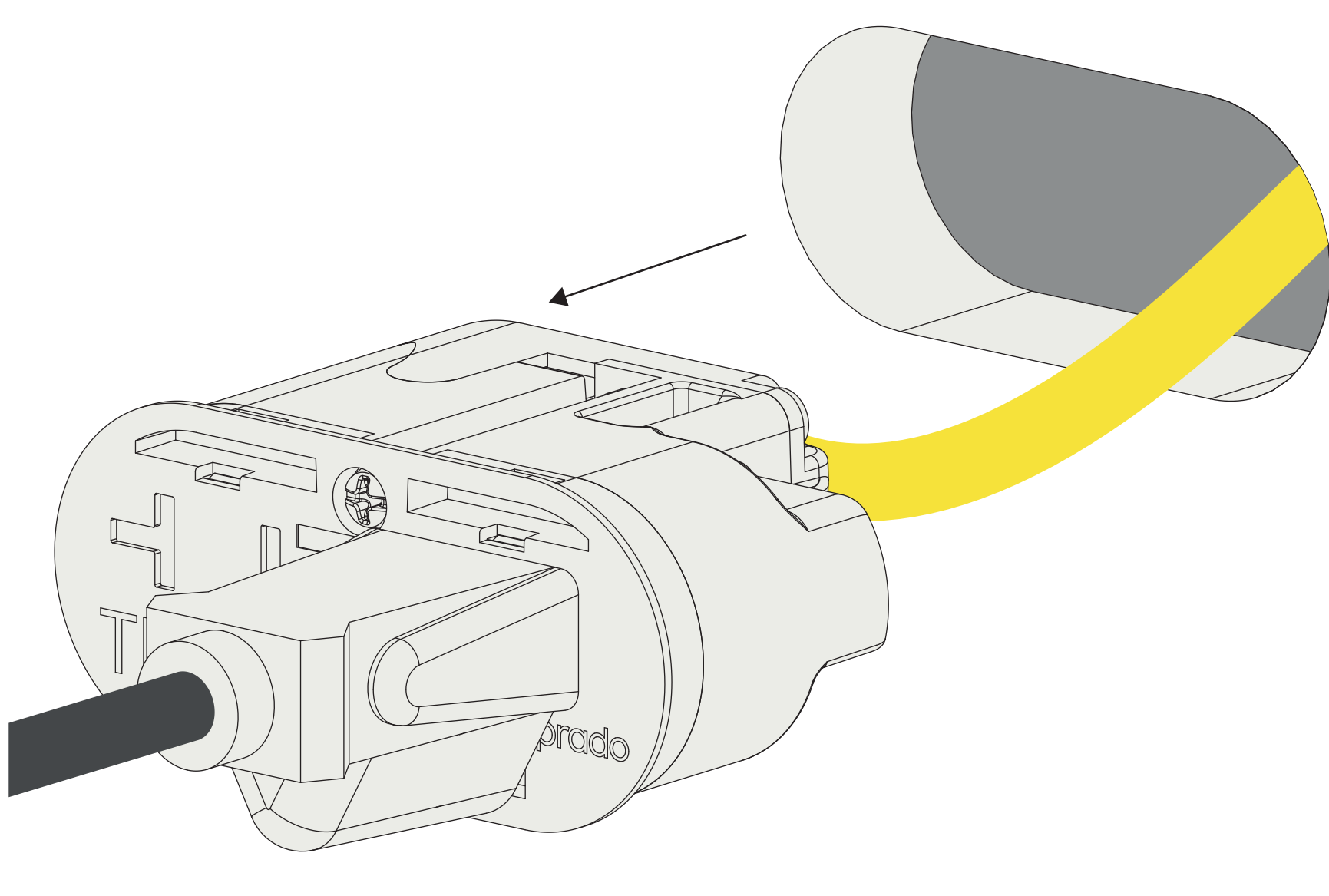

Remove the outlet by using a plug.

Thank you for choosing prado.



Intertek
5029983

CONFORMS TO UL STD. 498
CERTIFIED TO CSA STD. C22.2#42

prado.com

support@prado.com - Prado America LLC

Installation must be done by skilled professionals only and instructions must be followed at all times. Warranty will not apply in case of wrongful use of if unskilled personnel attempts to repair a product.