

## trim spot

## installation instruction

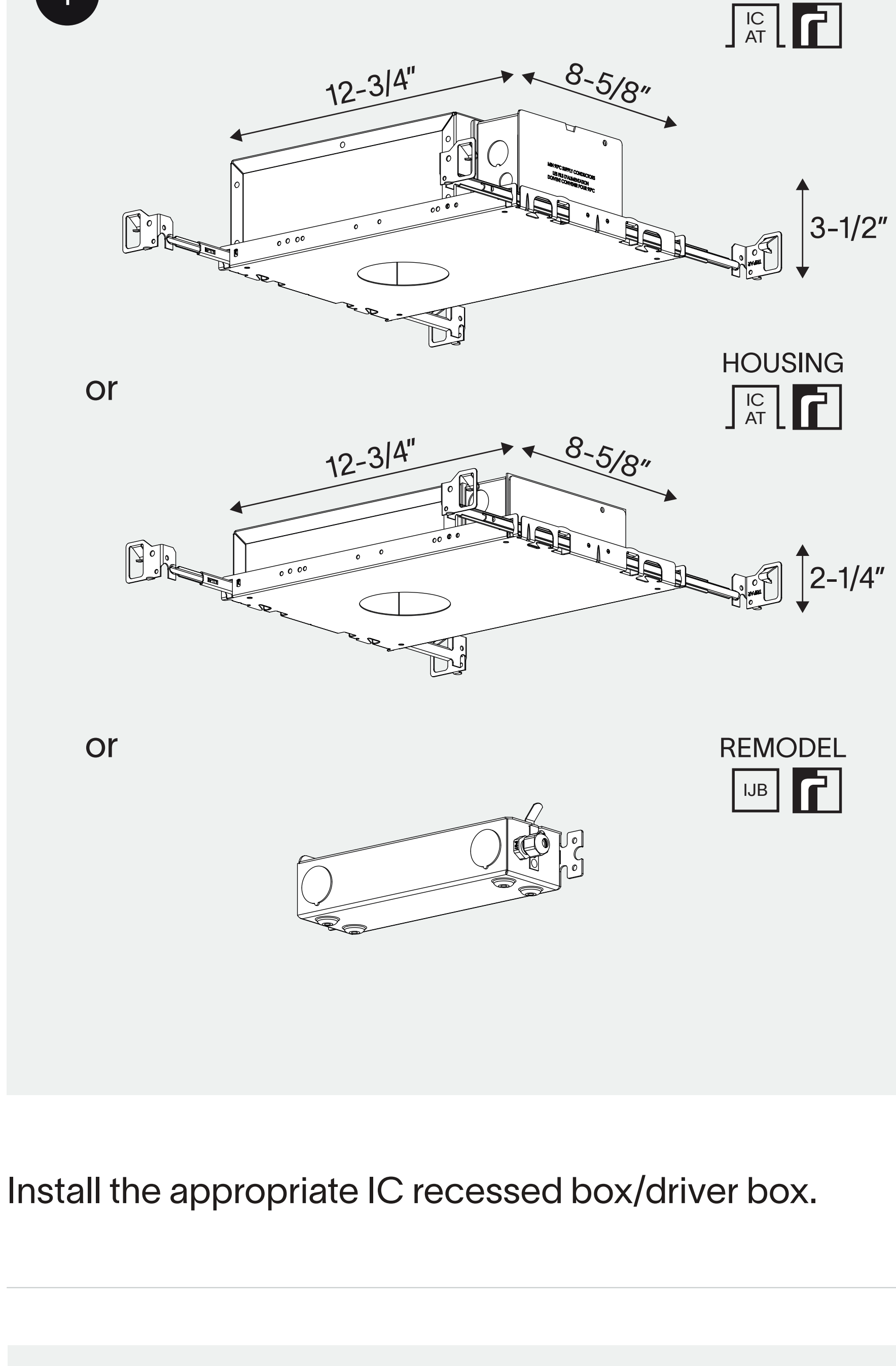

Install the appropriate IC recessed box/driver box.

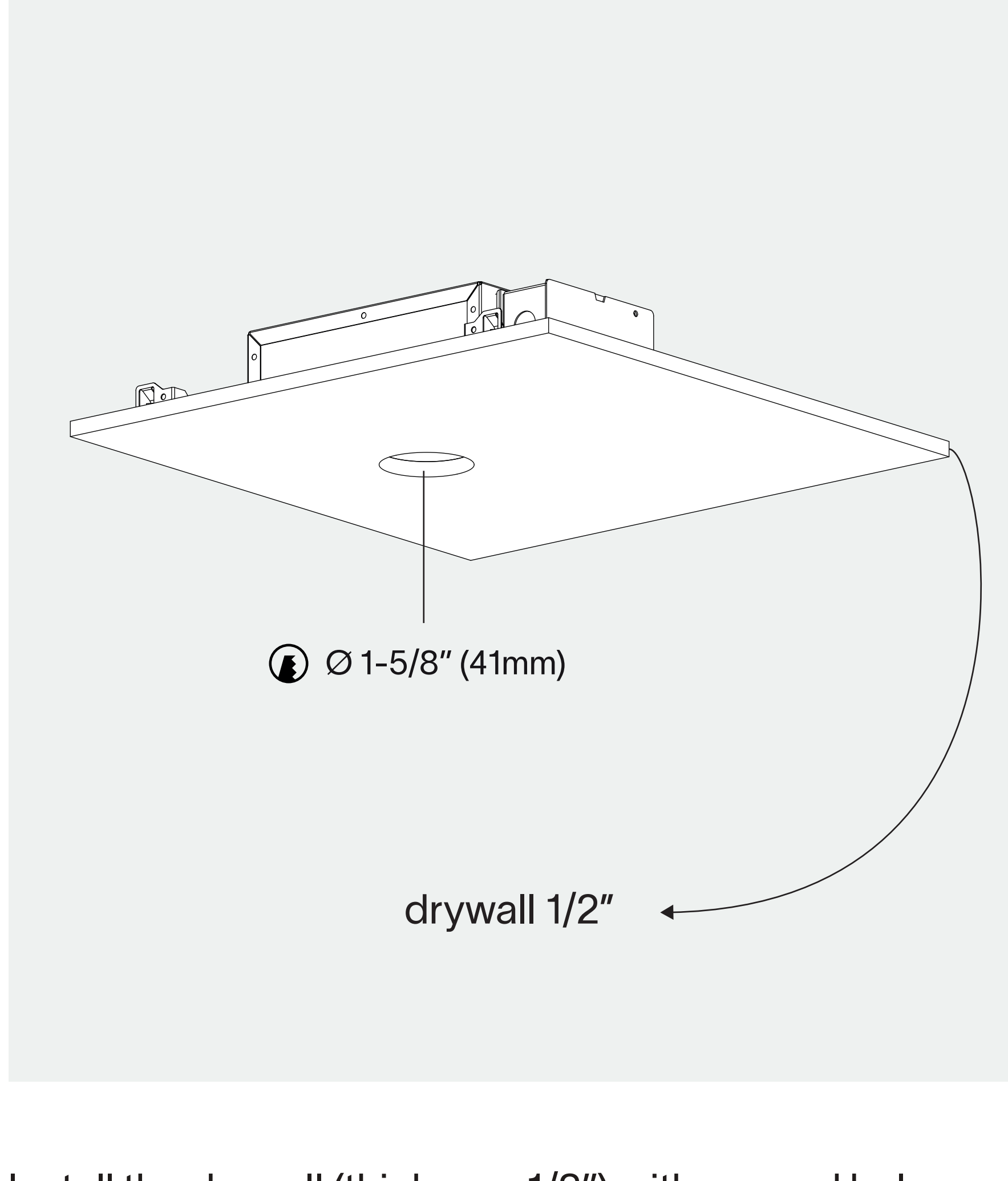

Install the drywall (thickness 1/2") with a round hole (Ø 1-5/8").

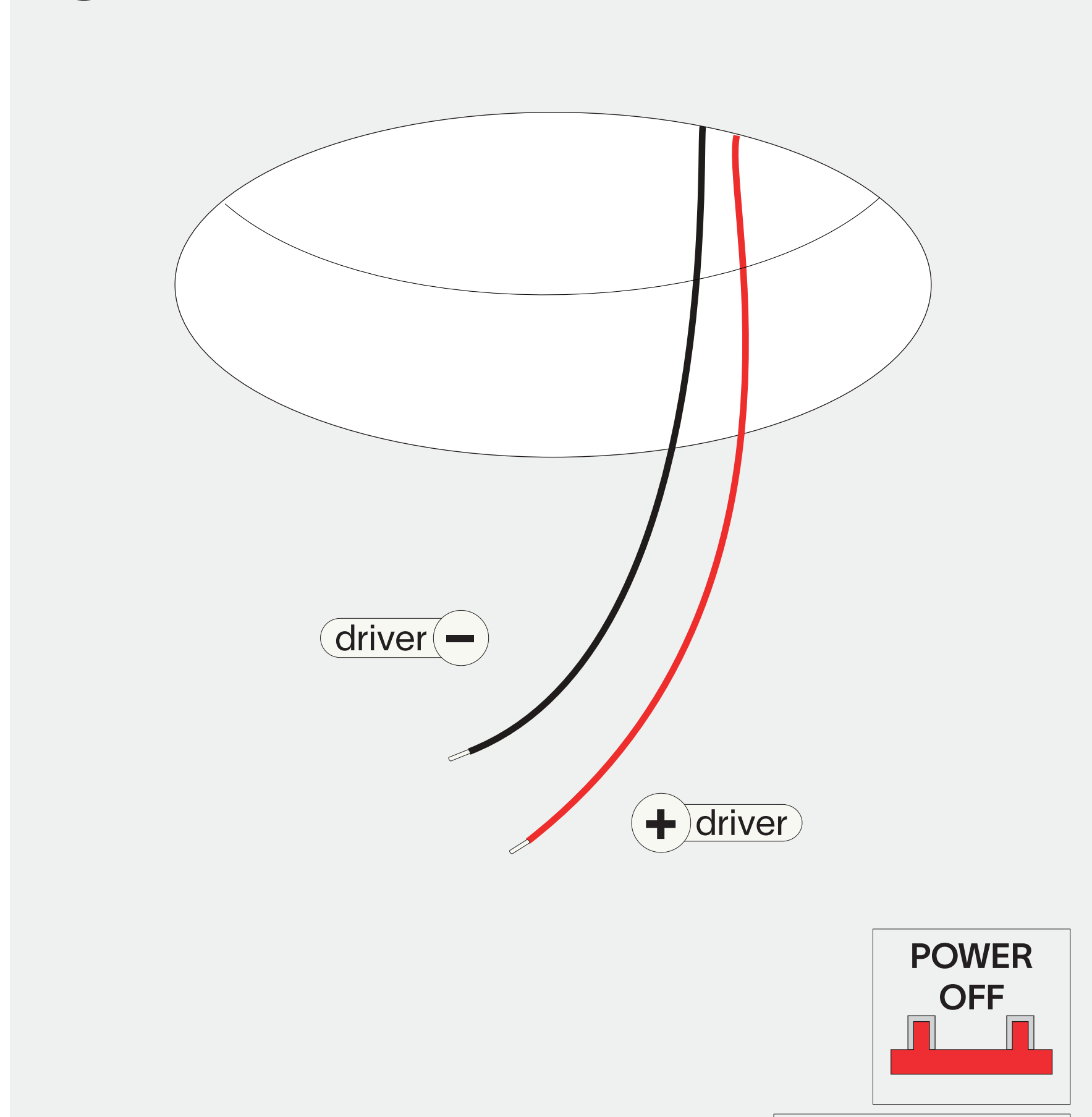

See packaging or fixture label for maximum current.

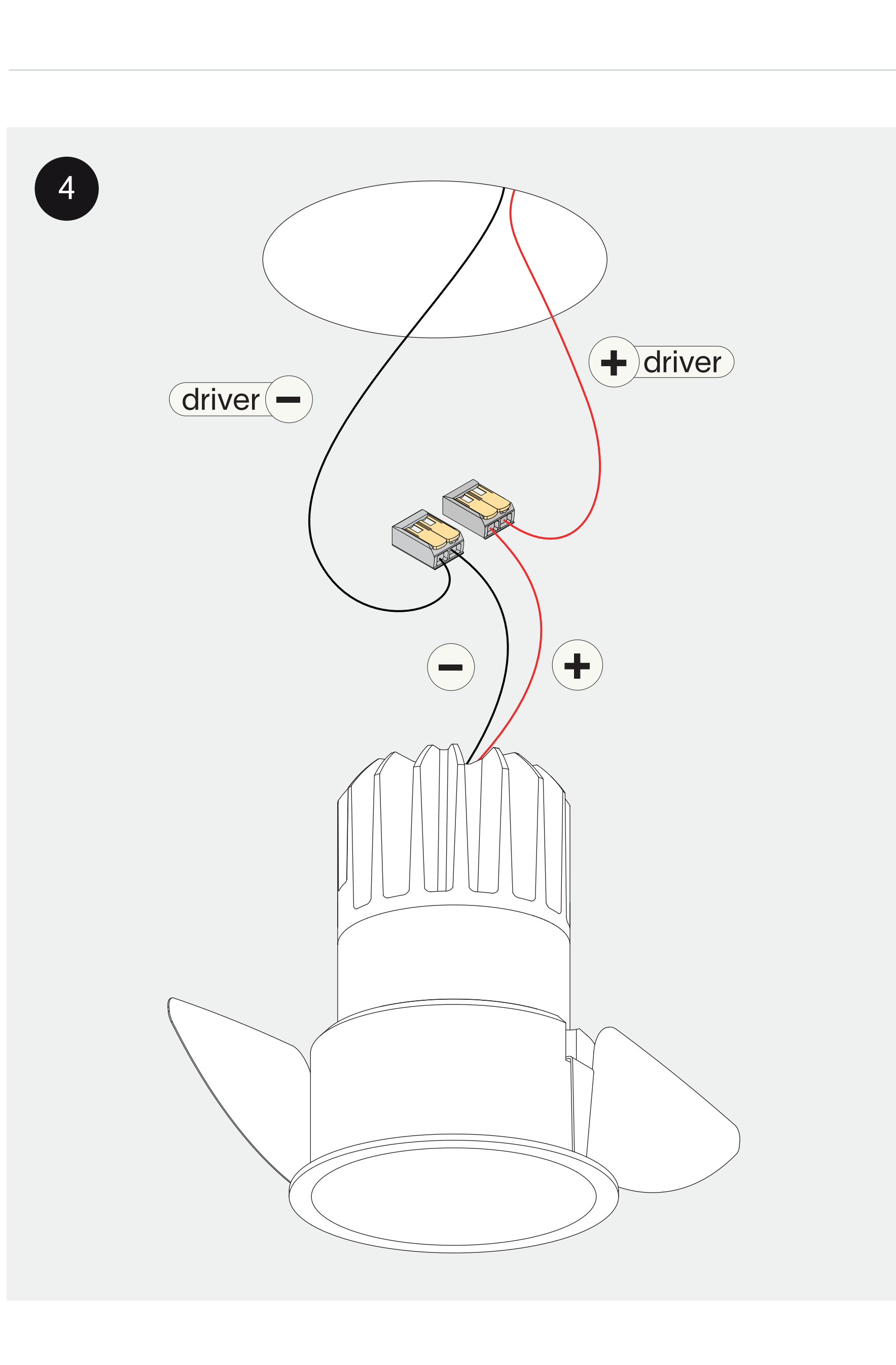

Connect the wires with wago connectors.

For serial connection, respect polarity.

Combine with a prado LED-driver.

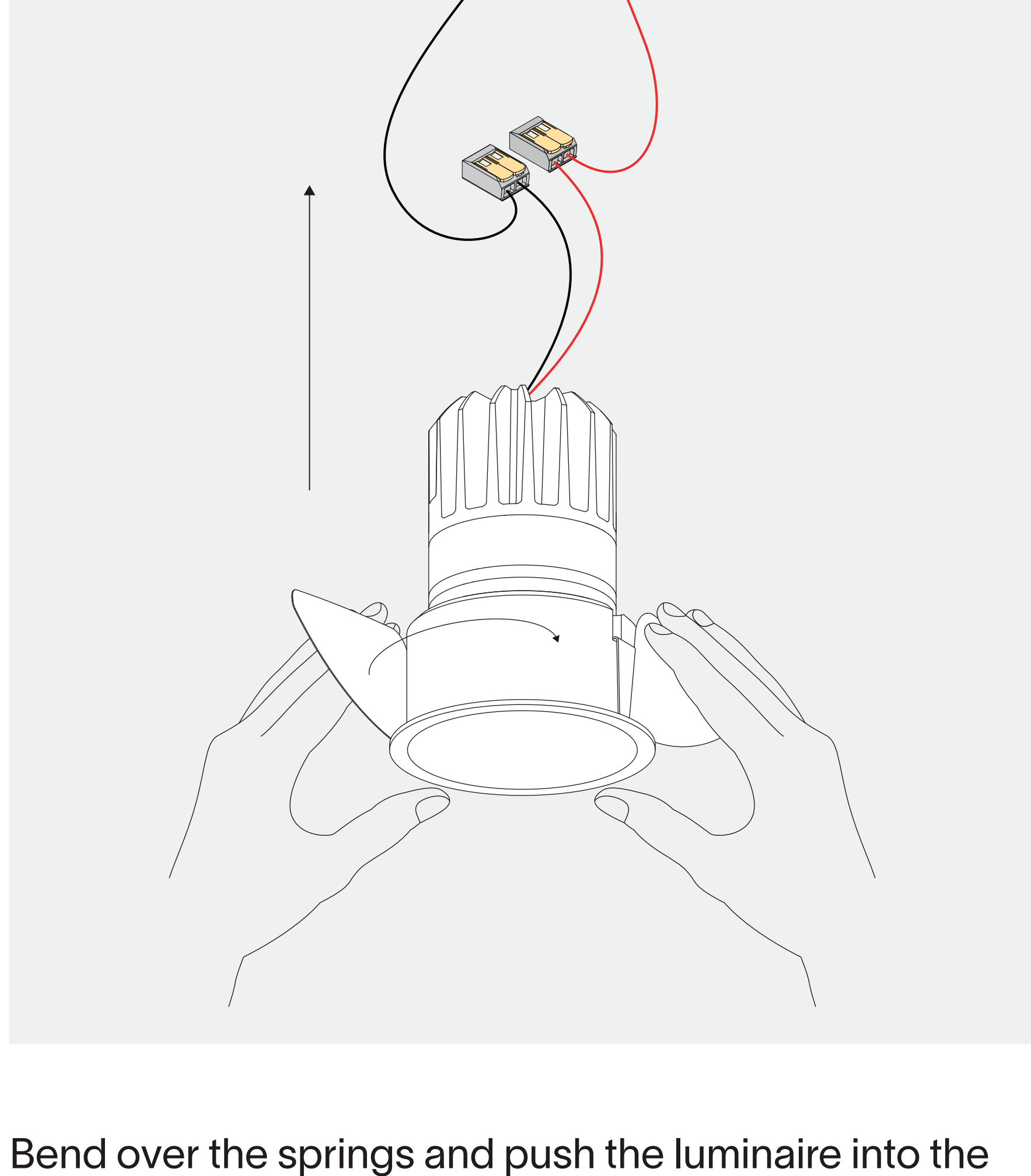

Bend over the springs and push the luminaire into the ceiling.

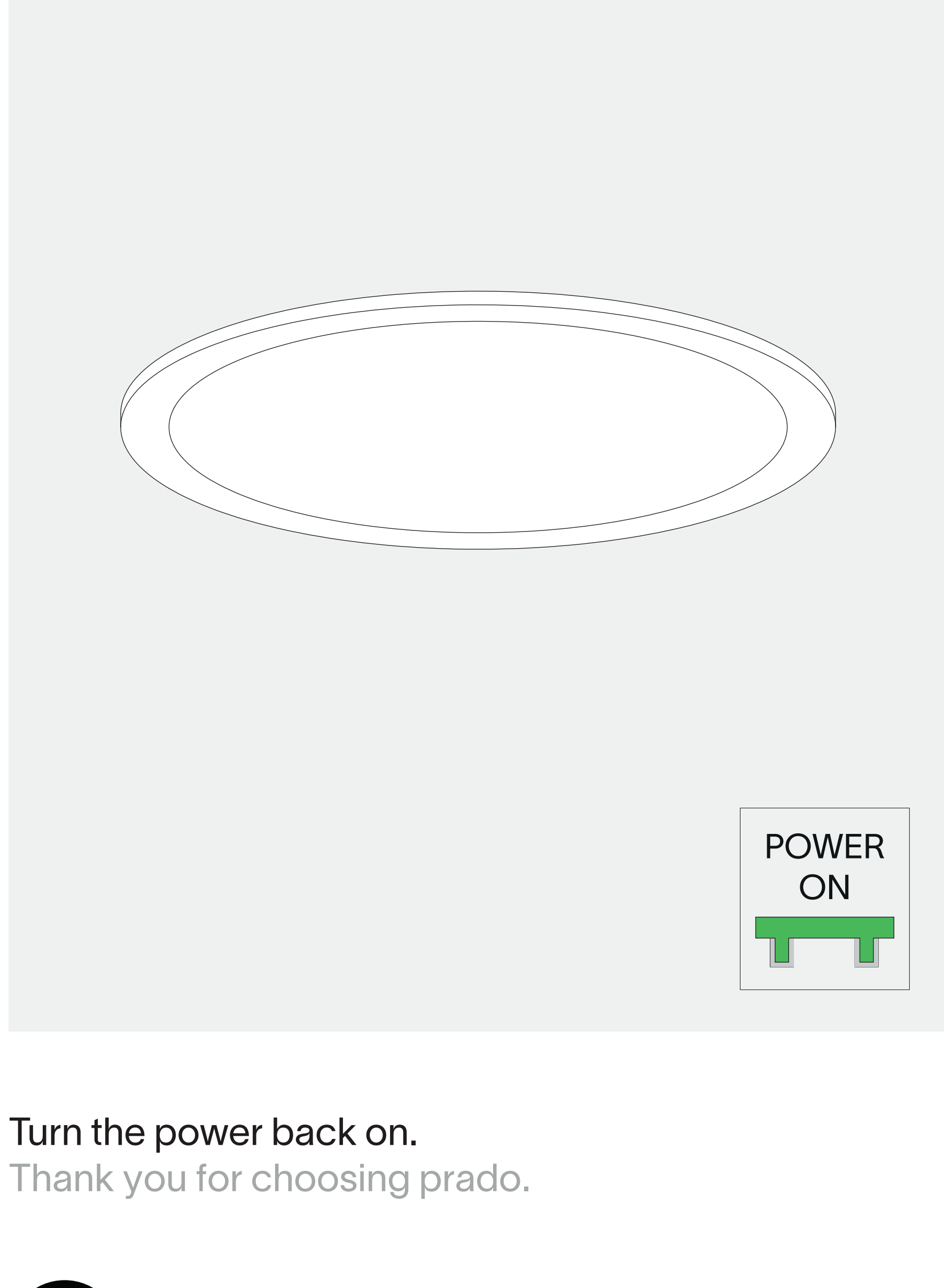

Turn the power back on.

Thank you for choosing prado.

