

# acrobat mini trim

## installation instruction

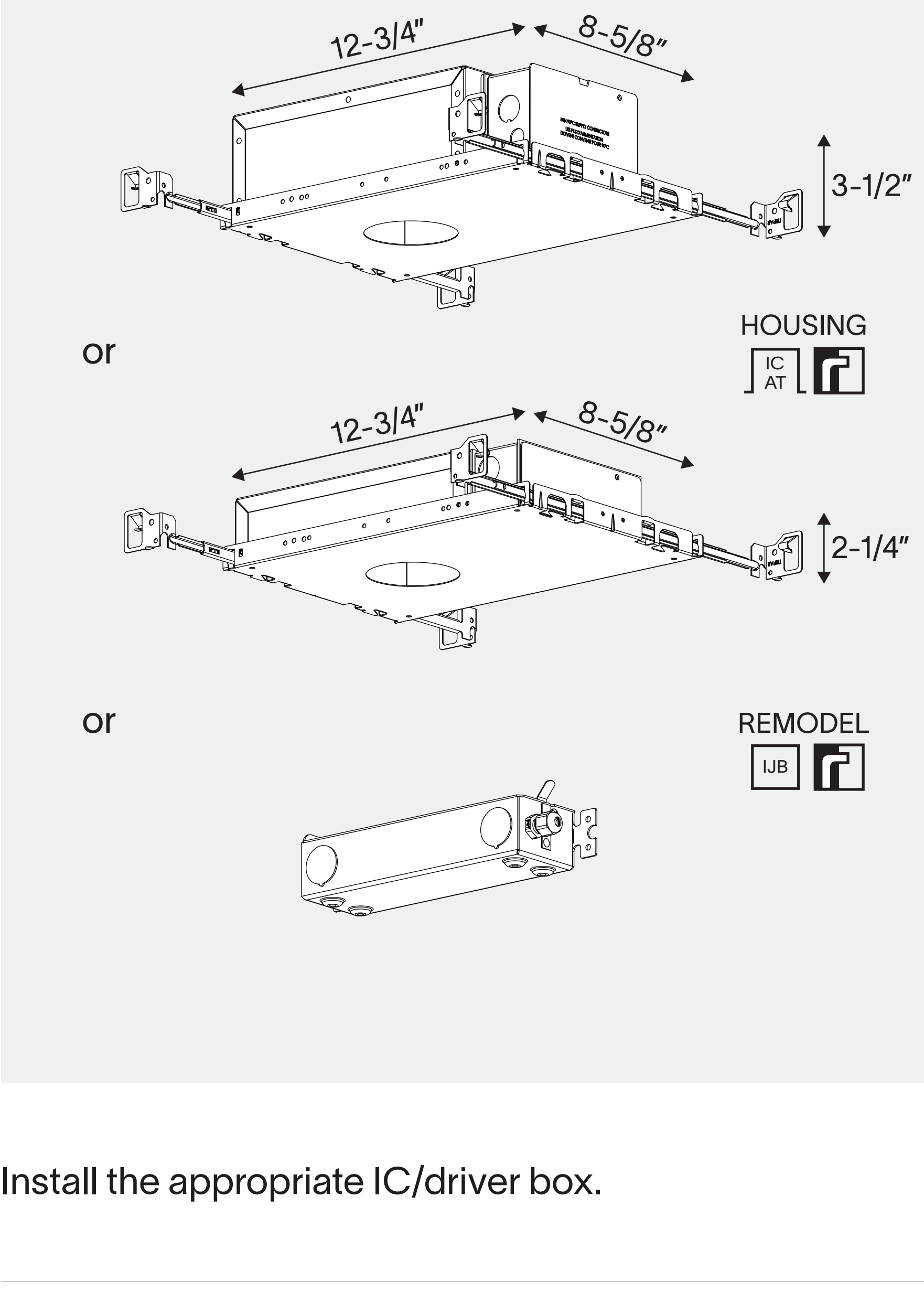

Install the appropriate IC/driver box.

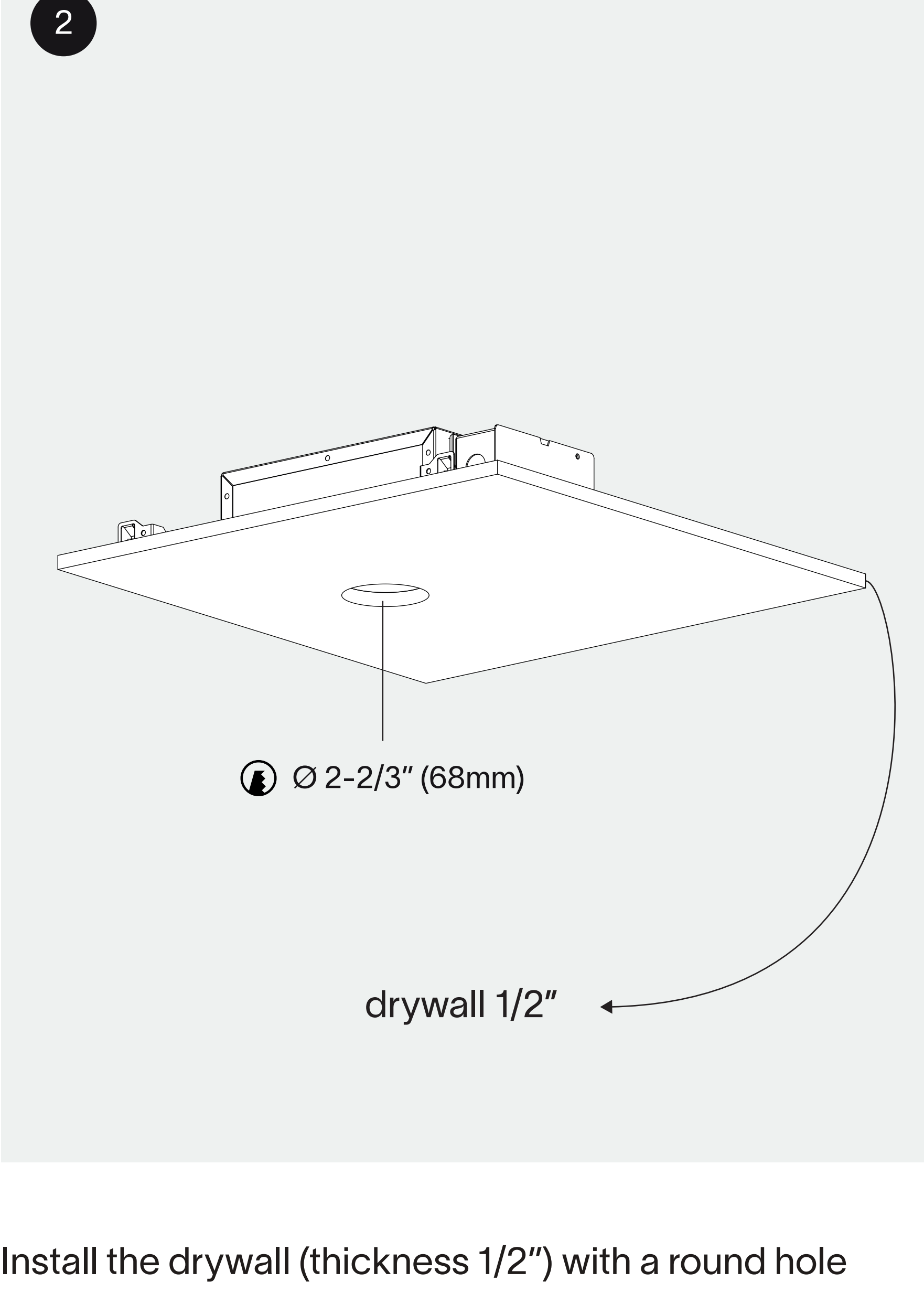

Install the drywall (thickness 1/2") with a round hole (Ø 2-2/3").

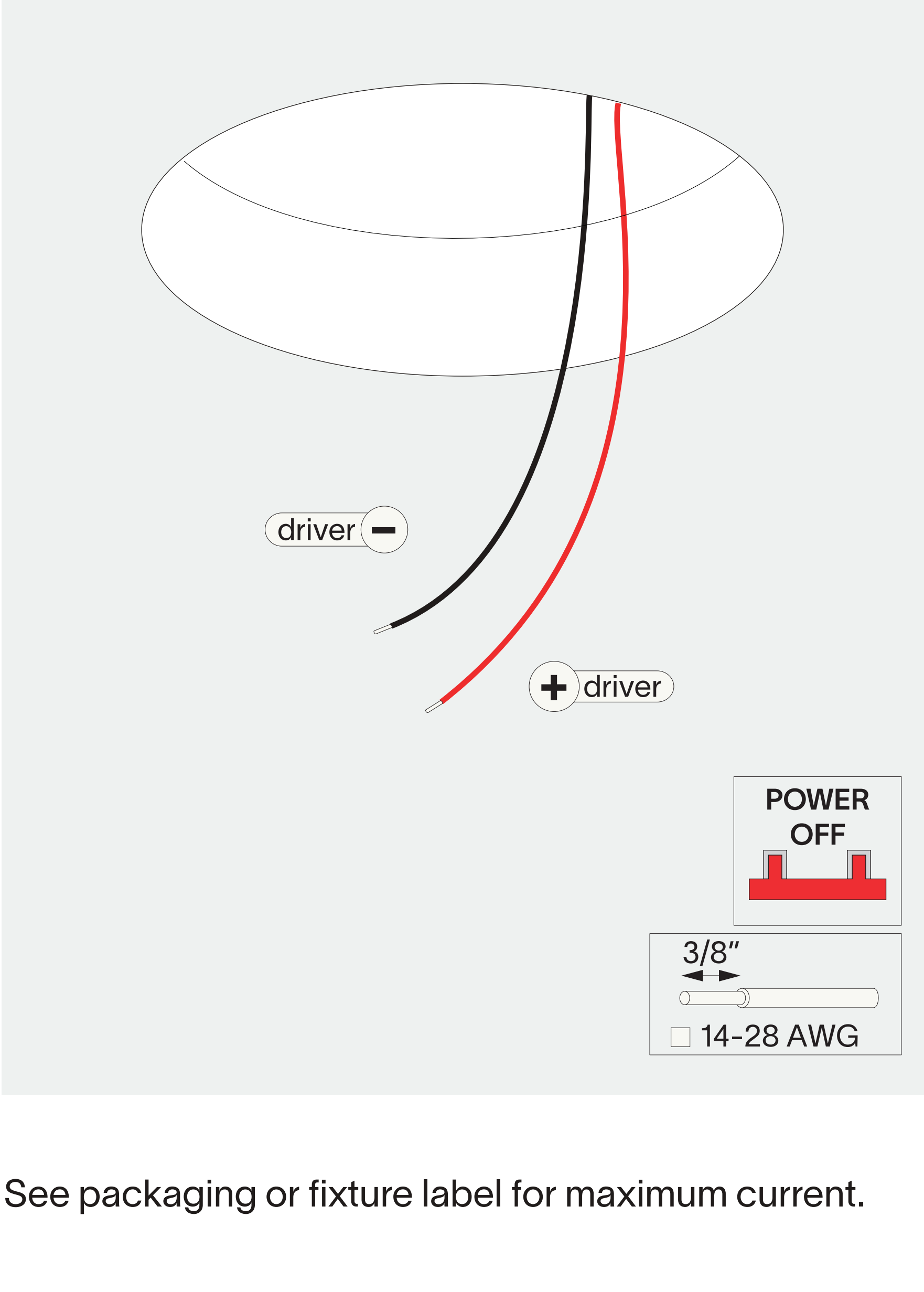

See packaging or fixture label for maximum current.

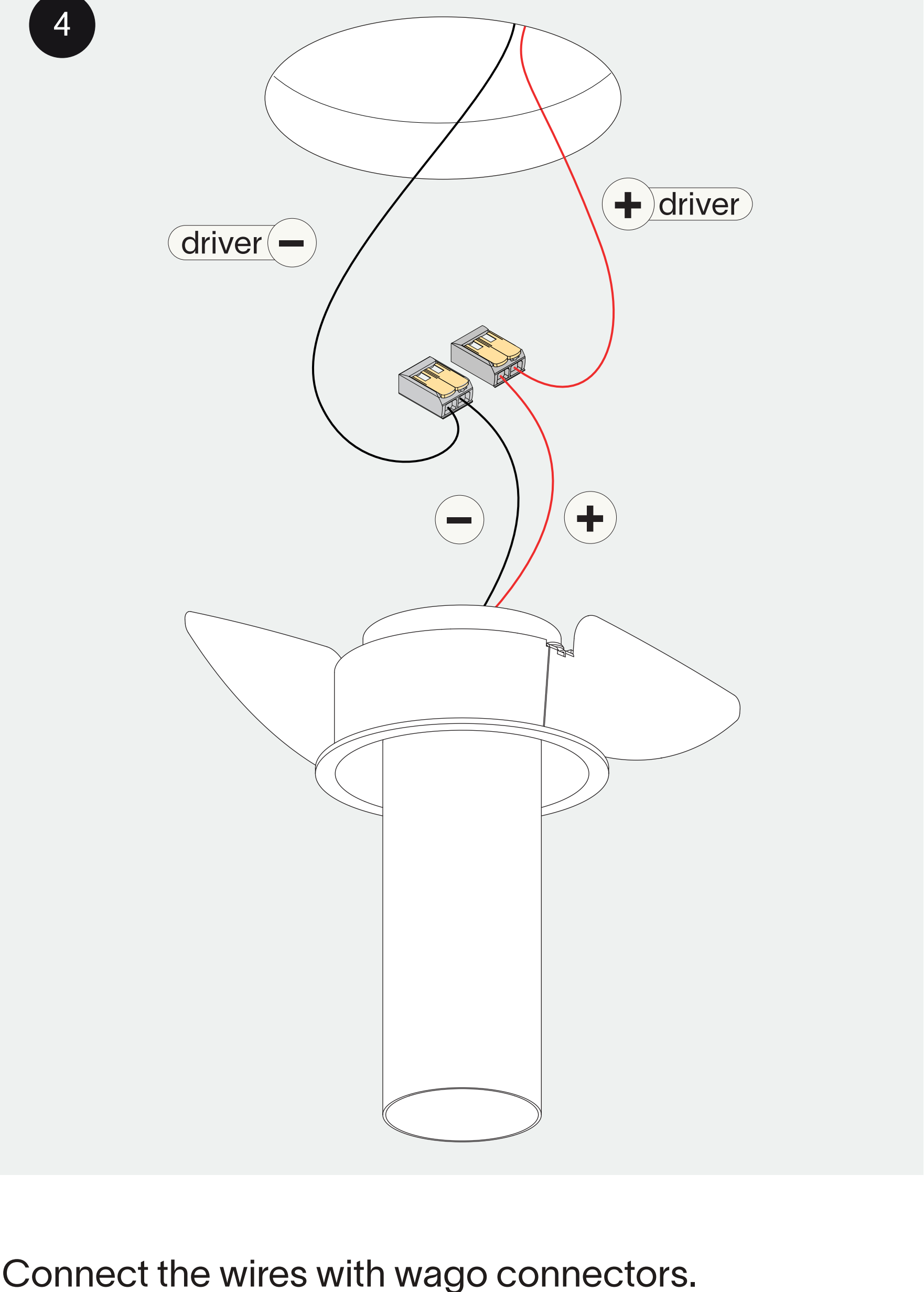

Connect the wires with wago connectors.  
For serial connection, respect polarity.  
Combine with a prado LED-driver.

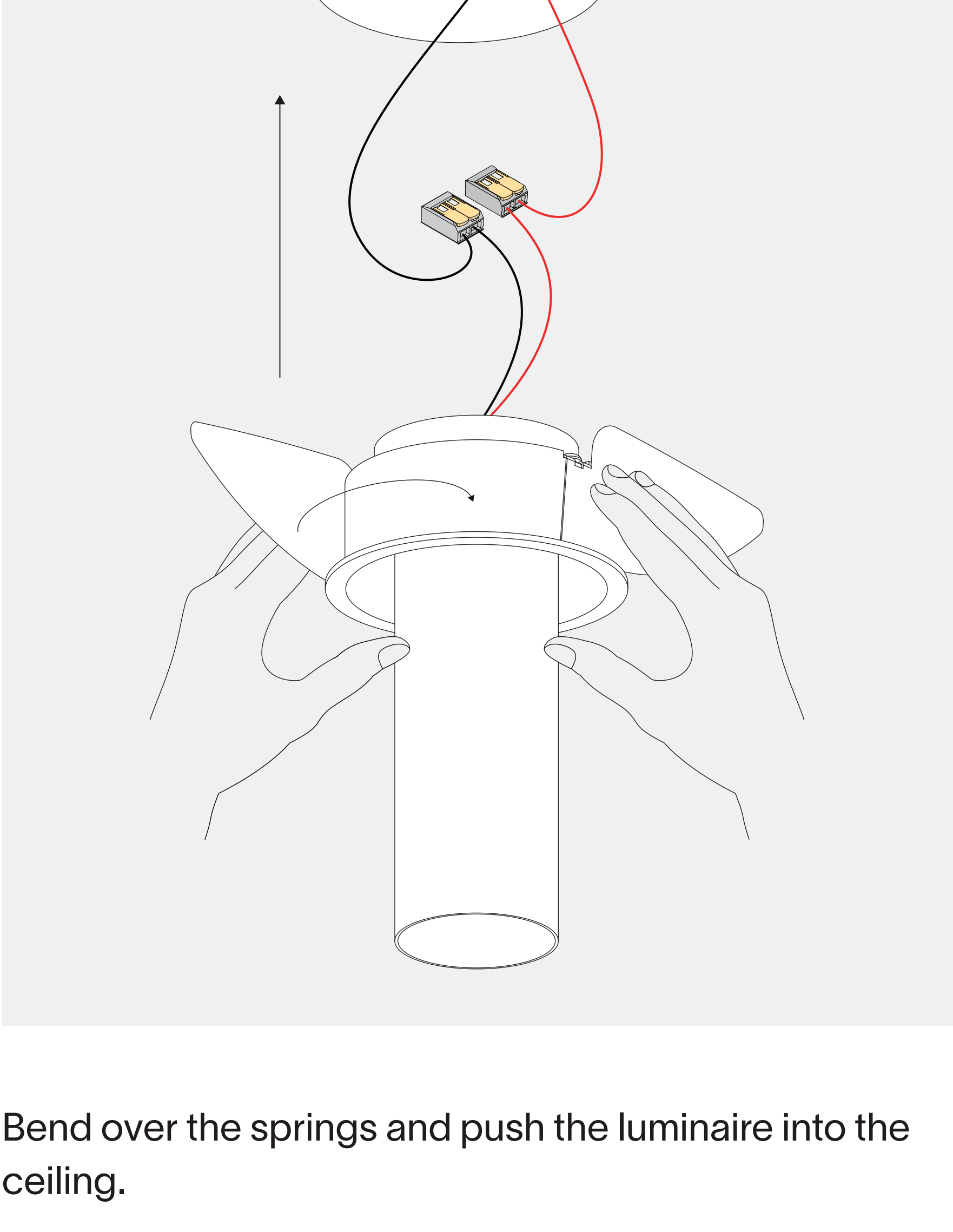

Bend over the springs and push the luminaire into the ceiling.

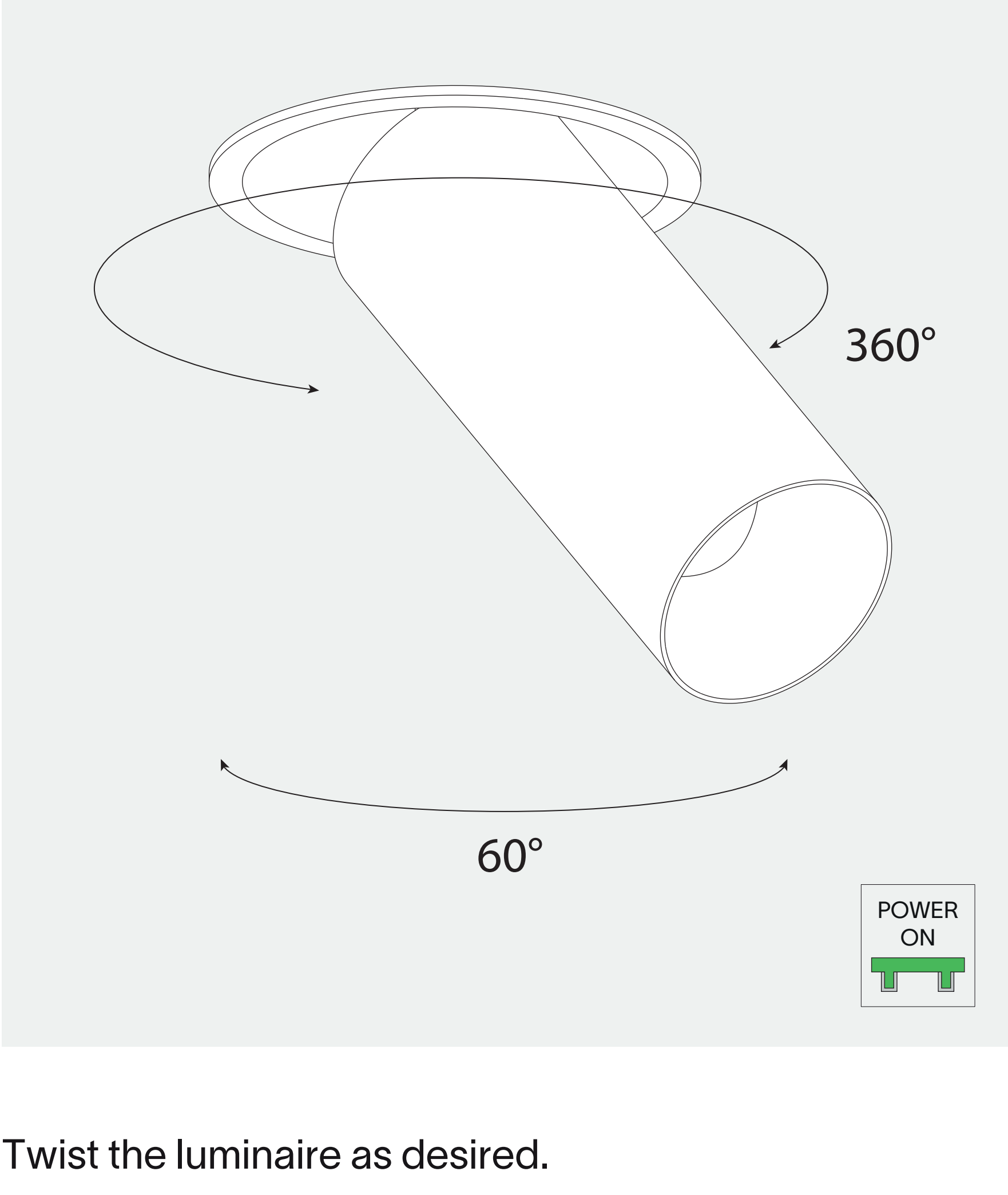

Twist the luminaire as desired.  
Thank you for choosing prado.