

clt ring jack

installation instruction

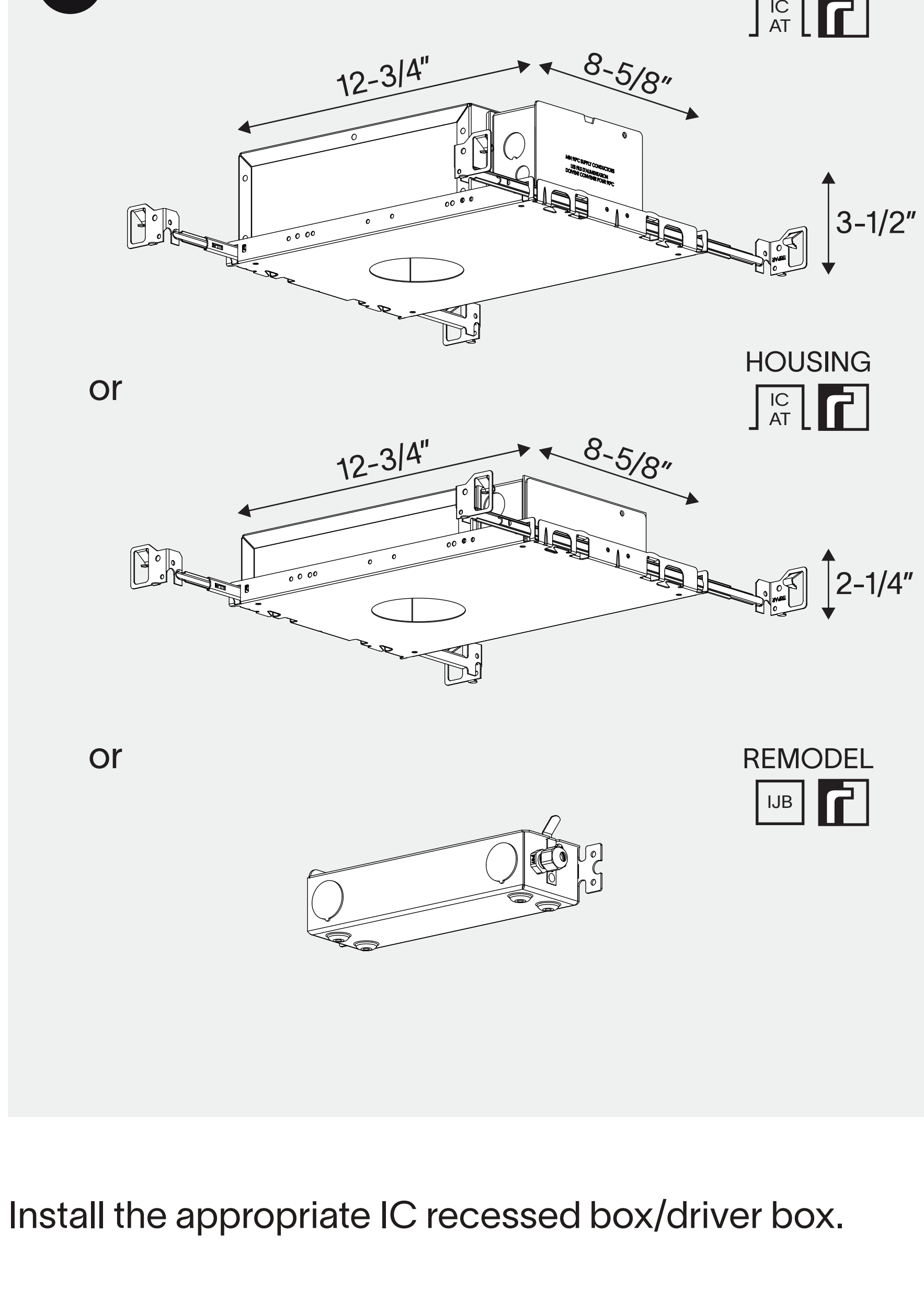

Install the appropriate IC recessed box/driver box.

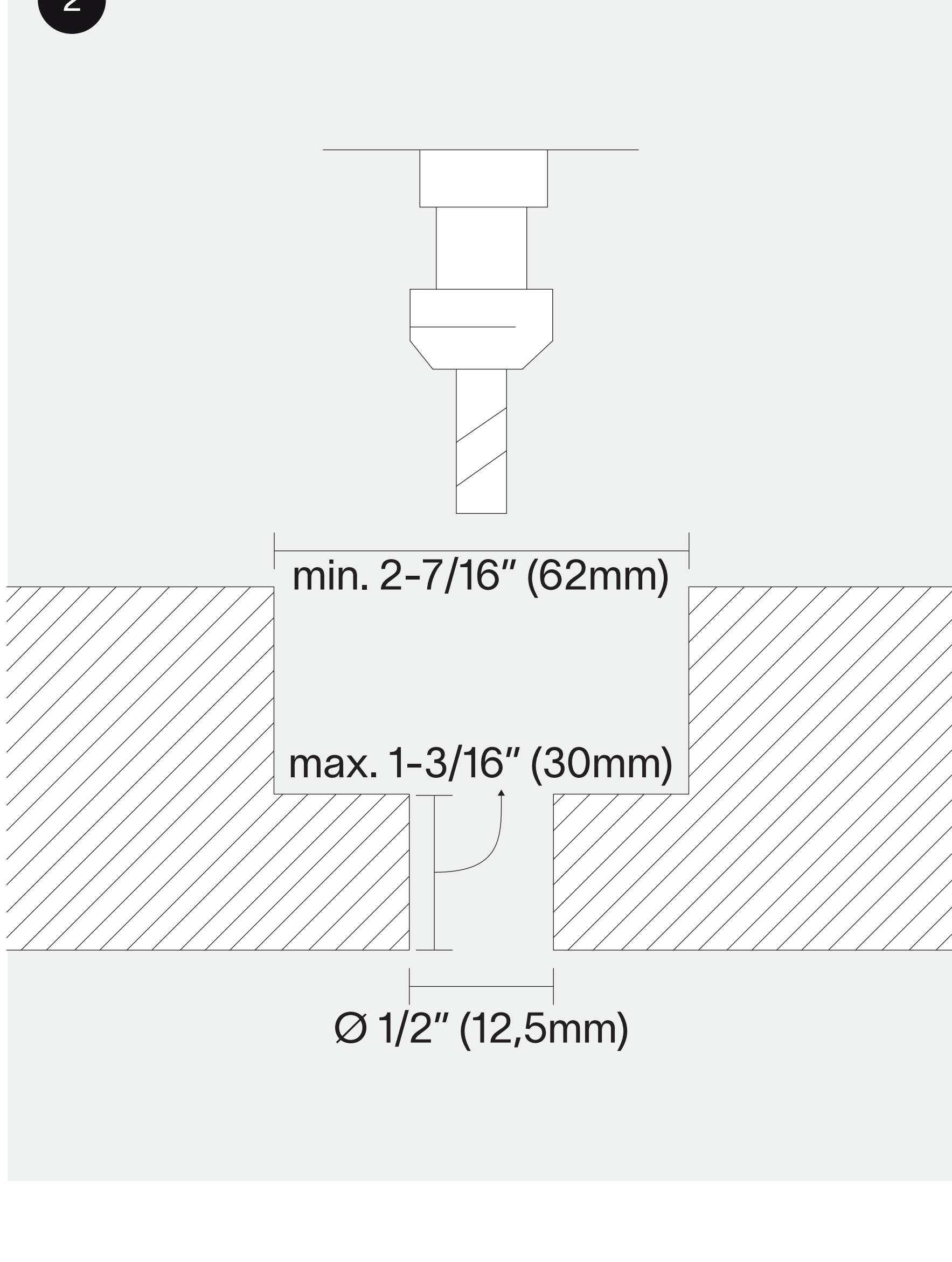

Drill a round hole with the above dimensions.

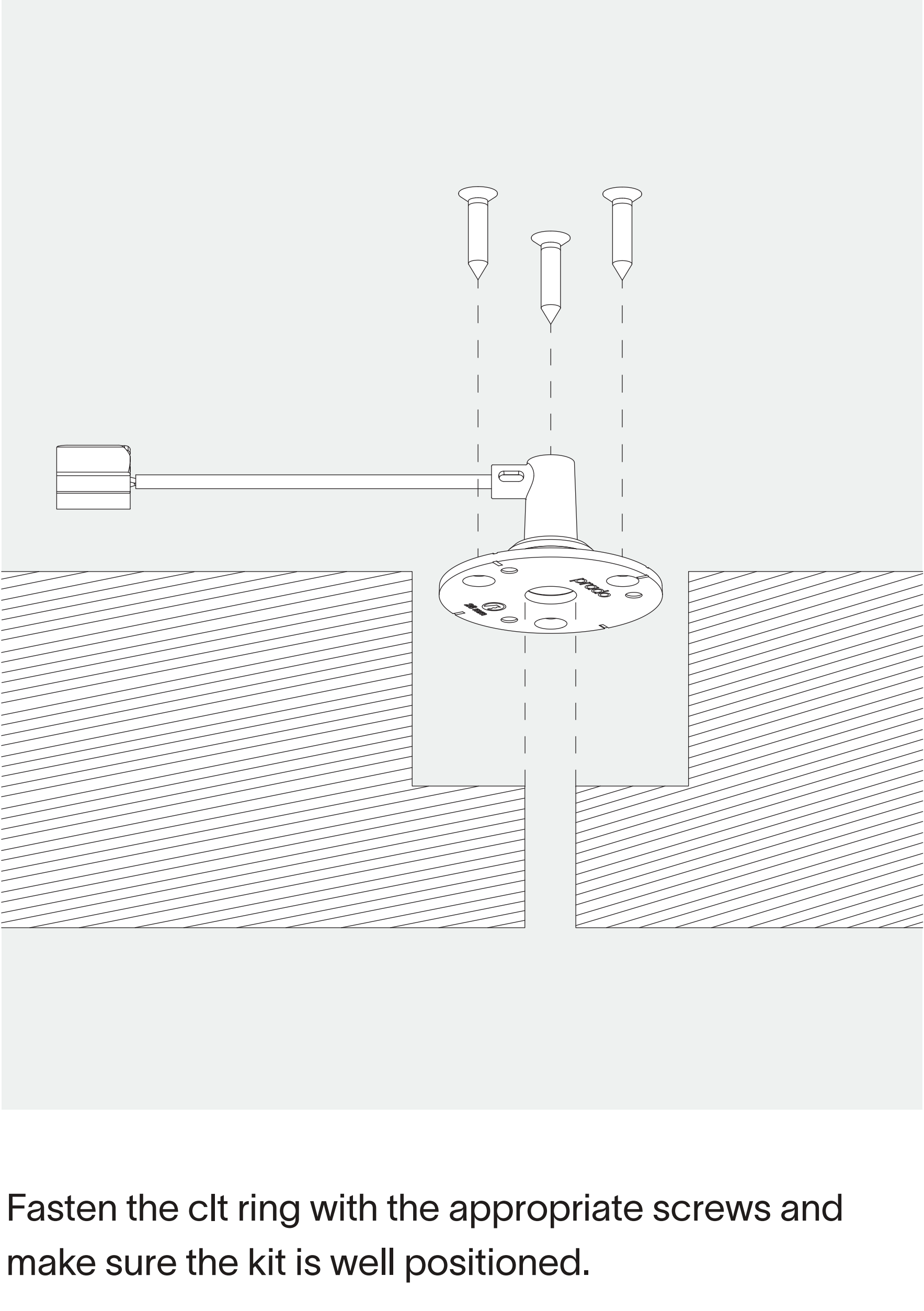

Fasten the clt ring with the appropriate screws and make sure the kit is well positioned.

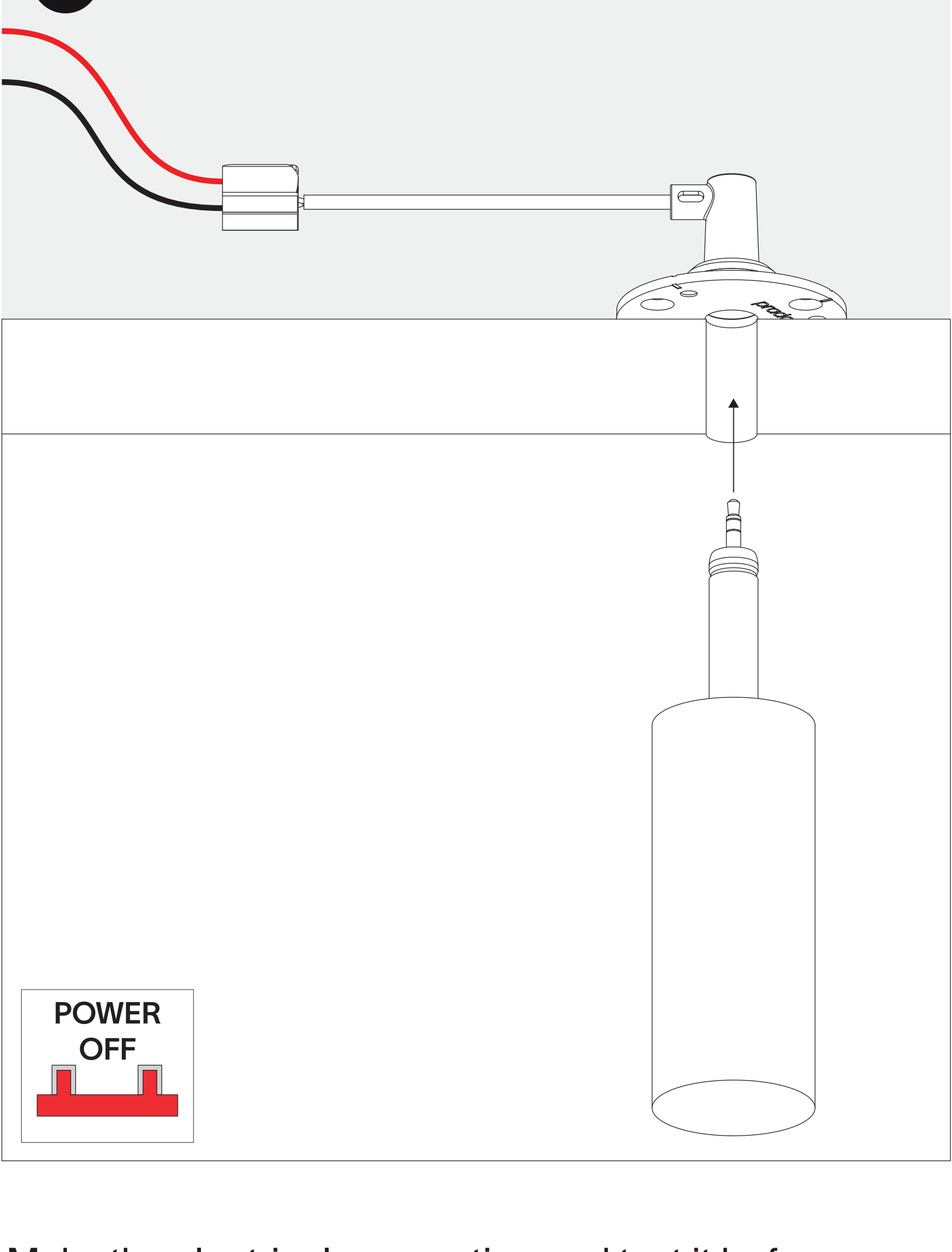

Make the electrical connection and test it before closing the ceiling. Do not plug or unplug the fixture while power is on.

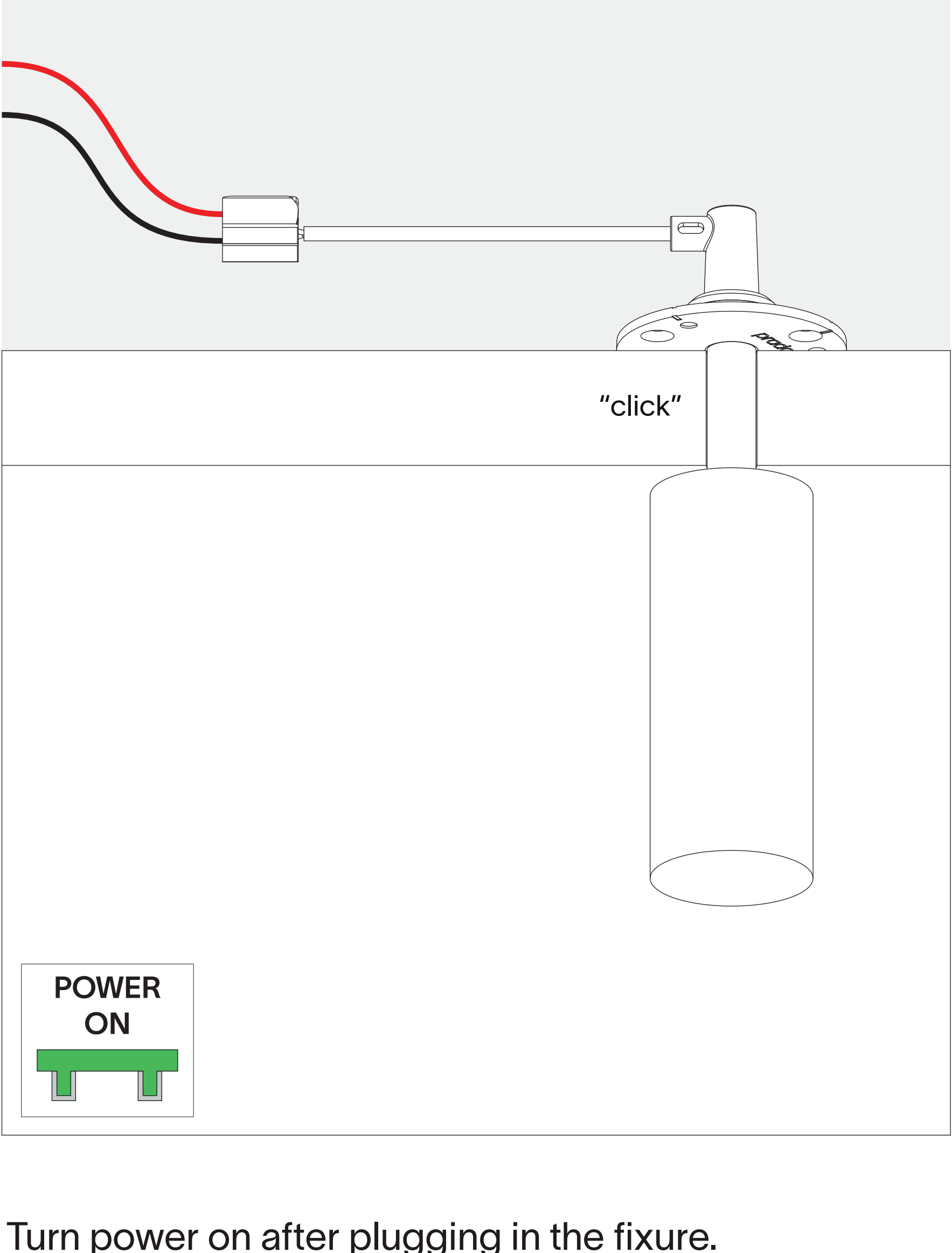

Turn power on after plugging in the fixture.

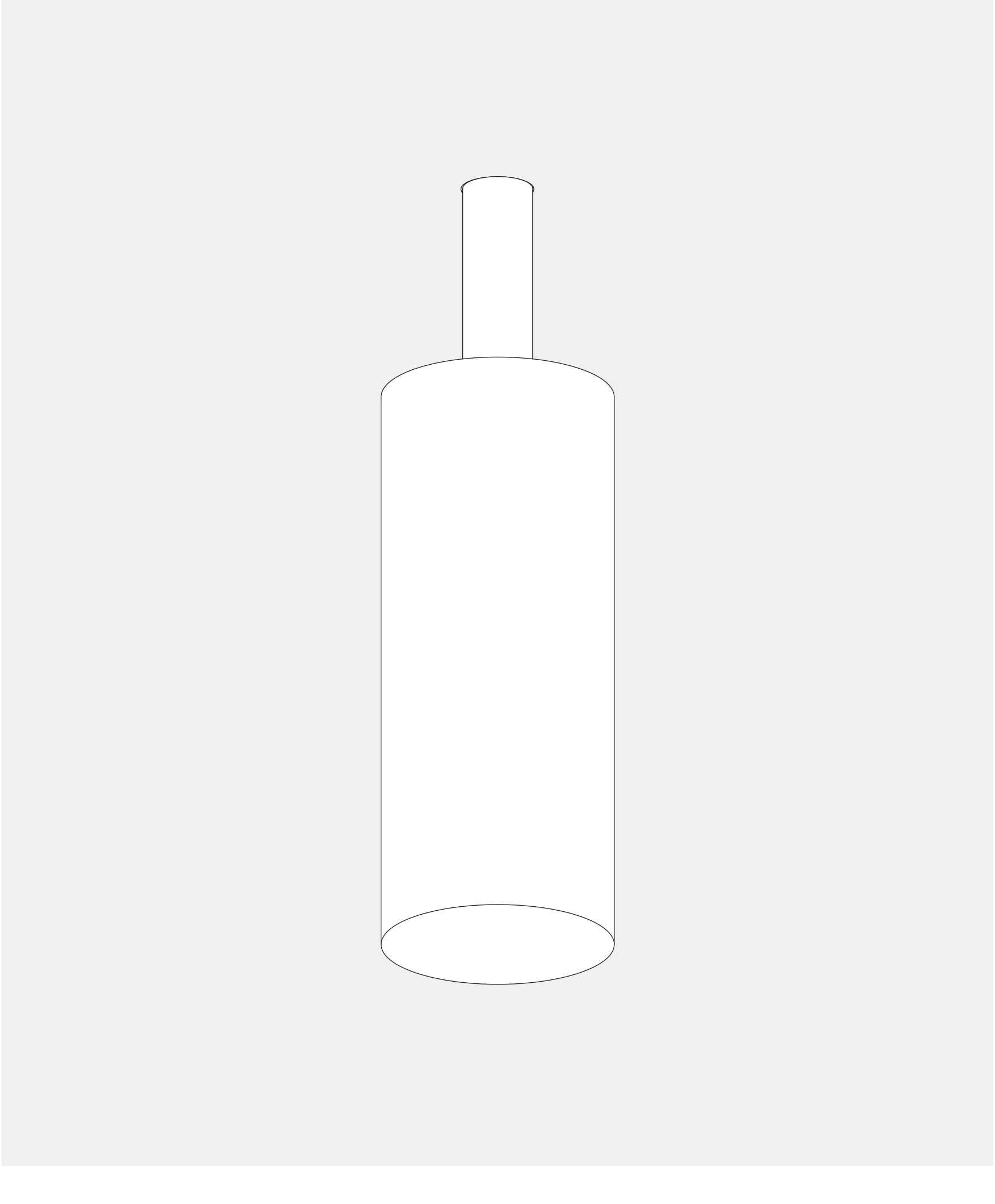

Thank you for choosing prado.