

back box cover plate

installation instruction

1

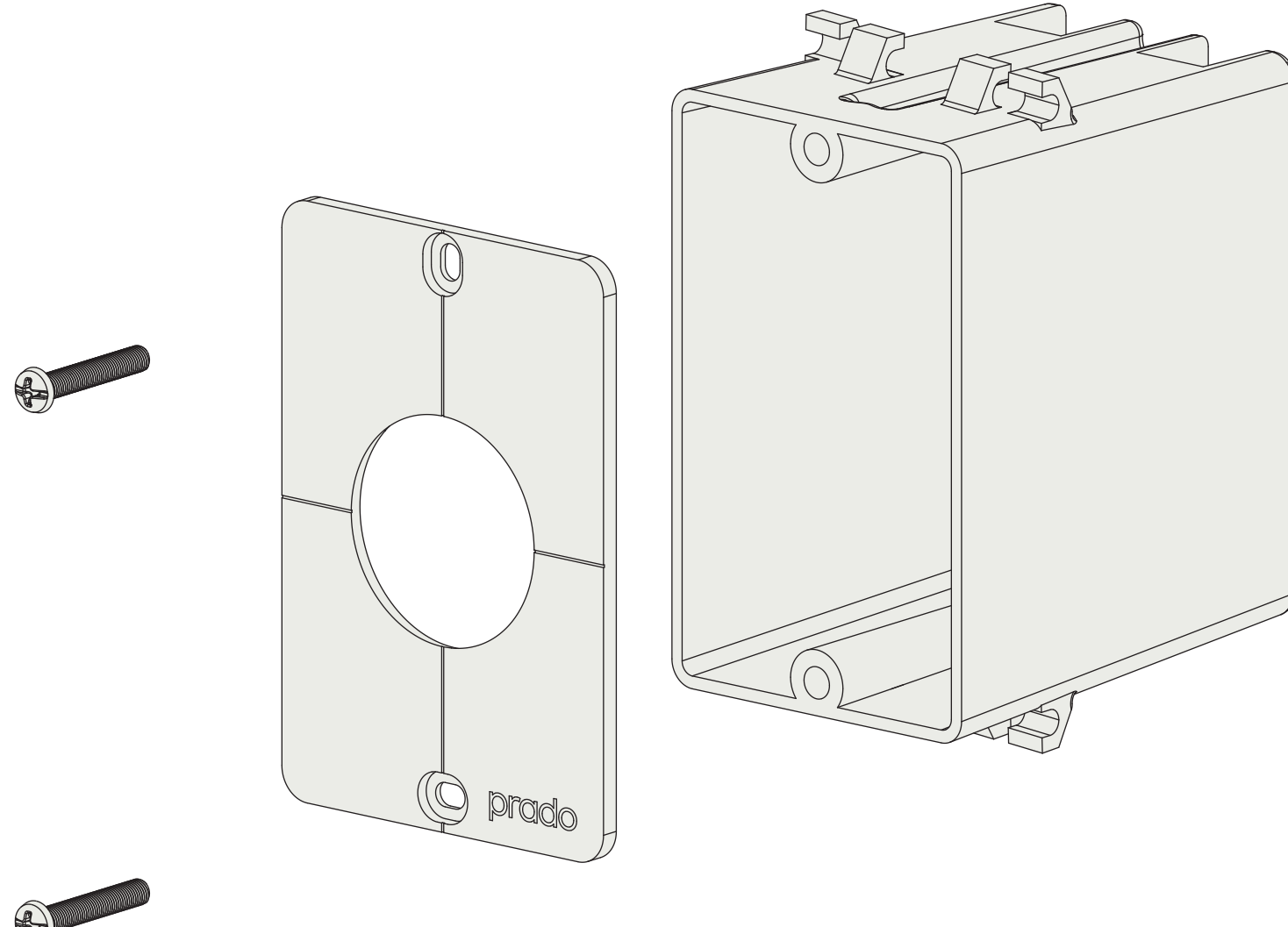

Install the cover plate onto the back box.

2

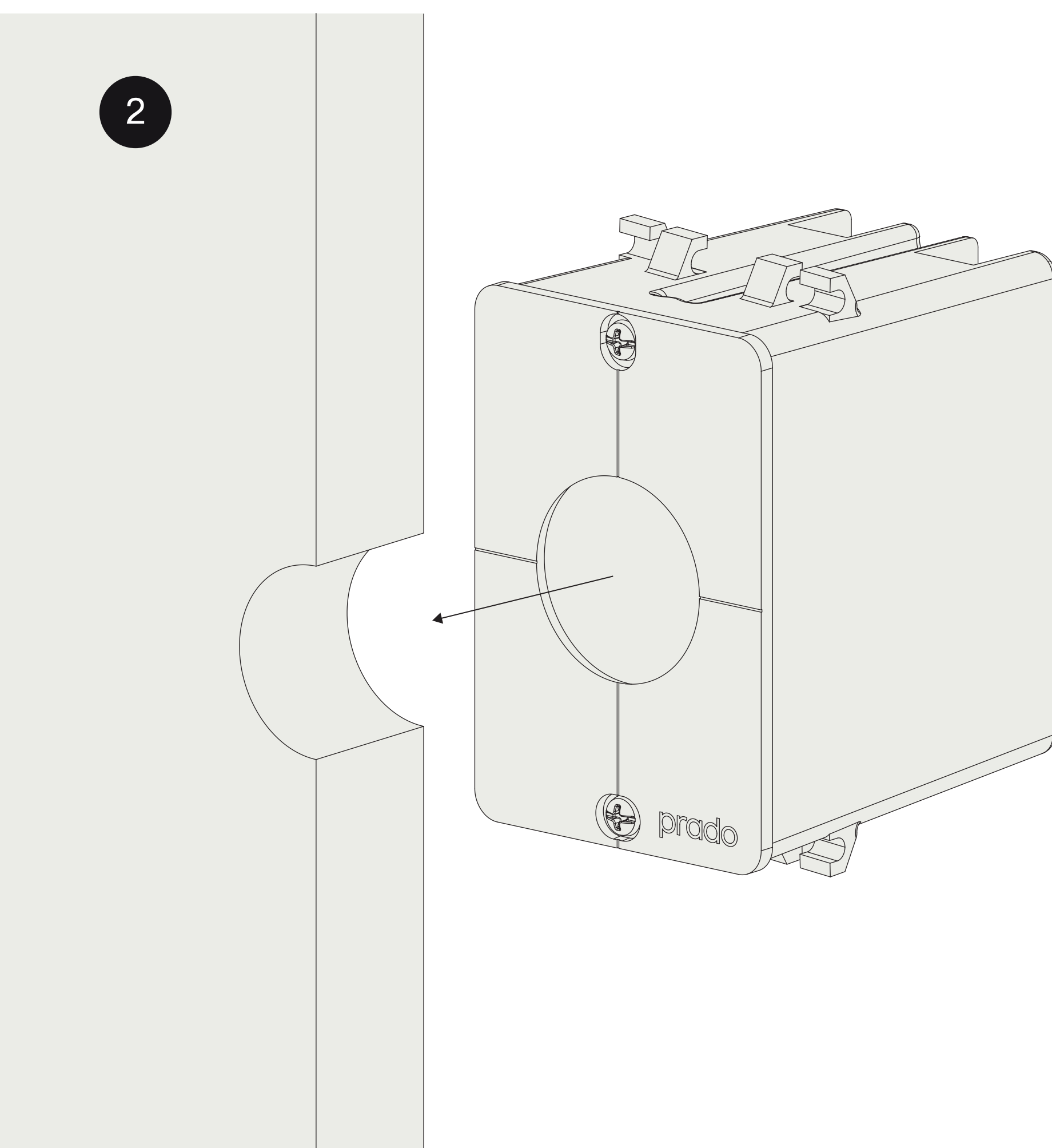

Install the cover plate and back box on the back of the desired wall surface.

3

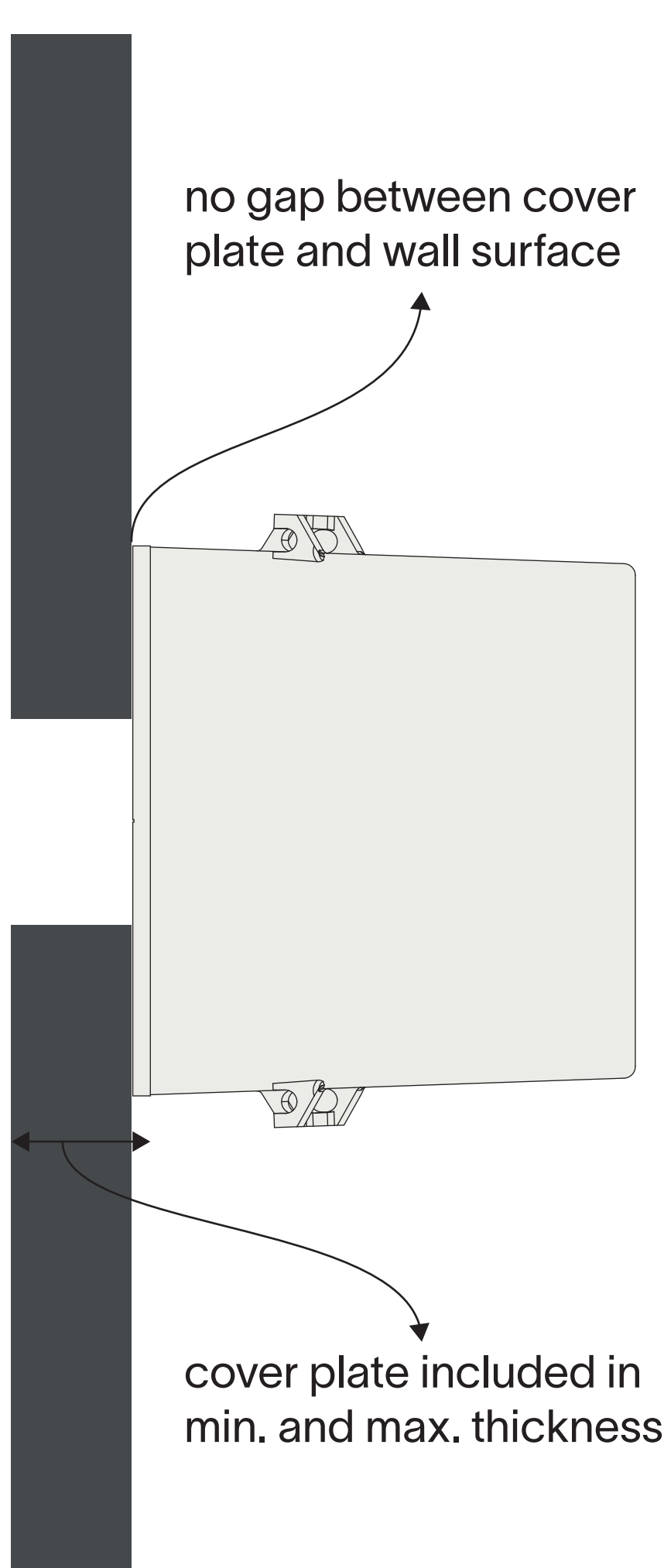

Make sure the cover plate and back box is installed directly onto the wall surface.
Check installation manual of the final product for the minimum and maximum thickness of the wall surface.
Make sure to include the back box cover plate into this thickness.
Thank you for choosing prado.
