

# pradovent mud ring Ø4-1/4"

## installation instruction

1

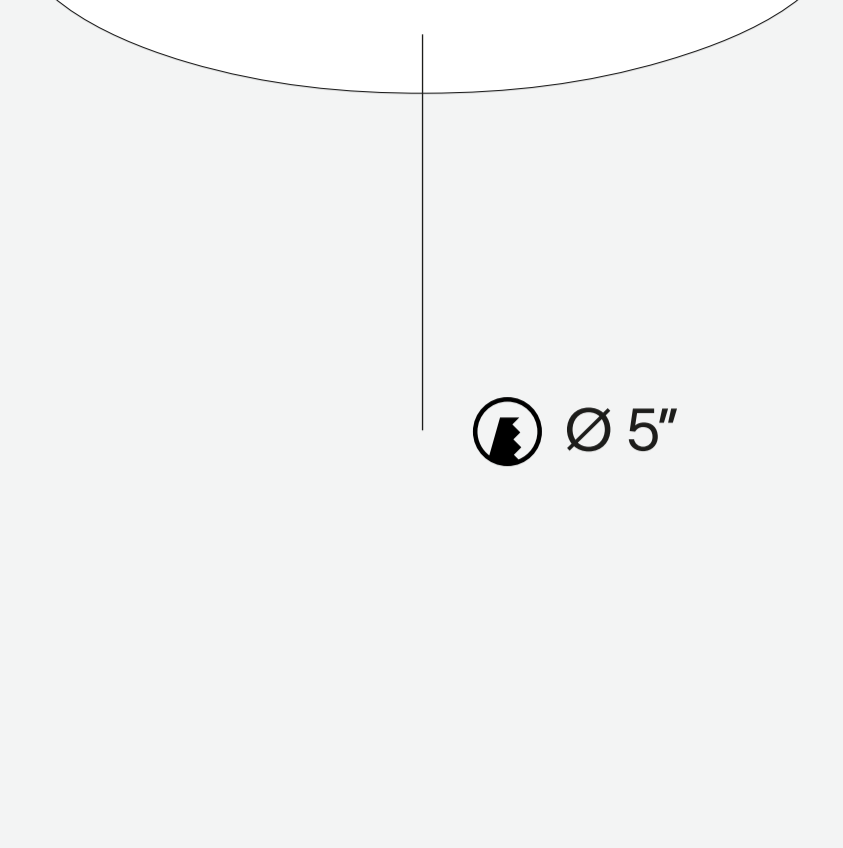

cut a round hole (Ø 5")

2

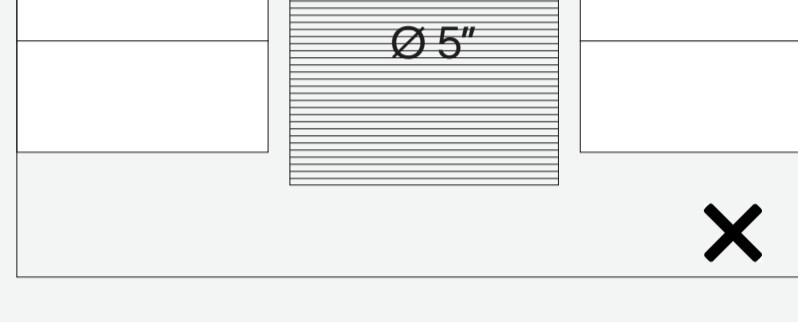
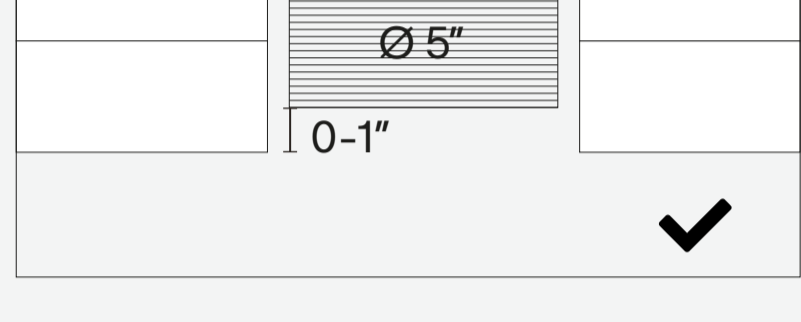
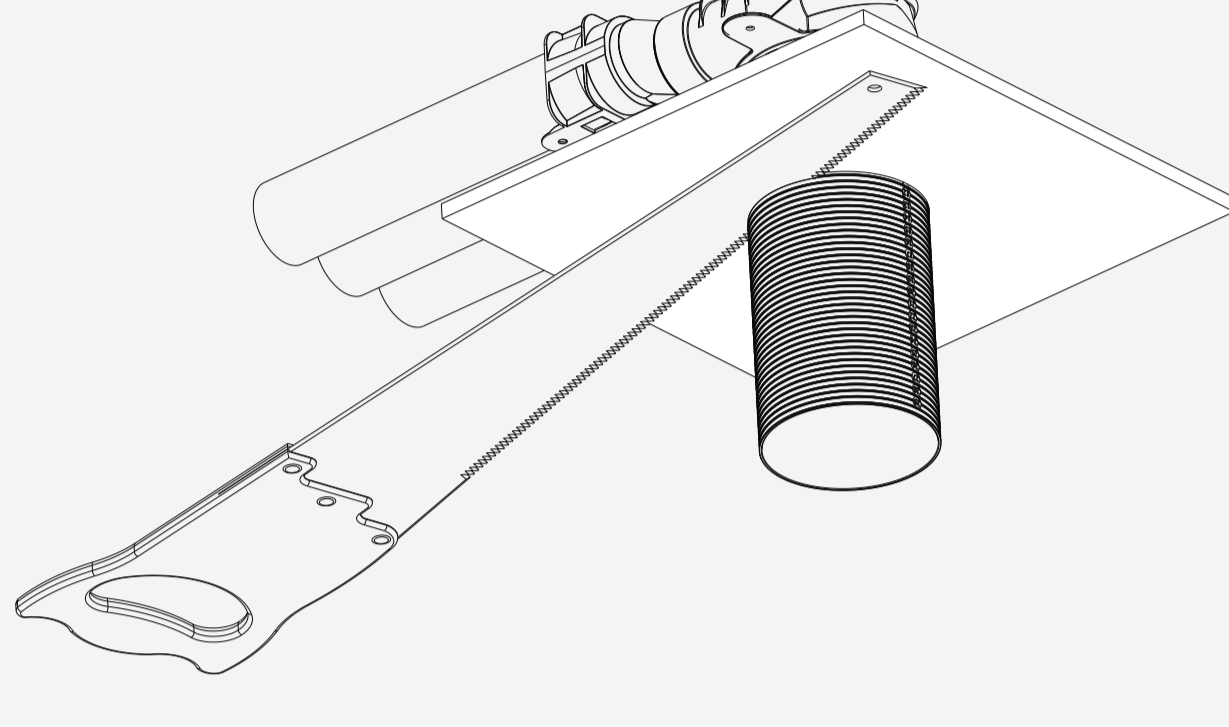
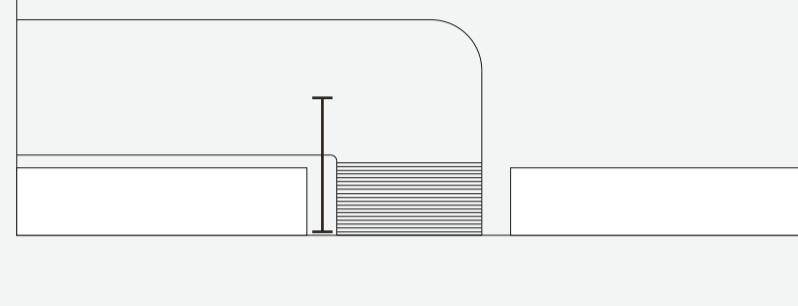
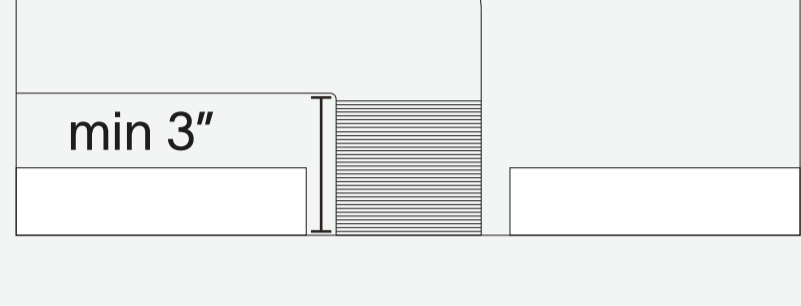

Cut off the excess length of the valve adapter.  
(between 0 and 1" above final ceiling level)  
The remaining vertical part of the adapter  
(before the start of the turn) must be at least  
3" high for the plaster ring.

3

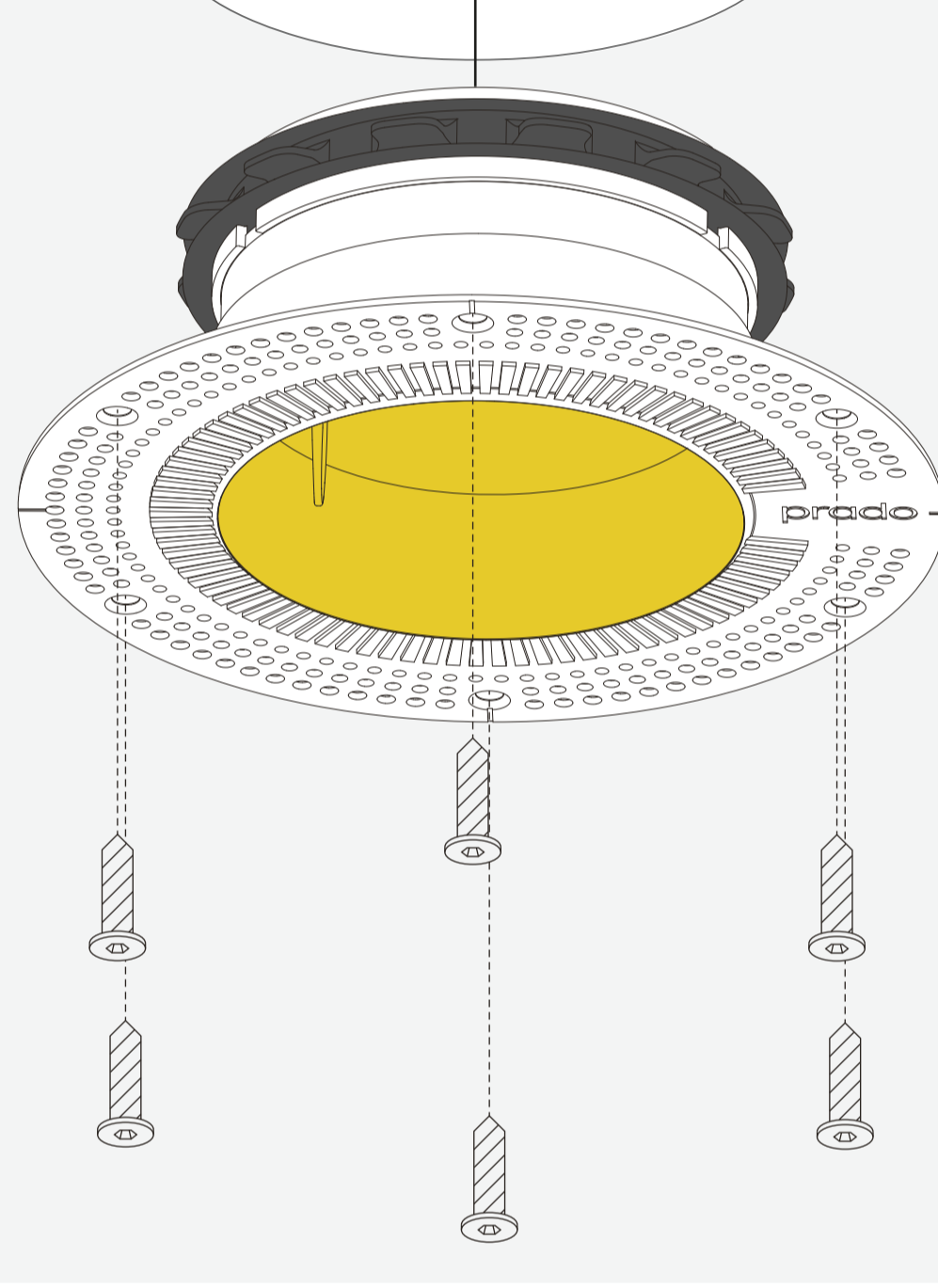

Insert the plaster ring and securely fasten it with glue  
or the appropriate screws on a screwfast surface.  
The attachment must be able to obtain a static load of  
11 lbs. It's the installers responsibility to ensure optimal  
attachment.

4

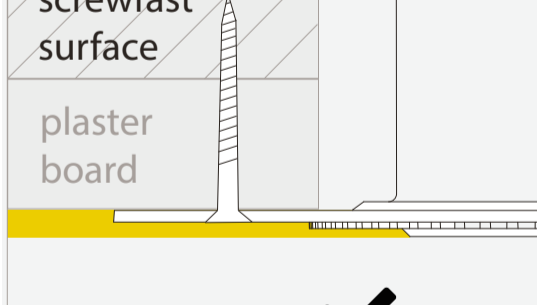
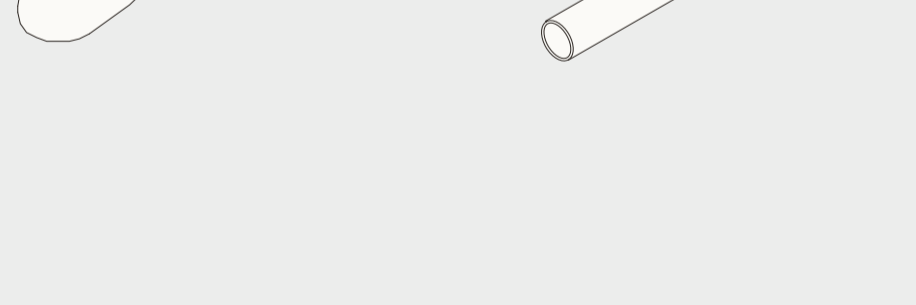

perfect amount of plaster

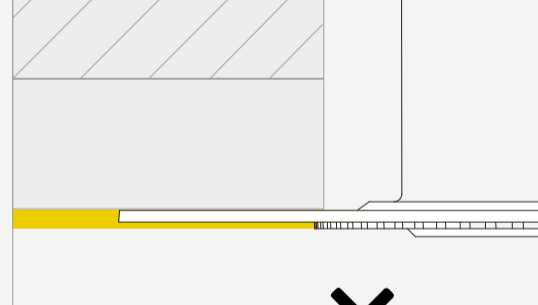

not enough plaster

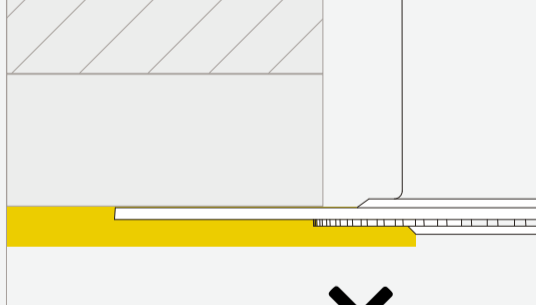

too much plaster

Exercise caution while plastering, do not damage the  
ring. Keep the plaster lid inside the plaster ring while  
plastering. Use a fiberglass mesh tape for optimal  
plaster adhesion. Make sure not to touch the edge  
of the ring when sanding.

5

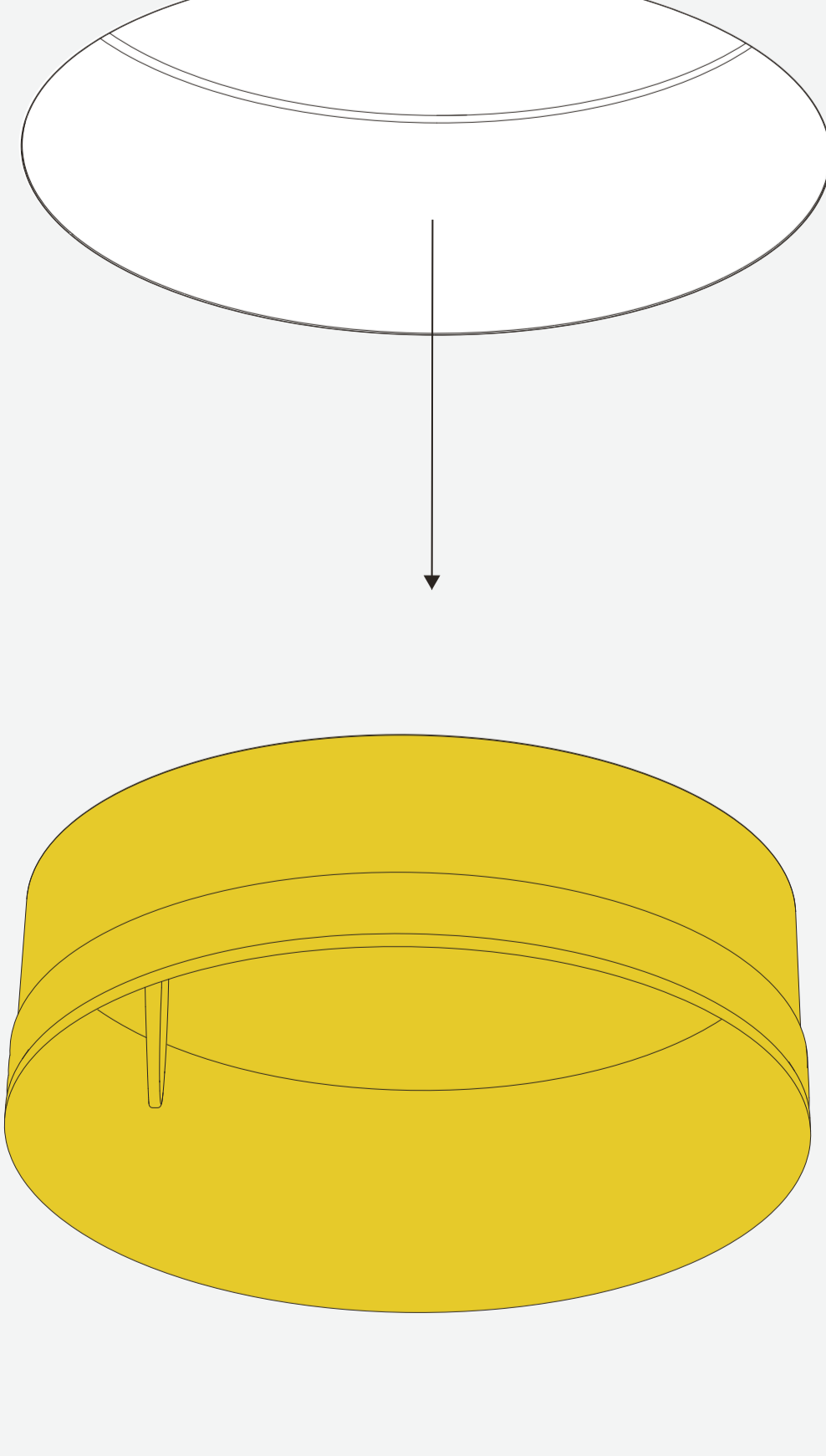

Remove the plaster lid just before installing the fixture.  
It helps to keep the inside of your plaster ring free of  
filler, paint and dust. Any residue needs to be removed  
without damaging the edges of the plaster ring.

thank you for choosing prado